

R9 Resting Station cum Information Kiosk

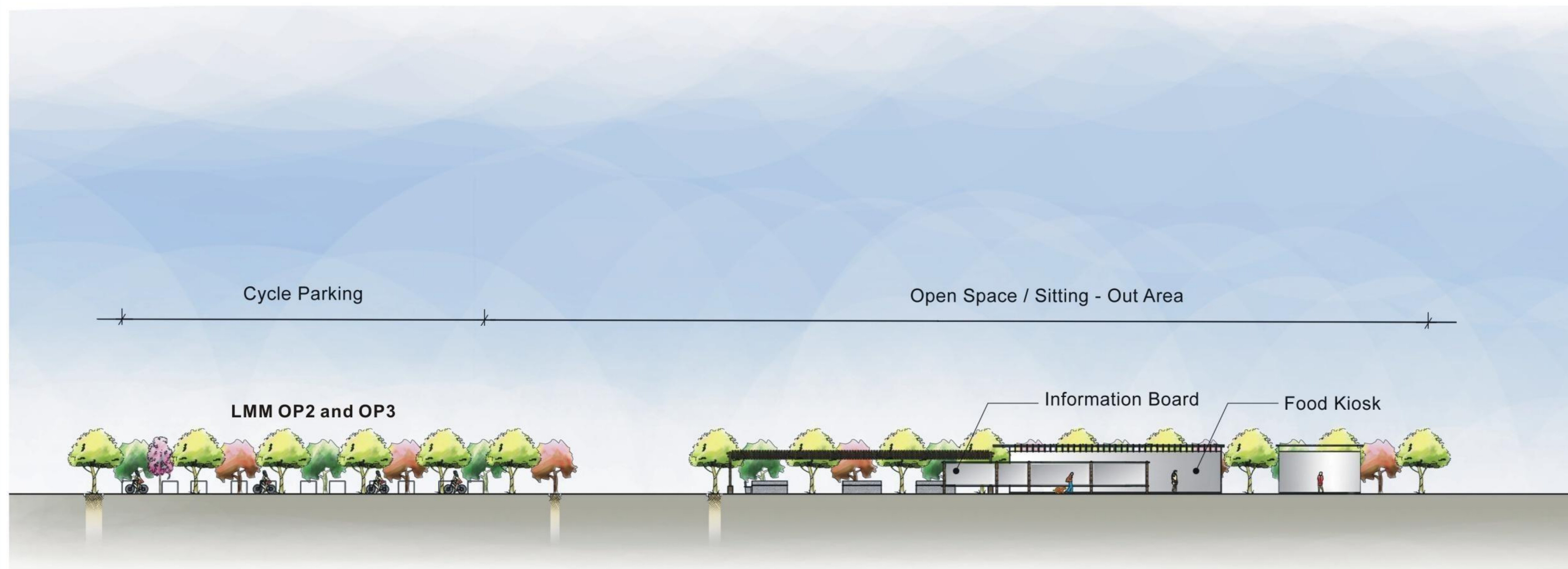
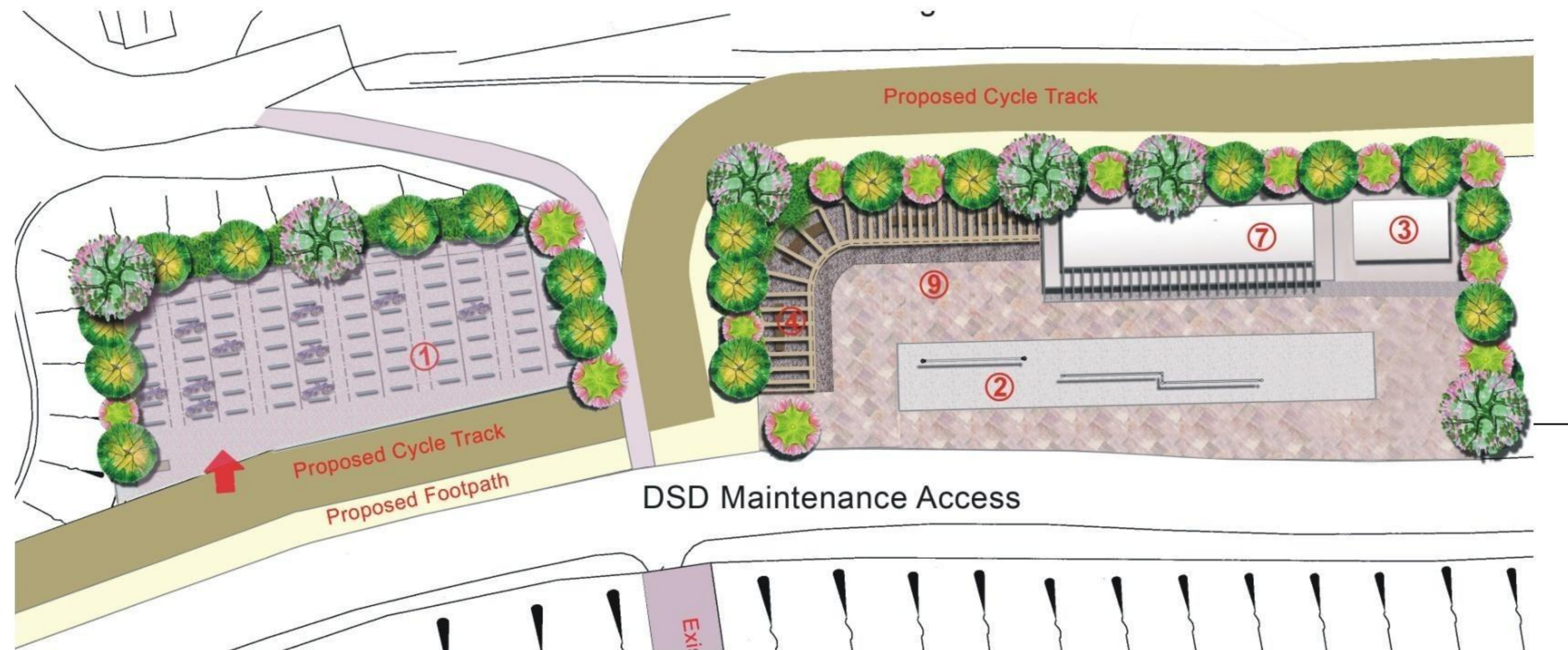

Information Kiosk & Resting Station (R9)		E
Zoning		E & R9
Facility No.	Facility Description	
1	Cycle Parking Spaces	380m <sup>2</sup> for 80 Parking Units
2	Information Board	100m <sup>2</sup>
3	Mobile First Aid Station	30m <sup>2</sup>
4	Shelter / Pavilion	130m <sup>2</sup>
5	Public Toilet	*
6	Cycle Rental / Return Kiosk	N/A
7	Food Kiosk	140m <sup>2</sup>
8	Practicing Area / Gathering Ground	N/A
9	Open Space / Sitting-out Area	360m <sup>2</sup>
Total Area		1140m <sup>2</sup>

Note: Landscape Design Concept provided by consultant of the NWNT cycle track design and construction study under Agreement No. CE22/2006, CEDD, 2007

R9 Elevation View

