

Figure 6.1a

Figure 6.1b

Figure 6.1c

0 200 400m

Rev.	Description of Revision	Date	Chk.

Client  
 **HIGHWAYS DEPARTMENT WORKS DIVISION**

Consultants  
**Mannings (Asia) Consultants Ltd**  
*In association with*  
**BMT Asia Pacific**

Project  
 Agreement No. WD 7/2007  
 Upgrading of Remaining Sections of Kam Tin Road & Lam Kam Road  
 Environmental Impact Assessment

Title  
 Locations of Potential Contamination Site Along Project Boundary (Index)

Drawing No.	Revision
Figure 6.1	1

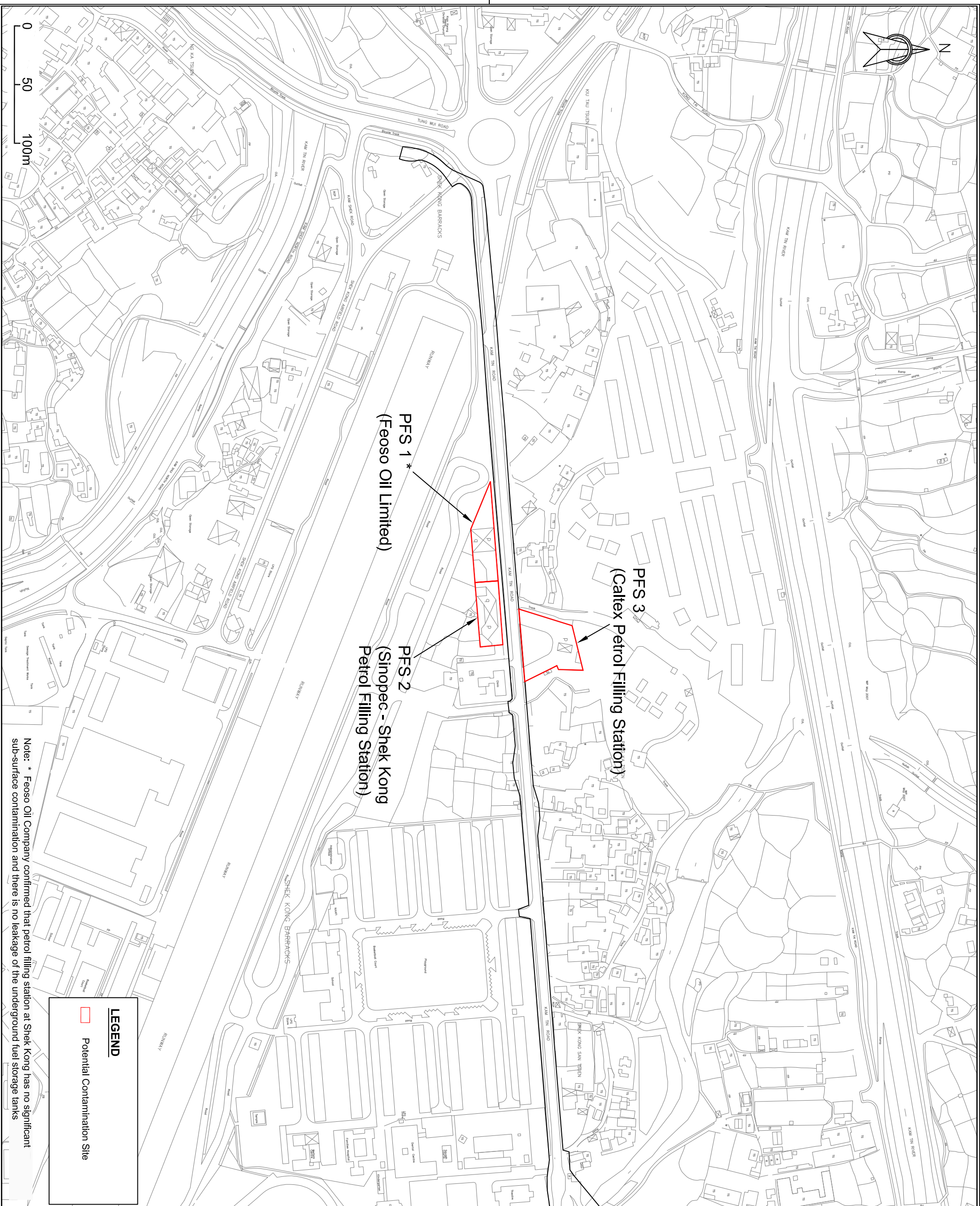

Note: \* Feoso Oil Company confirmed that petrol filling station at Shek Kong has no significant sub-surface contamination and there is no leakage of the underground fuel storage tanks

**LEGEND**

Potential Contamination Site

Rev.	Description of Revision	Date	Chk.

**Client**  
**HIGHWAYS DEPARTMENT WORKS DIVISION**

**Consultants**  
**Mannings (Asia) Consultants Ltd**  
*in association with*  
**BMT Asia Pacific**

**Project**  
 Agreement No. WD 7/2007  
 Upgrading of Remaining Sections of Kam Tin Road & Lam Kam Road Environmental Impact Assessment

**Title**  
 Locations of Potential Contamination Site Along Project Boundary (Sheet 1 of 3)

**Drawing No.**  
 Figure 6.1a

**Revision**  
 1

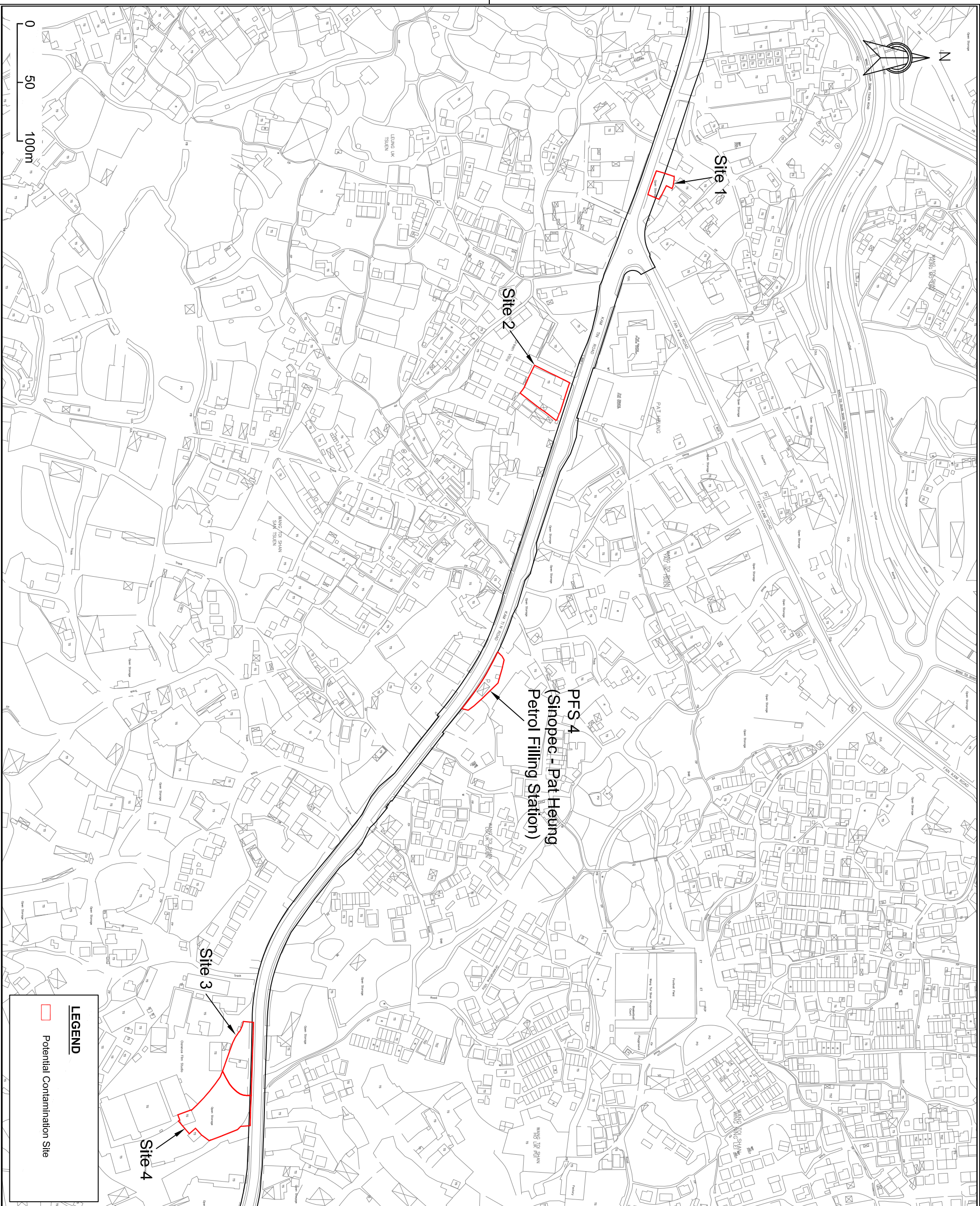

Rev.	Description of Revision	Date	Chk.

**Client**  
**HIGHWAYS DEPARTMENT WORKS DIVISION**

**Consultants**  
**Mannings (Asia) Consultants Ltd**  
*In association with*  
**BMT Asia Pacific**

**Project**  
 Agreement No. WD 7/2007  
 Upgrading of Remaining Sections of Kam Tin Road & Lam Kam Road Environmental Impact Assessment

**Title**  
 Locations of Potential Contamination Site Along Project Boundary (Sheet 2 of 3)

Drawing No. Figure 6.1b	Revision 1
----------------------------	---------------

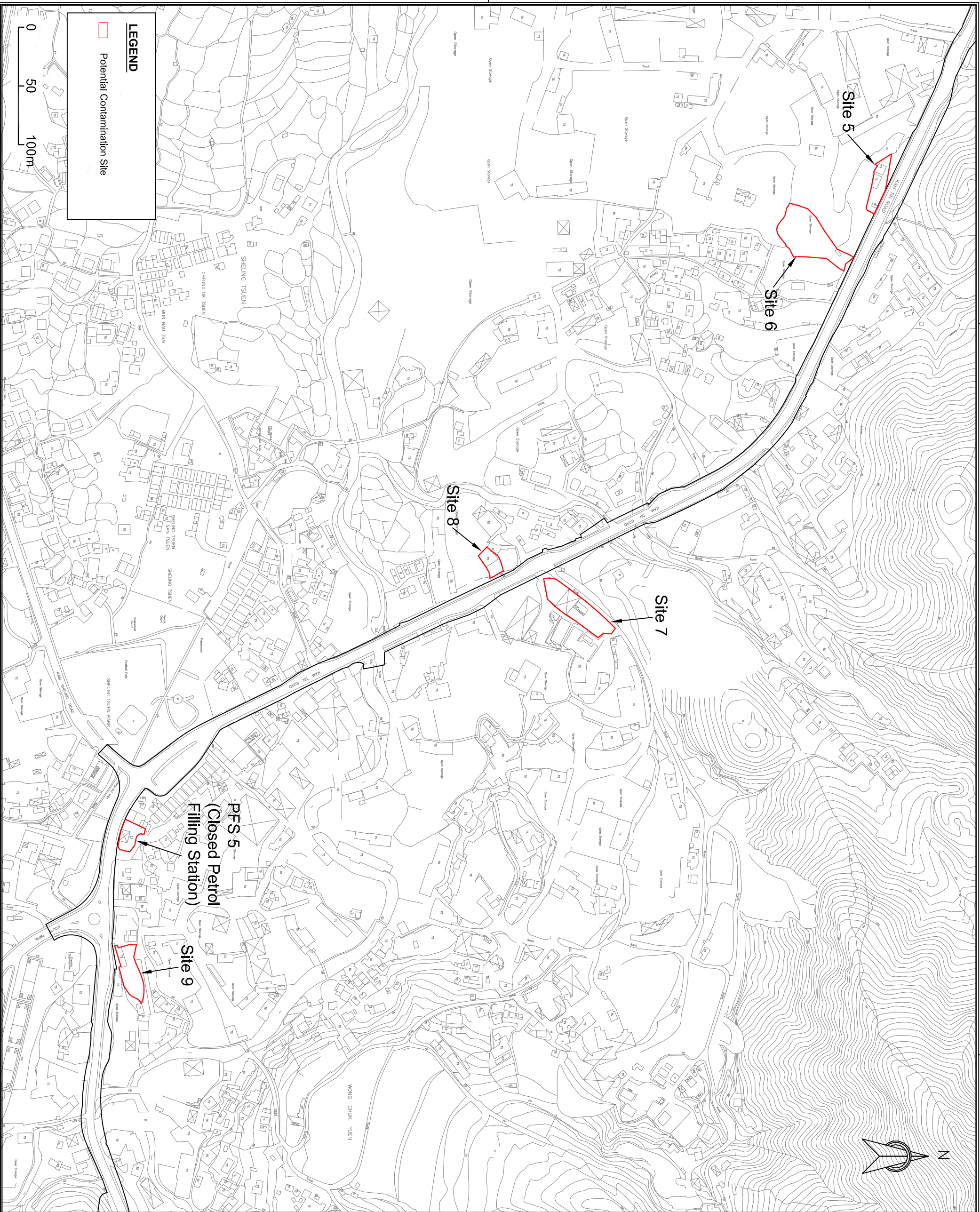

Rev.	Description of Revision	Date	Chk.

**Client**  
  
**HIGHWAYS DEPARTMENT WORKS DIVISION**

**Consultants**  
  
**Mannings (Asia) Consultants Ltd**  
*In association with*  
**BMT Asia Pacific**

**Project**  
 Agreement No. WD 7/2007  
 Upgrading of Remaining Sections of Kam Tin Road & Lam Kam Road Environmental Impact Assessment

**Title**  
 Locations of Potential Contamination Site Along Project Boundary (Sheet 3 of 3)

Drawing No. Figure 6.1c	Revision 1
----------------------------	---------------