

深圳市治理深圳河办公室

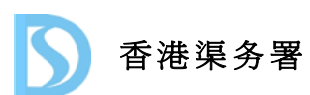

Figure 1.1

Location of Project Site

File: Final\0101759_
location of project site.mxd
Date: 04/05/2010



长江水资源保护科学研究所
CHANGJIANG WATER RESOURCES PROTECTION INSTITUTE



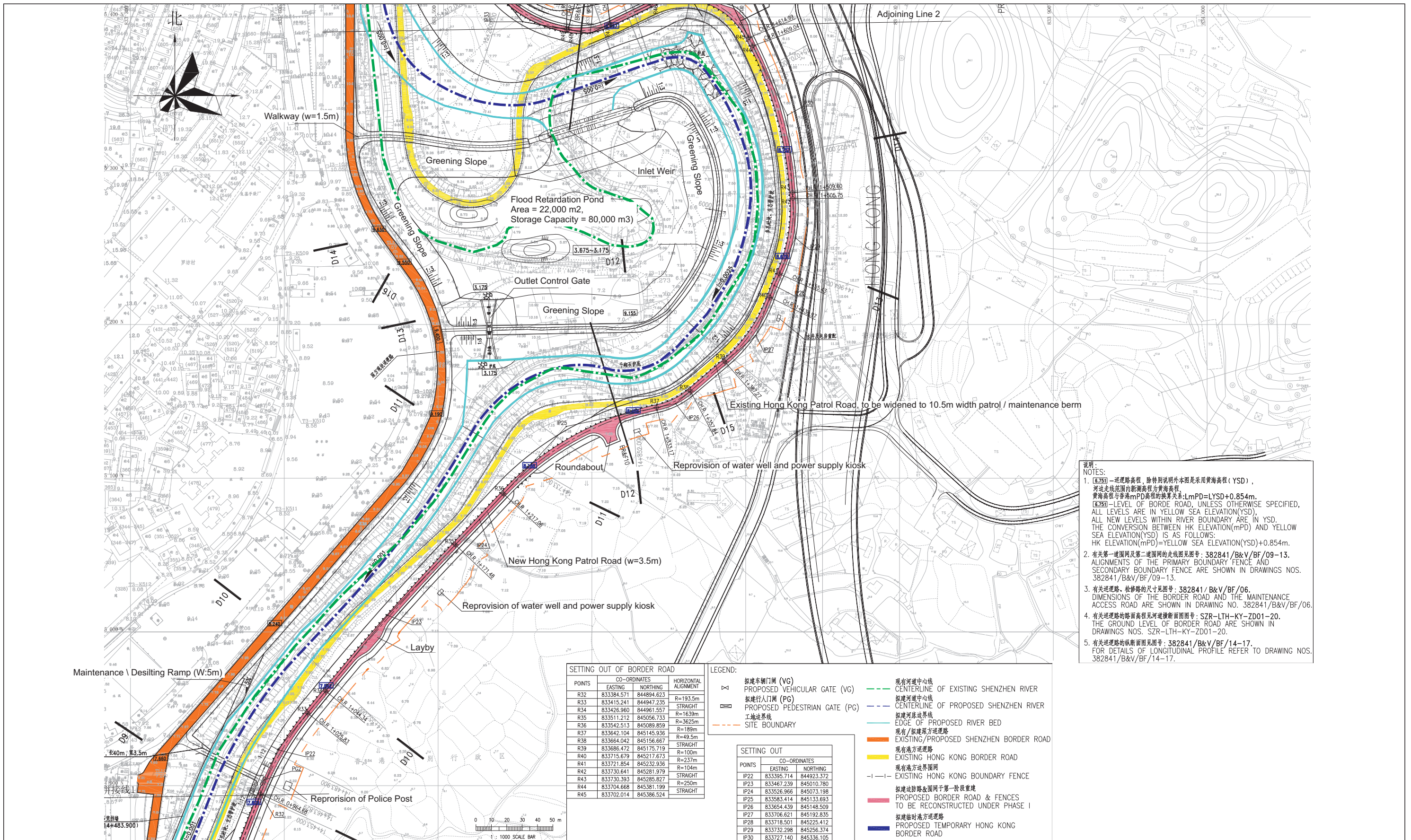

说明:
 NOTES:
 1. [6.75]—巡理路高程, 除特别说明外本图是采用黄海高程(YSD), 河道走线范围内新测高程为黄海高程. 黄海高程与香港mPD高程的换算关系: LmPD=LYSD+0.854m. [6.75]—LEVEL OF BORDE ROAD, UNLESS OTHERWISE SPECIFIED, ALL LEVELS ARE IN YELLOW SEA ELEVATION(YSD), ALL NEW LEVELS WITHIN RIVER BOUNDARY ARE IN YSD. THE CONVERSION BETWEEN HK ELEVATION(mPD) AND YELLOW SEA ELEVATION(YSD) IS AS FOLLOWS: HK ELEVATION(mPD)=YELLOW SEA ELEVATION(YSD)+0.854m.
 2. 有关第一道围网及第二道围网的走线围网图号: 382841/B&V/BF/09-13. ALIGNMENTS OF THE PRIMARY BOUNDARY FENCE AND SECONDARY BOUNDARY FENCE ARE SHOWN IN DRAWINGS NOS. 382841/B&V/BF/09-13.
 3. 有关巡理路、检修路的尺寸见围网图号: 382841/B&V/BF/06. DIMENSIONS OF THE BORDER ROAD AND THE MAINTENANCE ACCESS ROAD ARE SHOWN IN DRAWING NO. 382841/B&V/BF/06.
 4. 有关巡理路的路面高程见河建设断面图号: SZR-LTH-KY-ZD01-20. THE GROUND LEVEL OF BORDER ROAD ARE SHOWN IN DRAWINGS NOS. SZR-LTH-KY-ZD01-20.
 5. 有关巡理路的纵断面图号: 382841/B&V/BF/14-17. FOR DETAILS OF LONGITUDINAL PROFILE REFER TO DRAWING NOS. 382841/B&V/BF/14-17.

POINTS	CO-ORDINATES		HORIZONTAL ALIGNMENT
	EASTING	NORTHING	
R32	833384.571	844894.623	R=193.5m
R33	833415.241	844947.235	STRAIGHT
R34	833426.960	844961.597	R=1639m
R35	833511.212	845056.733	R=3625m
R36	833542.513	845089.859	R=189m
R37	833642.104	845145.936	R=49.5m
R38	833664.042	845156.667	STRAIGHT
R39	833686.472	845175.719	R=100m
R40	833715.679	845217.673	R=237m
R41	833721.854	845232.936	R=104m
R42	833730.641	845281.979	STRAIGHT
R43	833730.393	845285.827	R=250m
R44	833704.668	845381.199	STRAIGHT
R45	833702.014	845386.524	STRAIGHT

POINTS	CO-ORDINATES		HORIZONTAL ALIGNMENT
	EASTING	NORTHING	
IP22	833395.714	844923.372	STRAIGHT
IP23	833467.239	845010.780	STRAIGHT
IP24	833526.966	845073.198	STRAIGHT
IP25	833583.414	845133.693	STRAIGHT
IP26	833654.439	845148.509	STRAIGHT
IP27	833706.621	845192.835	STRAIGHT
IP28	833718.501	845225.412	STRAIGHT
IP29	833732.298	845256.374	STRAIGHT
IP30	833727.140	845336.105	STRAIGHT

Figure 1.3 River Modification and Reprovision of Boundary Patrol Road & Boundary Fence (2/5)

FILE: 0101759u2a
 DATE: 30/07/2010



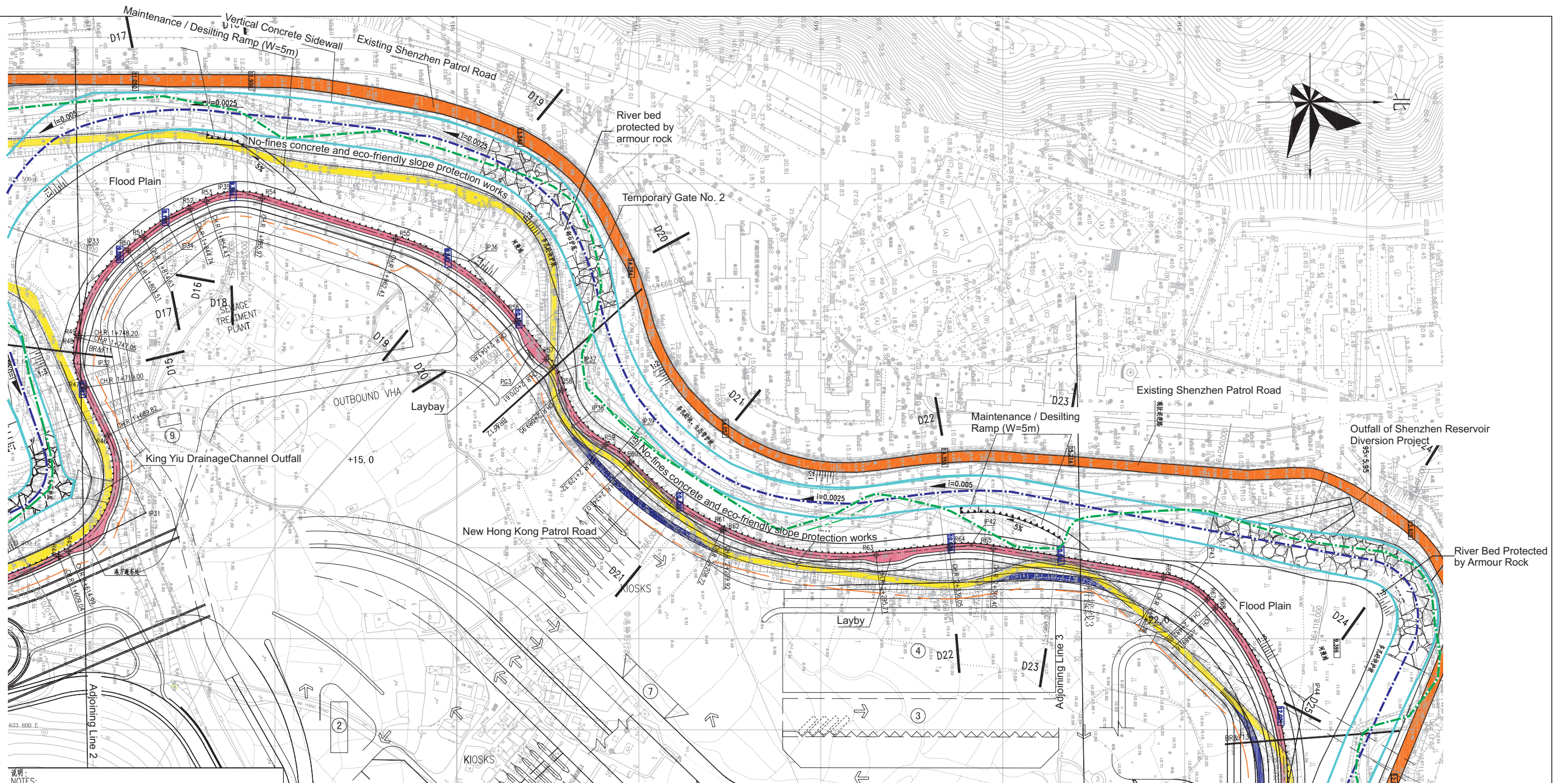

说明:
NOTES:

- [6.75]—巡理路高程, 除特别说明外本图是采用黄海高程(YSD), 河道沿线范围内新测高程为黄海高程。
黄海高程与香港mPD高程的换算关系: $LmPD = LYSD + 0.854m$ 。
[6.75]—LEVEL OF BORDE ROAD, UNLESS OTHERWISE SPECIFIED, ALL LEVELS ARE IN YELLOW SEA ELEVATION(YSD). ALL NEW LEVELS WITHIN RIVER BOUNDARY ARE IN YSD. THE CONVERSION BETWEEN HK ELEVATION(mPD) AND YELLOW SEA ELEVATION(YSD) IS AS FOLLOWS:
 $HK ELEVATION(mPD) = YELLOW SEA ELEVATION(YSD) + 0.854m$.
- 有关第一道围网及第二道围网的走线图见图号: 382841/B&V/BF/09-13. ALIGNMENTS OF THE PRIMARY BOUNDARY FENCE AND SECONDARY BOUNDARY FENCE ARE SHOWN IN DRAWINGS NOS. 382841/B&V/BF/09-13.
- 有关巡理路、检修路的尺寸见图号: 382841/B&V/BF/06. DIMENSIONS OF THE BORDER ROAD AND THE MAINTENANCE ACCESS ROAD ARE SHOWN IN DRAWING NO. 382841/B&V/BF/06.
- 有关巡理路的路面高程见河道横断面图号: SZR-LTH-KY-ZD01-20. THE GROUND LEVEL OF BORDER ROAD ARE SHOWN IN DRAWINGS NOS. SZR-LTH-KY-ZD01-20.
- 有关巡理路的纵断面图号: 382841/B&V/BF/14-17. FOR DETAILS OF LONGITUDINAL PROFILE REFER TO DRAWING NOS. 382841/B&V/BF/14-17.

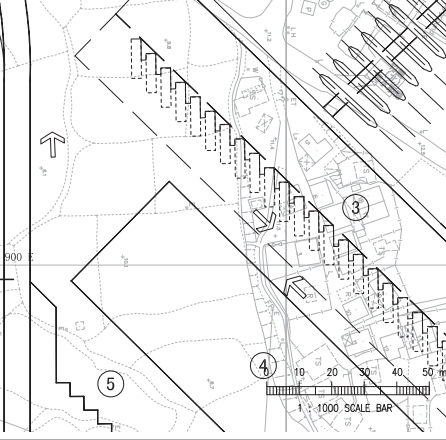

SETTING OUT OF BORDER ROAD			
POINTS	CO-ORDINATES		HORIZONTAL ALIGNMENT
	EASTING	NORTHING	
R45	833702.014	845386.524	R=48m
R46	833638.147	845408.322	STRAIGHT
R47	833611.879	845395.613	R=45m
R48	833584.550	845391.789	STRAIGHT
R49	833583.421	845391.986	R=77.5m
R50	833536.691	845419.332	STRAIGHT
R51	833529.657	845427.950	R=120m
R52	833513.732	845453.404	STRAIGHT
R53	833509.658	845462.203	R=45m
R54	833507.991	845493.052	STRAIGHT
R55	833530.323	845566.179	R=135m
R56	833575.464	845632.454	STRAIGHT
R57	833596.418	845649.100	R=48m
R58	833613.548	845657.798	R=48m
R59	833643.347	845681.818	R=50m
R60	833653.434	845695.092	R=162m
R61	833699.811	845745.627	STRAIGHT
R62	833690.311	845745.716	R=160m
R63	833704.019	845830.368	STRAIGHT
R64	833699.764	845870.480	R=90m
R65	833700.483	845894.748	

LEGEND:

- ▭ 拟建车辆门 (VG) PROPOSED VEHICULAR GATE (VG)
- ▭ 拟建行人门 (PG) PROPOSED PEDESTRIAN GATE (PG)
- 工地边界线 SITE BOUNDARY
- 现有河道中心线 CENTERLINE OF EXISTING SHENZHEN RIVER
- 拟建河道中心线 CENTERLINE OF PROPOSED SHENZHEN RIVER
- 拟建河床边界线 EDGE OF PROPOSED RIVER BED
- 现有/拟建疏浚道路 EXISTING/PROPOSED SHENZHEN BORDER ROAD
- 现有港方巡理路 EXISTING HONG KONG BORDER ROAD
- 现有港方边界围网 EXISTING HONG KONG BOUNDARY FENCE
- 拟建边防路及围网于第一阶段重建 PROPOSED BORDER ROAD & FENCES TO BE RECONSTRUCTED UNDER PHASE I
- 拟建临时港方巡理路 PROPOSED TEMPORARY HONG KONG BORDER ROAD

SETTING OUT			
POINTS	CO-ORDINATES		
	EASTING	NORTHING	
IP31	833680.853	845428.985	
IP32	833598.831	845389.299	
IP33	833554.959	845396.949	
IP34	833520.090	845439.673	
IP35	833502.977	845476.633	
IP36	833542.587	845606.337	
IP37	833604.095	845655.199	
IP38	833633.669	845663.331	
IP39	833647.268	845689.308	
IP40	833676.570	845716.798	
IP41	833708.655	845786.659	
IP42	833698.472	845827.663	

