

Figure 2.12

Proposed Master Layout  
Level 31.6 to 41.6

FILE: 0095646w2  
DATE: 29/12/2010

Environmental  
Resources  
Management



賽馬會文物保育有限公司  
The Jockey Club CPS Limited

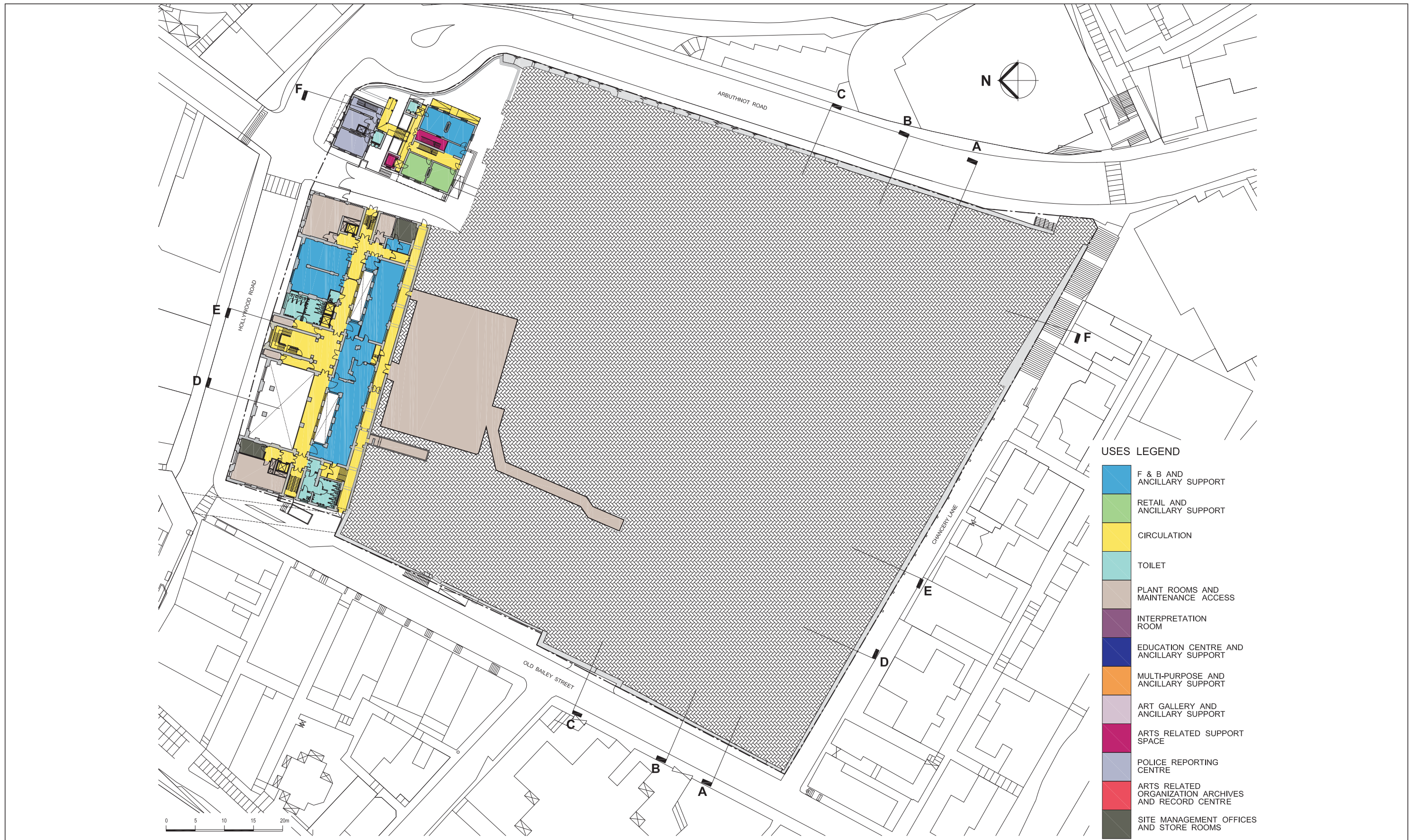

Figure 2.13

Proposed Master Layout  
Level 41.6 to 45.3

FILE: 0095646w3  
DATE: 29/12/2010

Environmental  
Resources  
Management



賽馬會文物保育有限公司  
The Jockey Club CPS Limited



Figure 2.14

Proposed Master Layout  
Level 45.3 to 48.6

FILE: 0095646w4  
DATE: 29/12/2010

Environmental  
Resources  
Management



賽馬會文物保育有限公司  
The Jockey Club CPS Limited



**USES LEGEND**

[Blue]	F & B AND ANCILLARY SUPPORT
[Green]	RETAIL AND ANCILLARY SUPPORT
[Yellow]	CIRCULATION
[Light Blue]	TOILET
[Brown]	PLANT ROOMS AND MAINTENANCE ACCESS
[Purple]	INTERPRETATION ROOM
[Dark Blue]	EDUCATION CENTRE AND ANCILLARY SUPPORT
[Orange]	MULTI-PURPOSE AND ANCILLARY SUPPORT
[Light Purple]	ART GALLERY AND ANCILLARY SUPPORT
[Pink]	ARTS RELATED SUPPORT SPACE
[Grey]	POLICE REPORTING CENTRE
[Red]	ARTS RELATED ORGANIZATION ARCHIVES AND RECORD CENTRE
[Dark Grey]	SITE MANAGEMENT OFFICES AND STORE ROOMS

Figure 2.15

Proposed Master Layout  
Level 48.6 to 52.4

FILE: 0095646w5  
DATE: 29/12/2010

Environmental  
Resources  
Management



賽馬會文物保育有限公司  
The Jockey Club CPS Limited



Figure 2.16

Proposed Master Layout  
Level 52.4 to 57.1

FILE: 0095646w6  
DATE: 10/01/2011

Environmental  
Resources  
Management



賽馬會文物保育有限公司  
The Jockey Club CPS Limited

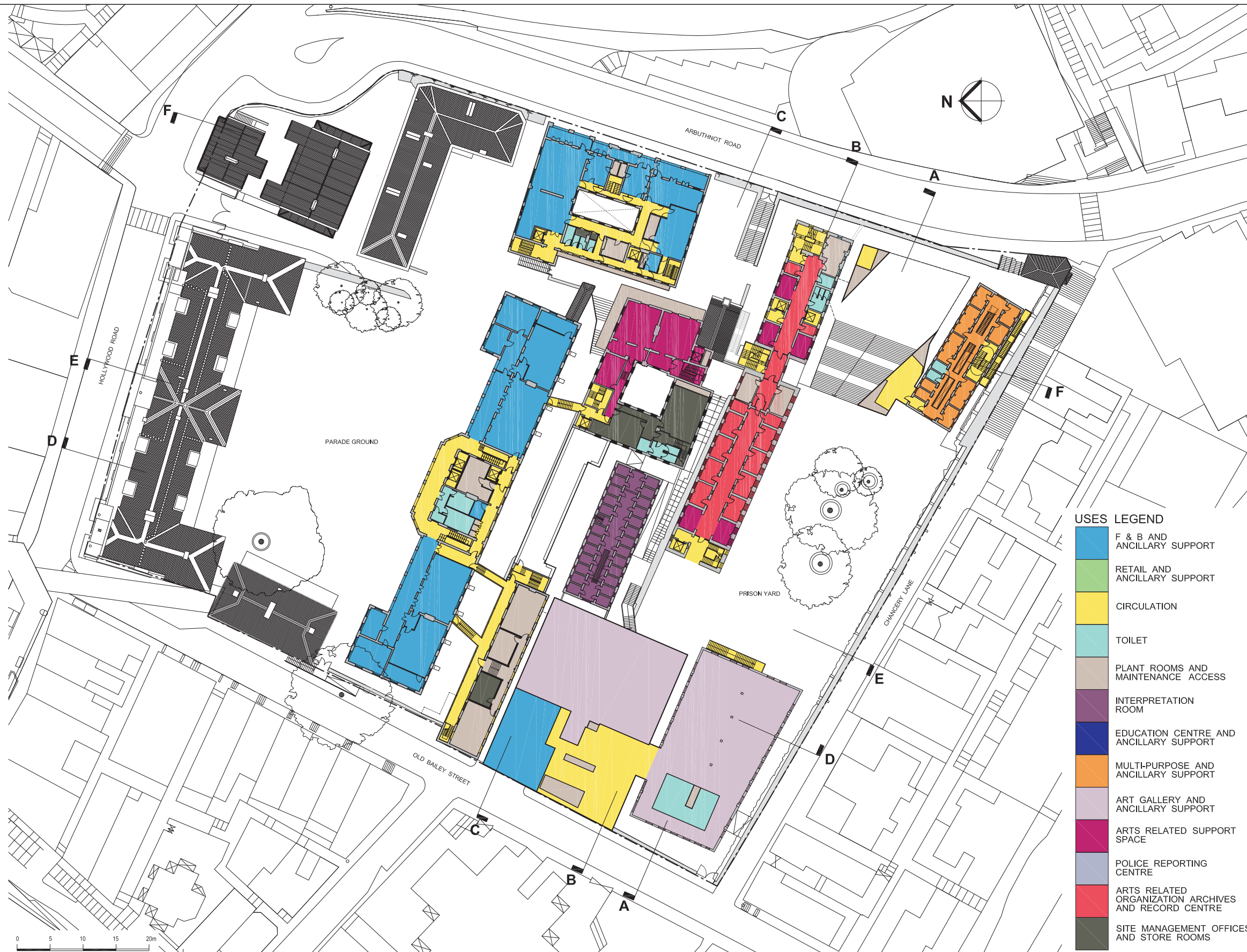
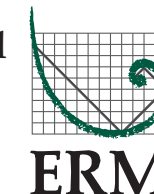

Figure 2.17

Proposed Master Layout  
Level 57.1 to 61.3

FILE: 0095646w7  
DATE: 29/12/2010

Environmental  
Resources  
Management



賽馬會文物保育有限公司  
The Jockey Club CPS Limited

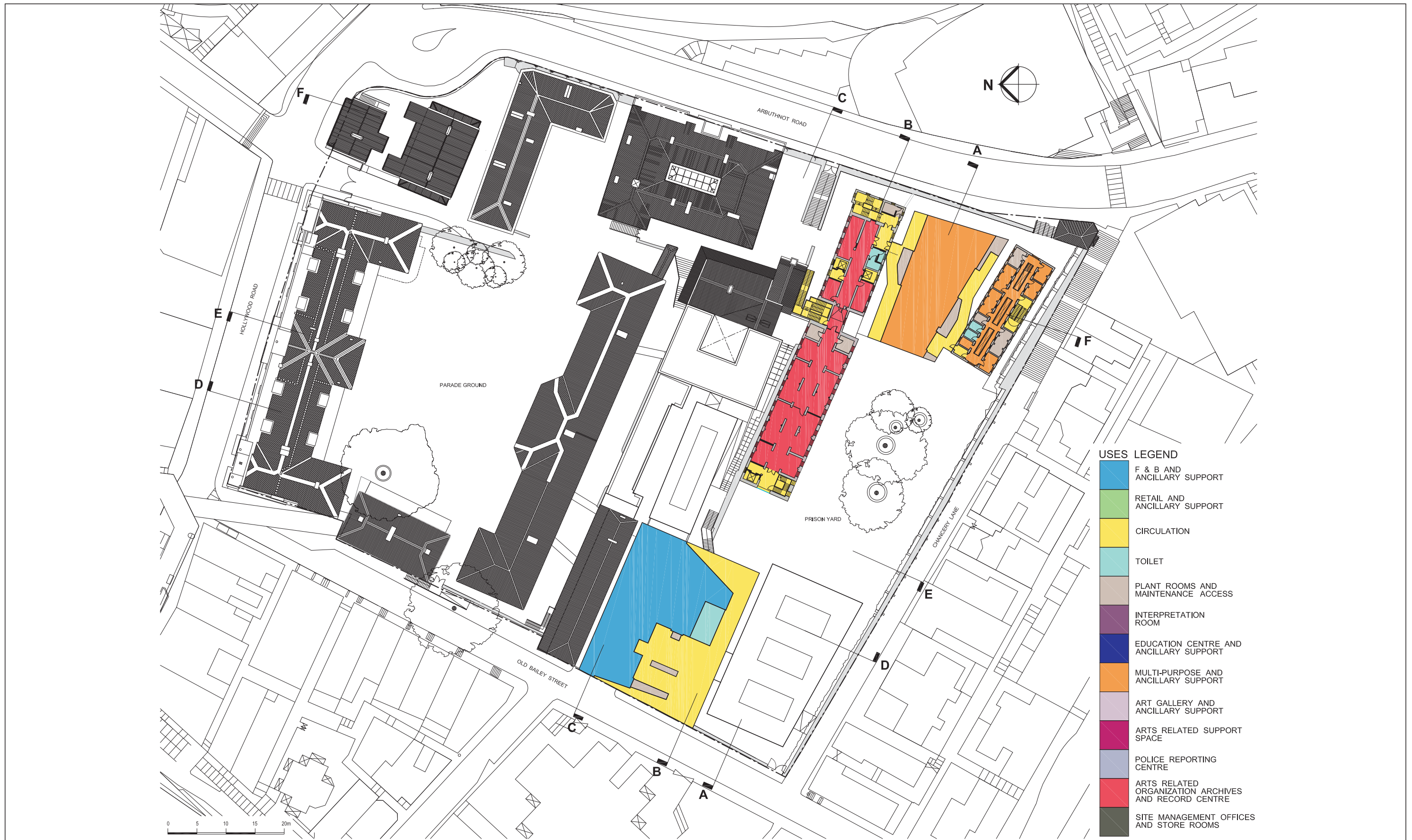

Figure 2.18

Proposed Master Layout  
Level 61.3 to 68.0

FILE: 0095646w8  
DATE: 29/12/2010

Environmental  
Resources  
Management



賽馬會文物保育有限公司  
The Jockey Club CPS Limited



Figure 2.19

Proposed Master Layout  
Level 69.335

FILE: 0095646w9  
DATE: 29/12/2010

Environmental  
Resources  
Management



賽馬會文物保育有限公司  
The Jockey Club CPS Limited



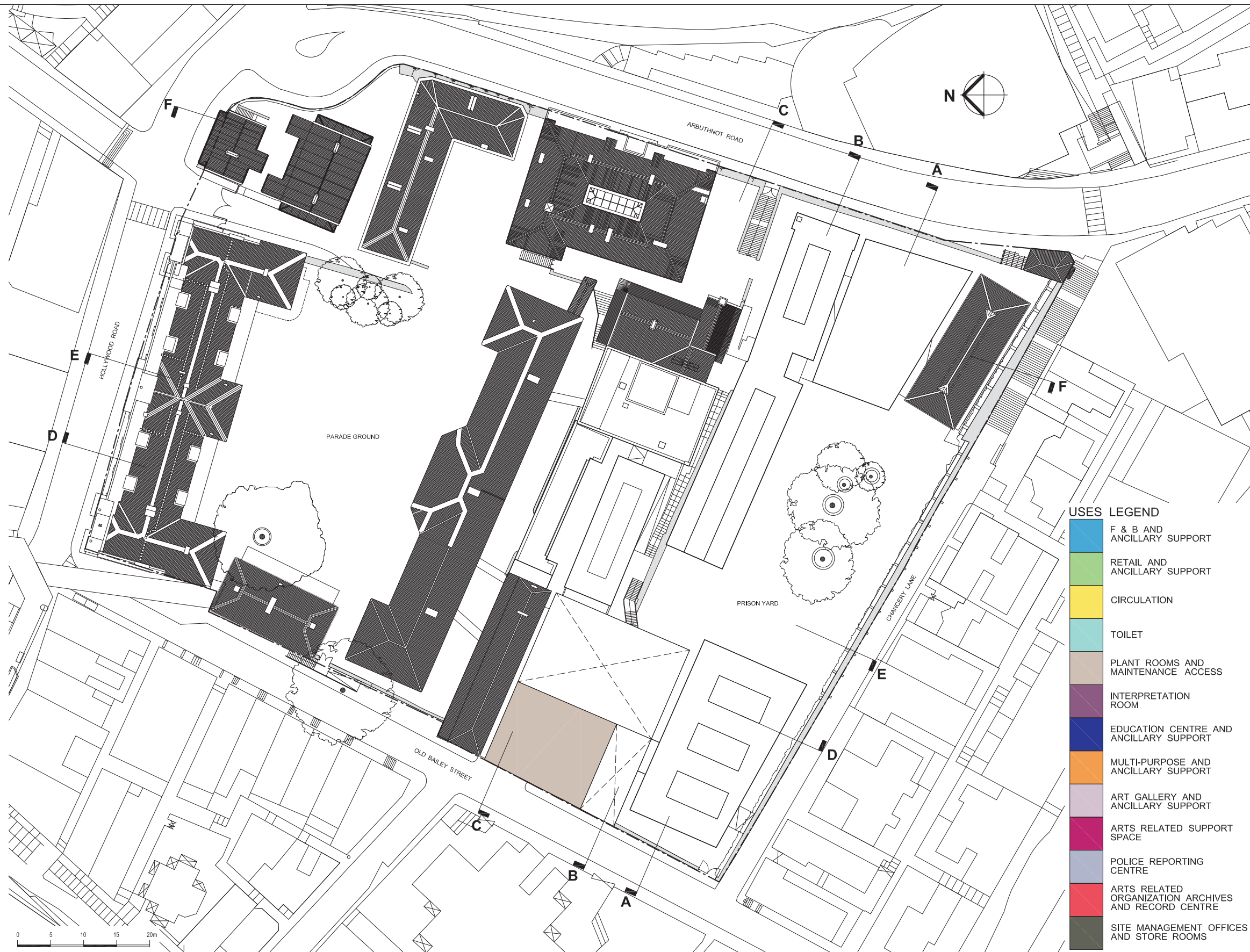
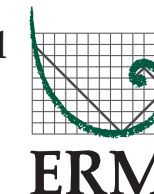

Figure 2.20

Proposed Master Layout  
Level 73.165

FILE: 0095646w10  
DATE: 29/12/2010

Environmental  
Resources  
Management



賽馬會文物保育有限公司  
The Jockey Club CPS Limited

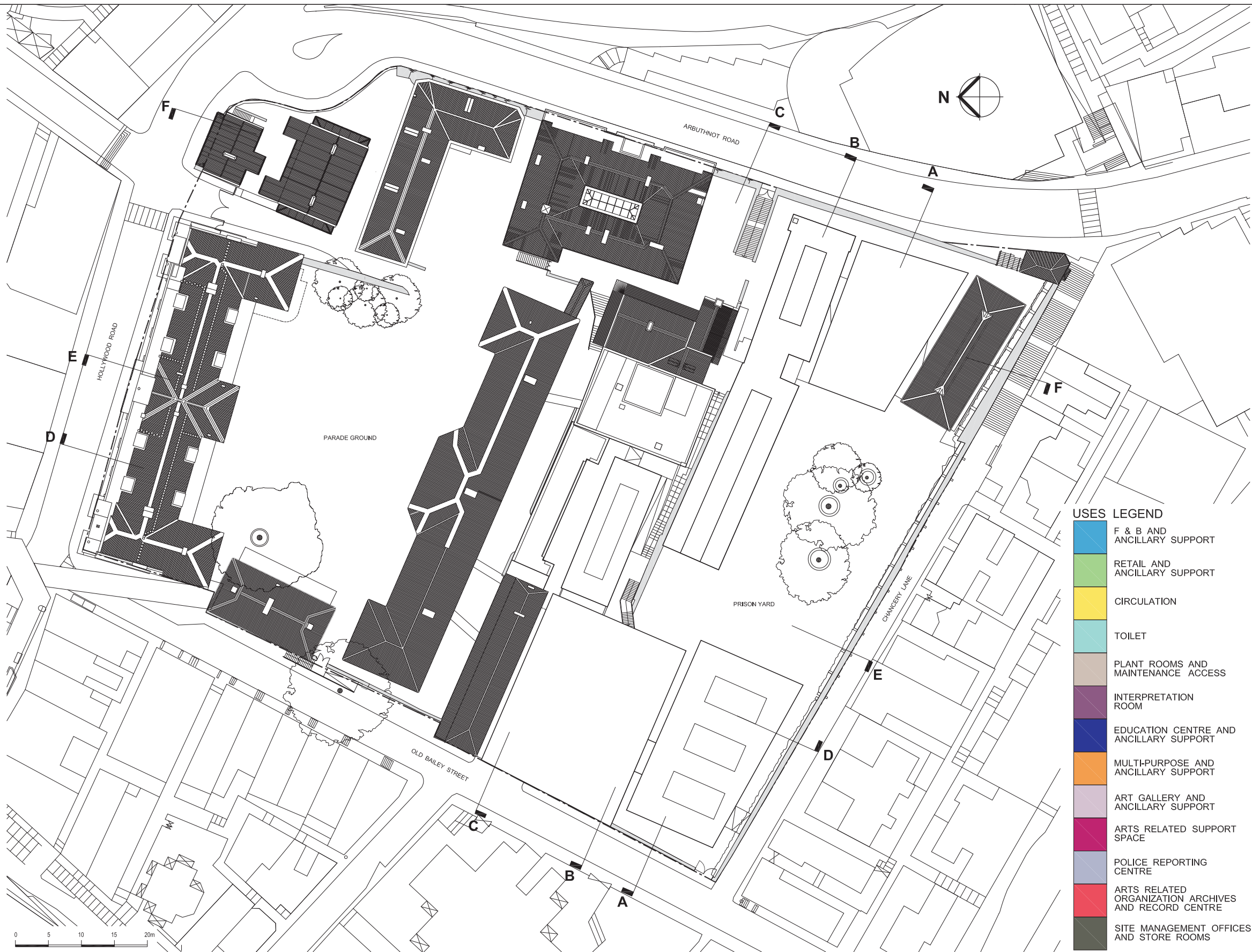

**USES LEGEND**

[Blue swatch]	F & B AND ANCILLARY SUPPORT
[Green swatch]	RETAIL AND ANCILLARY SUPPORT
[Yellow swatch]	CIRCULATION
[Light blue swatch]	TOILET
[Brown swatch]	PLANT ROOMS AND MAINTENANCE ACCESS
[Purple swatch]	INTERPRETATION ROOM
[Dark blue swatch]	EDUCATION CENTRE AND ANCILLARY SUPPORT
[Orange swatch]	MULTI-PURPOSE AND ANCILLARY SUPPORT
[Light purple swatch]	ART GALLERY AND ANCILLARY SUPPORT
[Pink swatch]	ARTS RELATED SUPPORT SPACE
[Light blue-grey swatch]	POLICE REPORTING CENTRE
[Red swatch]	ARTS RELATED ORGANIZATION ARCHIVES AND RECORD CENTRE
[Dark grey swatch]	SITE MANAGEMENT OFFICES AND STORE ROOMS

Figure 2.21

Proposed Master Layout  
Level 76.995 to 80.000

FILE: 0095646w11  
DATE: 29/12/2010

Environmental  
Resources  
Management



賽馬會文物保育有限公司  
The Jockey Club CPS Limited