

Inset 1: Avoid any sensitive facade with openable window facing Central Kowloon Route

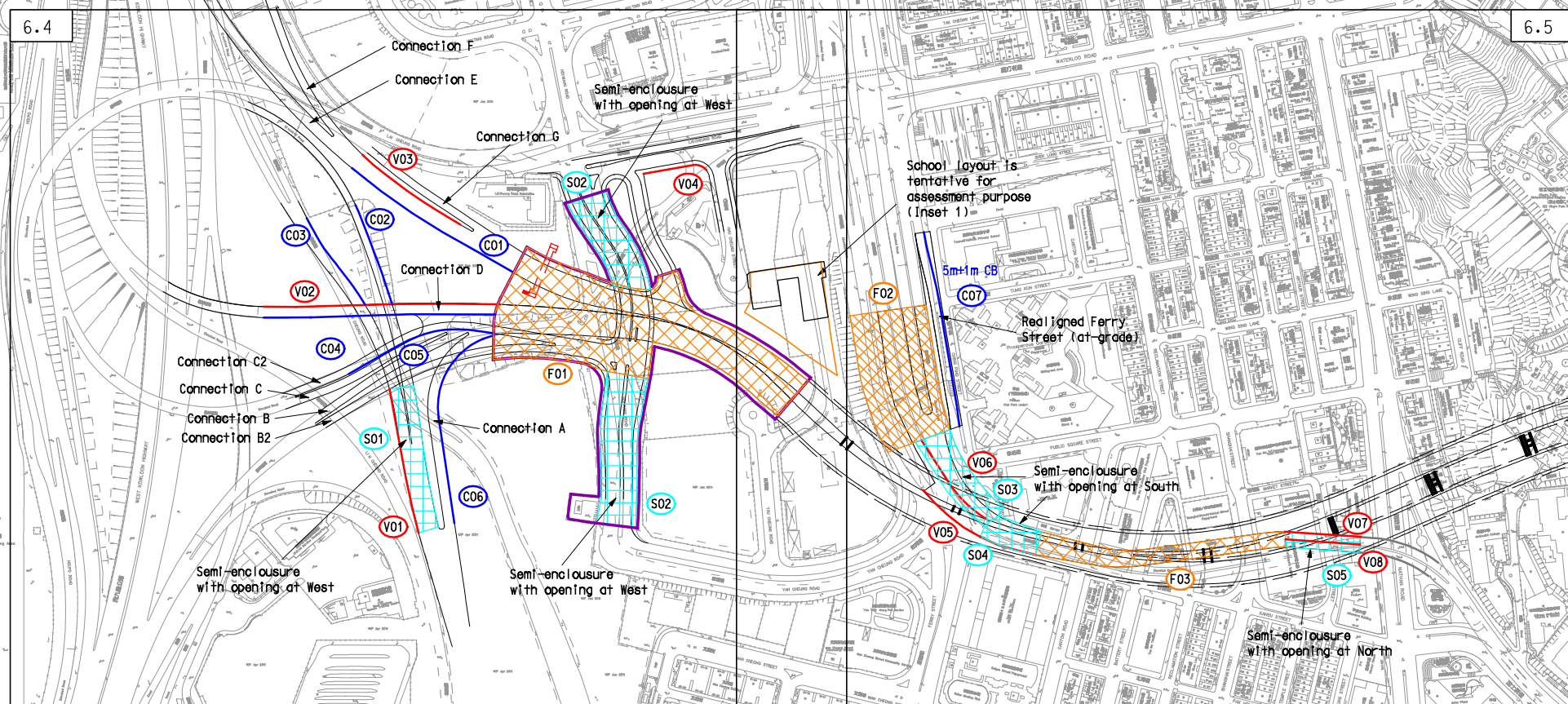

- Legend
- CKR Alignment
  - Planned G/IC Zone
  - Landscape Deck
  - Full-enclosure
  - Semi-enclosure
  - Vertical Barrier
  - Cantilevered Barrier
  - Avoid any sensitive facade with openable window facing Central Kowloon Route

E	FIFTH ISSUE	GL	01/13
D	FOURTH ISSUE	GL	12/12
C	THIRD ISSUE	GL	09/12
B	SECOND ISSUE	GL	06/12
A	FIRST ISSUE	GL	12/11
Rev	Description	By	Date



Project title  
**Agreement No. CE 43/2010 (HY)**  
**Central Kowloon Route - Design and Construction**

Drawing title  
**Location of Proposed Noise Mitigation Measures for Road Traffic Noise (West Portion) (Sheet 3 of 5)**

Drawing no. <b>Figure 6.3</b>		Rev. <b>E</b>	
Drawn GL	Date 01/13	Checked FC	Approved ST
Scale 1:5000 ON A3	Status <b>PRELIMINARY</b>		



Printed by : 1/28/2013  
 Filename : G:\env\project\217722-70\13 Drawing Deliverables\18 EM&A Manual\06 FinalSubmission\Ch. 6\Figure 6.3.dgn

