

- LEGEND AND ABBREVIATION:
- Proposed Sewer
 - Proposed Manhole
 - Proposed Tapping Pipe (subject to consultation with owners of houses with topographical problem)
 - Existing Dry Weather Flow Interceptor to be Modified
 - Existing Dry Weather Flow Interceptor
 - Label for Noise Sensitive Receiver

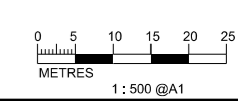

PRINTED BY: cheu8306 8/12/2013 9:53:40 AM
 FILENAME: F:\CHINA\DR\image_CADD\Project\IS\4572\FIGURE\ENVIRONMENT\NSR\4572-FIGURE-CC-4_2.dgn



Agreement No. CE 15/2010 (DS)
 Upgrading of Cheung Chau and Tai O Sewage Collection, Treatment and Disposal Facilities - Design and Construction
Outlying Islands Sewerage Stage 2 -
 Upgrading of Cheung Chau Sewage Collection, Treatment and Disposal Facilities

Title :	NOISE SENSITIVE RECEIVERS (SHEET 1 OF 14)		
Date :	August 2013	Figure :	4.2

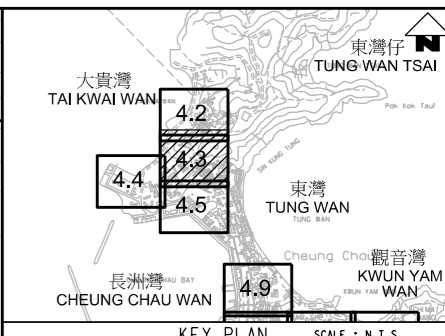
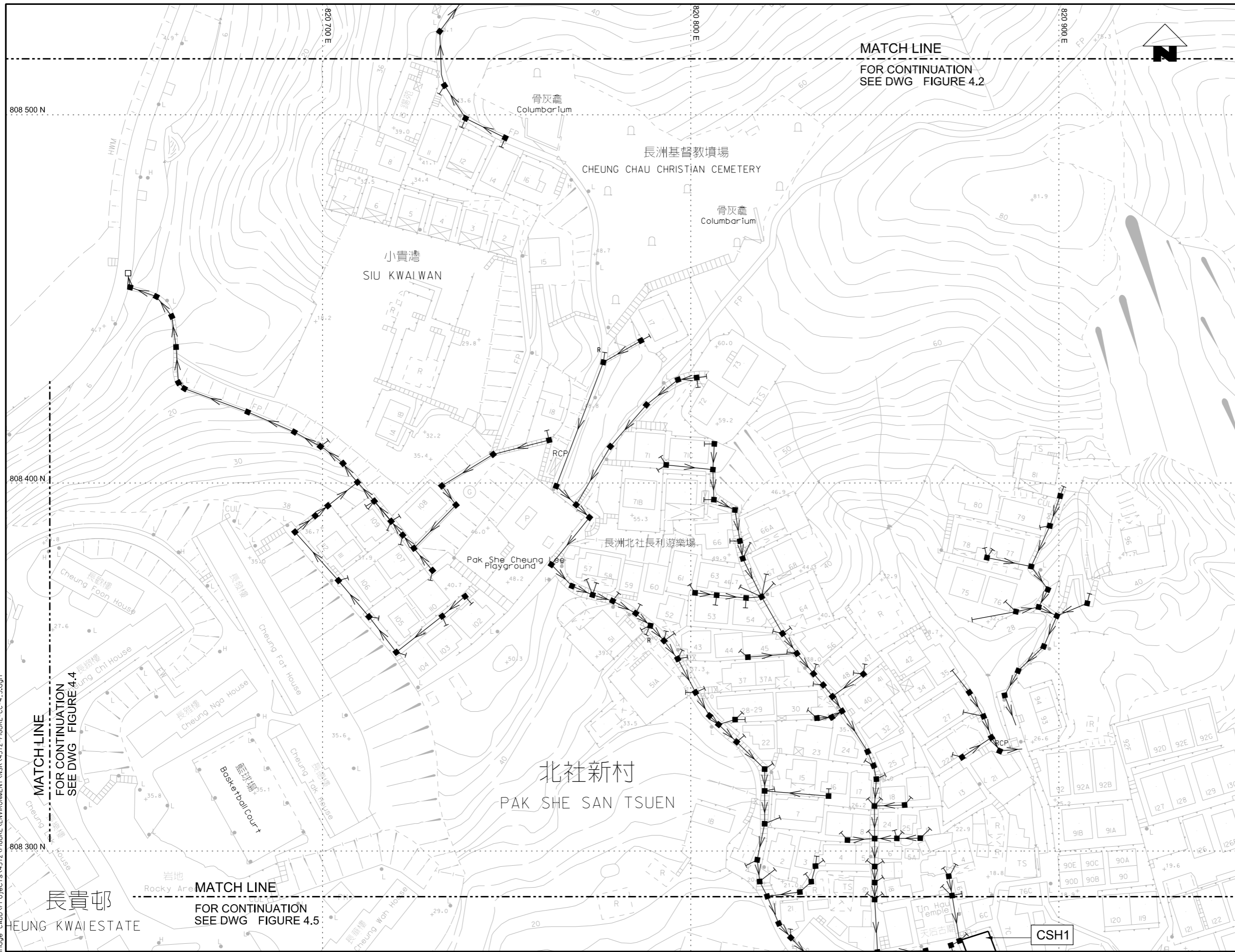

- LEGEND AND ABBREVIATION:
- Proposed Sewer
 - Proposed Manhole
 - Proposed Tapping Pipe (subject to consultation with owners of houses with topographical problem)
 - Existing Dry Weather Flow Interceptor to be Modified
 - Existing Dry Weather Flow Interceptor
 - Label for Noise Sensitive Receiver

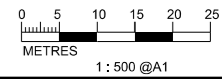

PRINTED BY: cheu8306 8/12/2013 9:53:41 AM
 FILENAME: P:\CHINA\DR\image\CADD\Project\54572\FIGURE\ENVIRONMENT\NSR\4572-FIGURE-CC-4_3.dgn

渠務署
DRAINAGE SERVICES DEPARTMENT

ATKINS

Agreement No. CE 15/2010 (DS)
 Upgrading of Cheung Chau and Tai O Sewage Collection, Treatment and Disposal Facilities - Design and Construction
Outlying Islands Sewerage Stage 2 -
 Upgrading of Cheung Chau Sewage Collection, Treatment and Disposal Facilities

Title :	NOISE SENSITIVE RECEIVERS (SHEET 2 OF 14)		
Date :	August 2013	Figure :	4.3

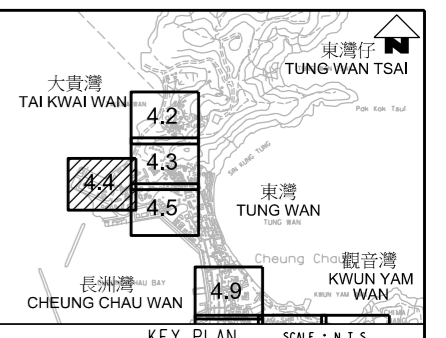
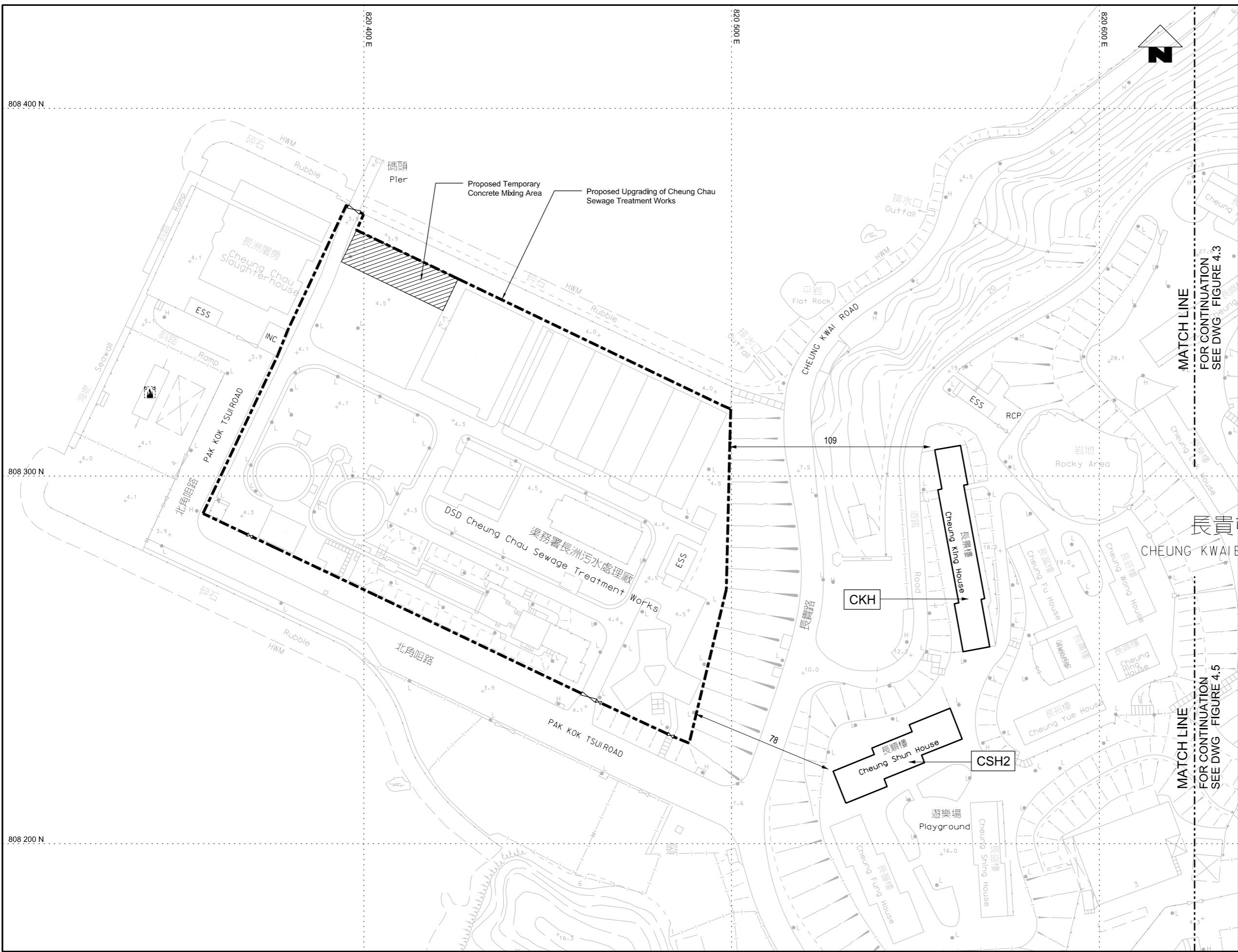

- LEGEND AND ABBREVIATION:
- Proposed Sewer
 - Proposed Manhole
 - Proposed Tapping Pipe (subject to consultation with owners of houses with topographical problem)
 - Existing Dry Weather Flow Interceptor to be Modified
 - Existing Dry Weather Flow Interceptor
 - Label for Noise Sensitive Receiver

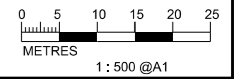

PRINTED BY: cheu8306 8/12/2013 9:51:42 AM
 FILENAME: F:\CHINA\UP\image_CADD\Project\IS\4572\FIGURE\ENVIRONMENT\NSR\4572-FIGURE-CC-4_4.dgn

Agreement No. CE 15/2010 (DS)
 Upgrading of Cheung Chau and Tai O Sewage Collection, Treatment and Disposal Facilities - Design and Construction
 Outlying Islands Sewerage Stage 2 -
 Upgrading of Cheung Chau Sewage Collection, Treatment and Disposal Facilities

Title :		NOISE SENSITIVE RECEIVERS (SHEET 3 OF 14)	
Date :	August 2013	Figure :	4.4

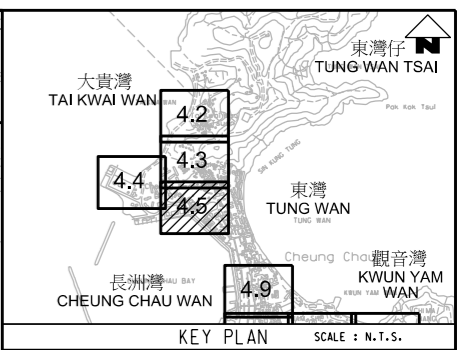
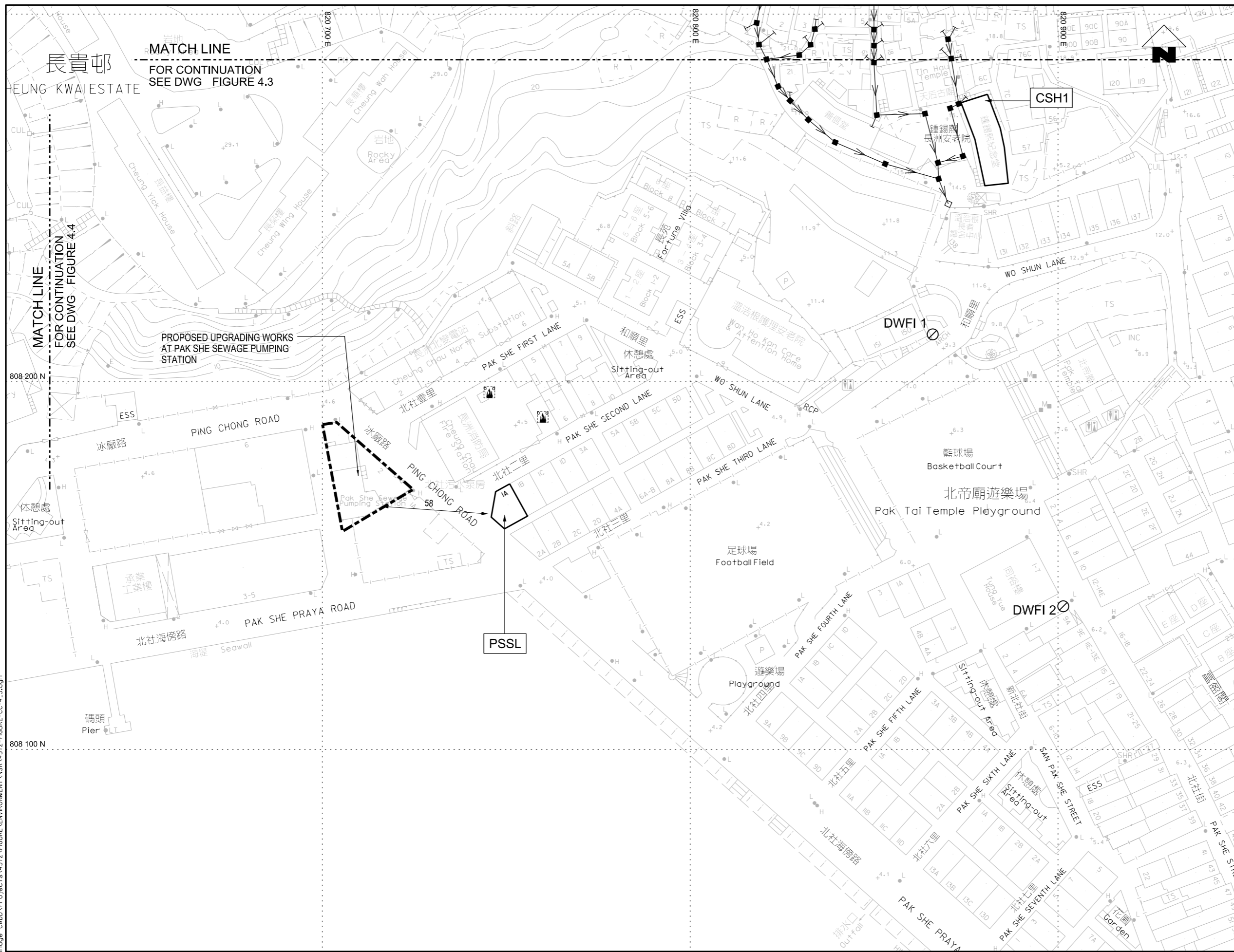

- LEGEND AND ABBREVIATION:
- Proposed Sewer
 - Proposed Manhole
 - Proposed Tapping Pipe (subject to consultation with owners of houses with topographical problem)
 - Existing Dry Weather Flow Interceptor to be Modified
 - Existing Dry Weather Flow Interceptor
 - Label for Noise Sensitive Receiver



PRINTED BY: cheu8306 8/12/2013 9:53:43 AM FILENAME: F:\CHINA\UP\ drainage CAD\Project\IS\4572\FIGURE\ENVIRONMENT\NSR\4572-FIGURE-CC-4.5.dgn



Agreement No. CE 15/2010 (DS)
 Upgrading of Cheung Chau and Tai O Sewage Collection, Treatment and Disposal Facilities - Design and Construction
 Outlying Islands Sewerage Stage 2 -
 Upgrading of Cheung Chau Sewage Collection, Treatment and Disposal Facilities

Title :	NOISE SENSITIVE RECEIVERS (SHEET 4 OF 14)		
Date :	August 2013	Figure :	4.5

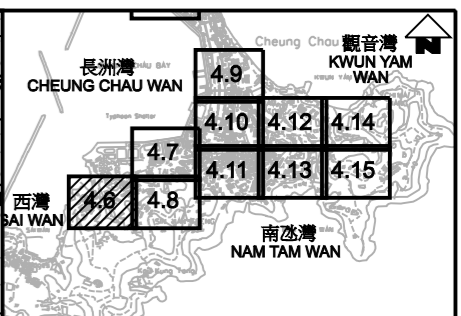
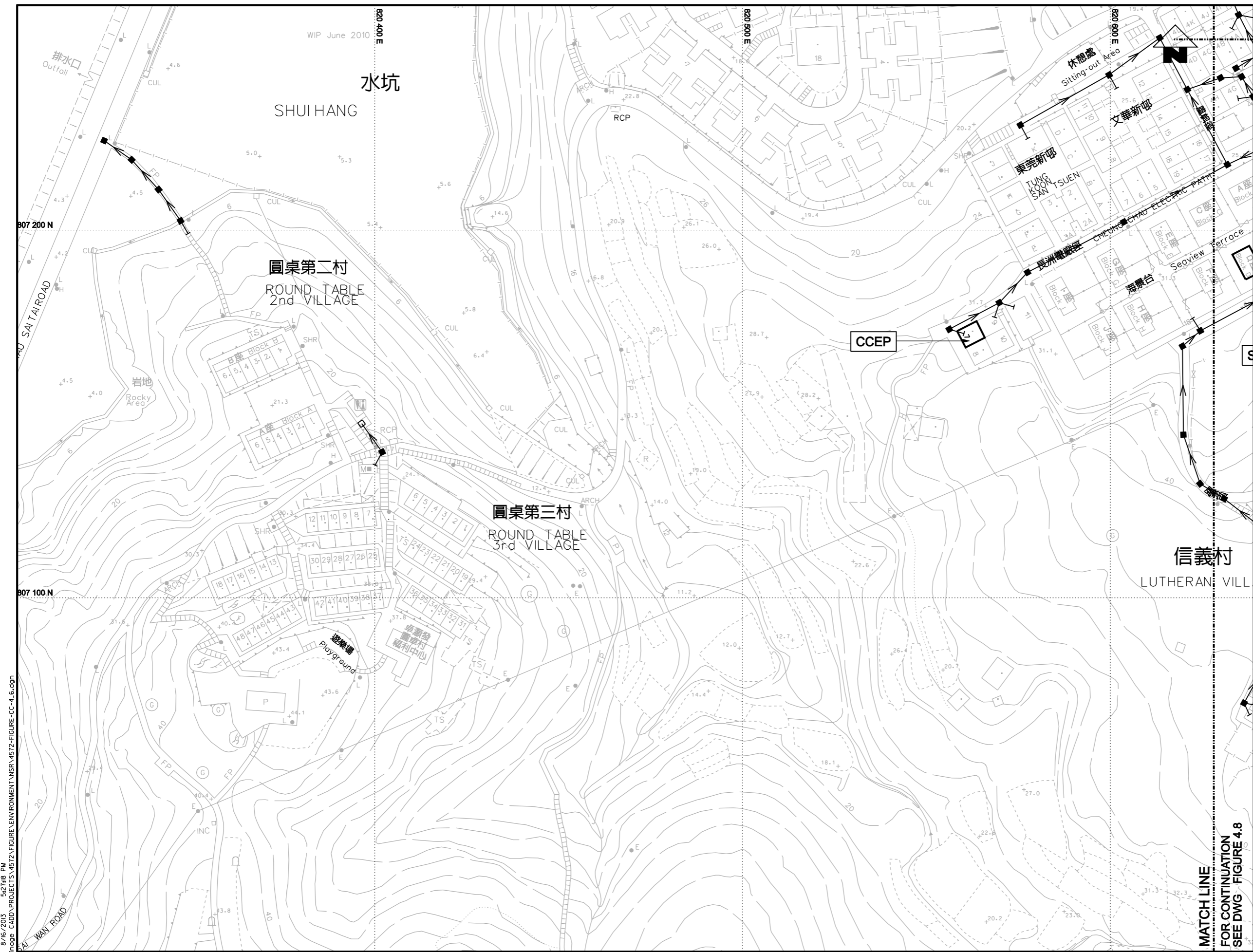

KEY PLAN SCALE 1 N.T.S.

- LEGEND AND ABBREVIATION:
- Proposed Sewer
 - Proposed Manhole
 - Proposed Tapping Pipe (subject to consultation with owners of houses with topographical problem)
 - Existing Dry Weather Flow Interceptor to be Modified
 - Existing Dry Weather Flow Interceptor
 - Label for Noise Sensitive Receiver

PRINTED BY: cheu8306 8/16/2013 5:27:48 PM
 FILENAME: P:\CHINA\CD\proj\cheung_cadd\project\5_1572\figure\environment\sr\4572-figure-cc-4_6.dgn

MATCH LINE
 FOR CONTINUATION
 SEE DWG. FIGURE 4.8

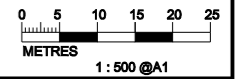

Agreement No. CE 15/2010 (DS)
 Upgrading of Cheung Chau and Tai O Sewage Collection, Treatment and Disposal Facilities - Design and Construction
Outlying Islands Sewerage Stage 2 -
 Upgrading of Cheung Chau Sewage Collection, Treatment and Disposal Facilities

Title :		NOISE SENSITIVE RECEIVERS (SHEET 5 OF 14)	
Date :	August 2013	Figure :	4.6

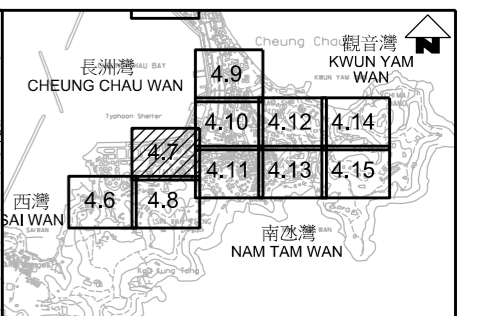
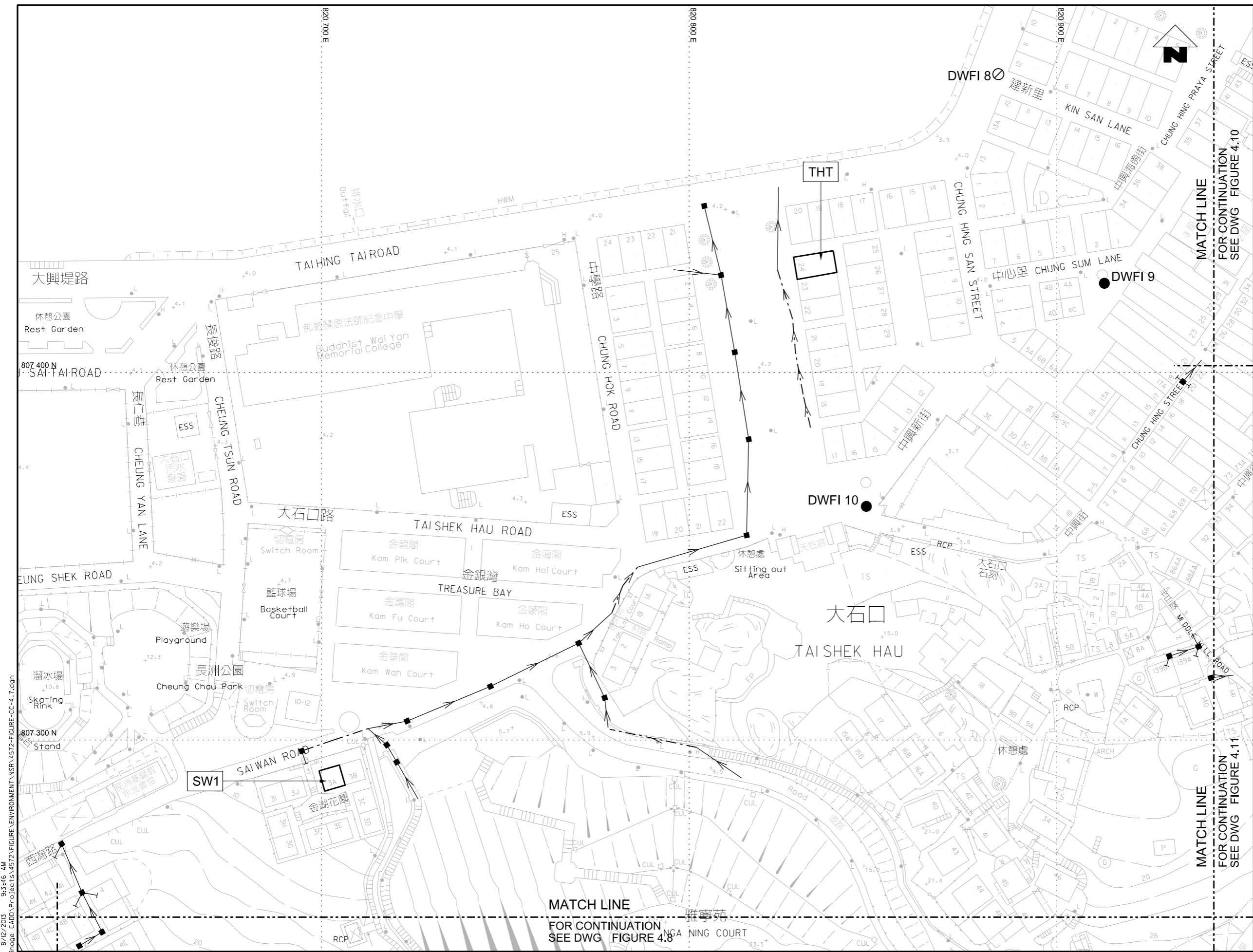

- KEY PLAN SCALE : N.T.S.
- LEGEND AND ABBREVIATION:
- Proposed Sewer
 - Proposed Manhole
 - Proposed Tapping Pipe (subject to consultation with owners of houses with topographical problem)
 - Existing Dry Weather Flow Interceptor to be Modified
 - Existing Dry Weather Flow Interceptor
 - Label for Noise Sensitive Receiver
 - Existing Sewer to be Upgraded

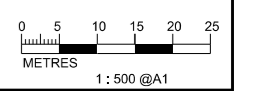

PRINTED BY: cheu8306 8/12/2013 9:53:46 AM
 FILENAME: F:\CHINA\UP\image_CADD\Project\IS\4572\FIGURE\ENVIRONMENT\NSR\4572-FIGURE-CC-4_7.dgn



Agreement No. CE 15/2010 (DS)
 Upgrading of Cheung Chau and Tai O Sewage Collection, Treatment and Disposal Facilities - Design and Construction
 Outlying Islands Sewerage Stage 2 -
 Upgrading of Cheung Chau Sewage Collection, Treatment and Disposal Facilities

Title :		NOISE SENSITIVE RECEIVERS (SHEET 6 OF 14)	
Date :	August 2013	Figure :	4.7

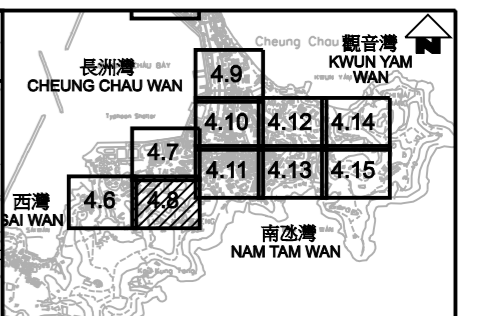
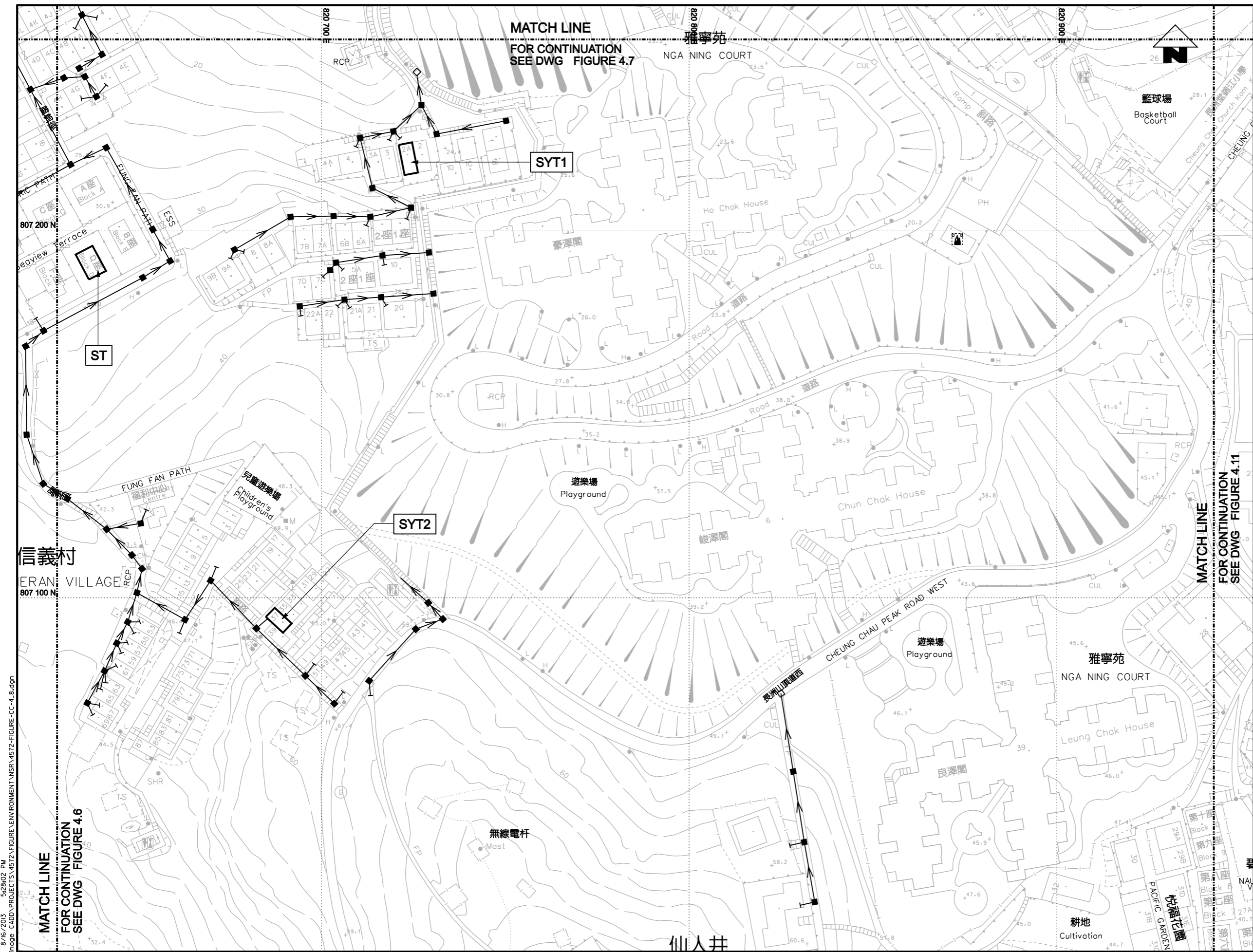

KEY PLAN SCALE: 1 N.T.S.

- LEGEND AND ABBREVIATION:
- Proposed Sewer
 - Proposed Manhole
 - Proposed Tapping Pipe (subject to consultation with owners of houses with topographical problem)
 - Existing Dry Weather Flow Interceptor to be Modified
 - Existing Dry Weather Flow Interceptor
 - Label for Noise Sensitive Receiver

PRINTED BY: cheu8306 8/16/2013 5:28:02 PM
 FILENAME: P:\CHKKA\up\img CADD\PROJECTS\151572\FIGURE\ENVIRONMENT\NSR\151572-FIGURE-CC-4_8.dgn

MATCH LINE FOR CONTINUATION SEE DWG FIGURE 4.6

MATCH LINE FOR CONTINUATION SEE DWG FIGURE 4.11

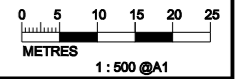

Agreement No. CE 15/2010 (DS)
 Upgrading of Cheung Chau and Tai O Sewage Collection, Treatment and Disposal Facilities - Design and Construction
 Outlying Islands Sewerage Stage 2 -
 Upgrading of Cheung Chau Sewage Collection, Treatment and Disposal Facilities

Title :

Date :

NOISE SENSITIVE RECEIVERS (SHEET 7 OF 14)

August 2013

Figure :

4.8

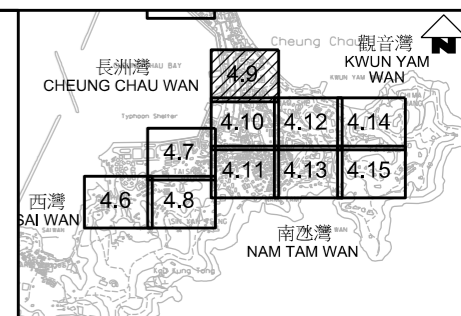
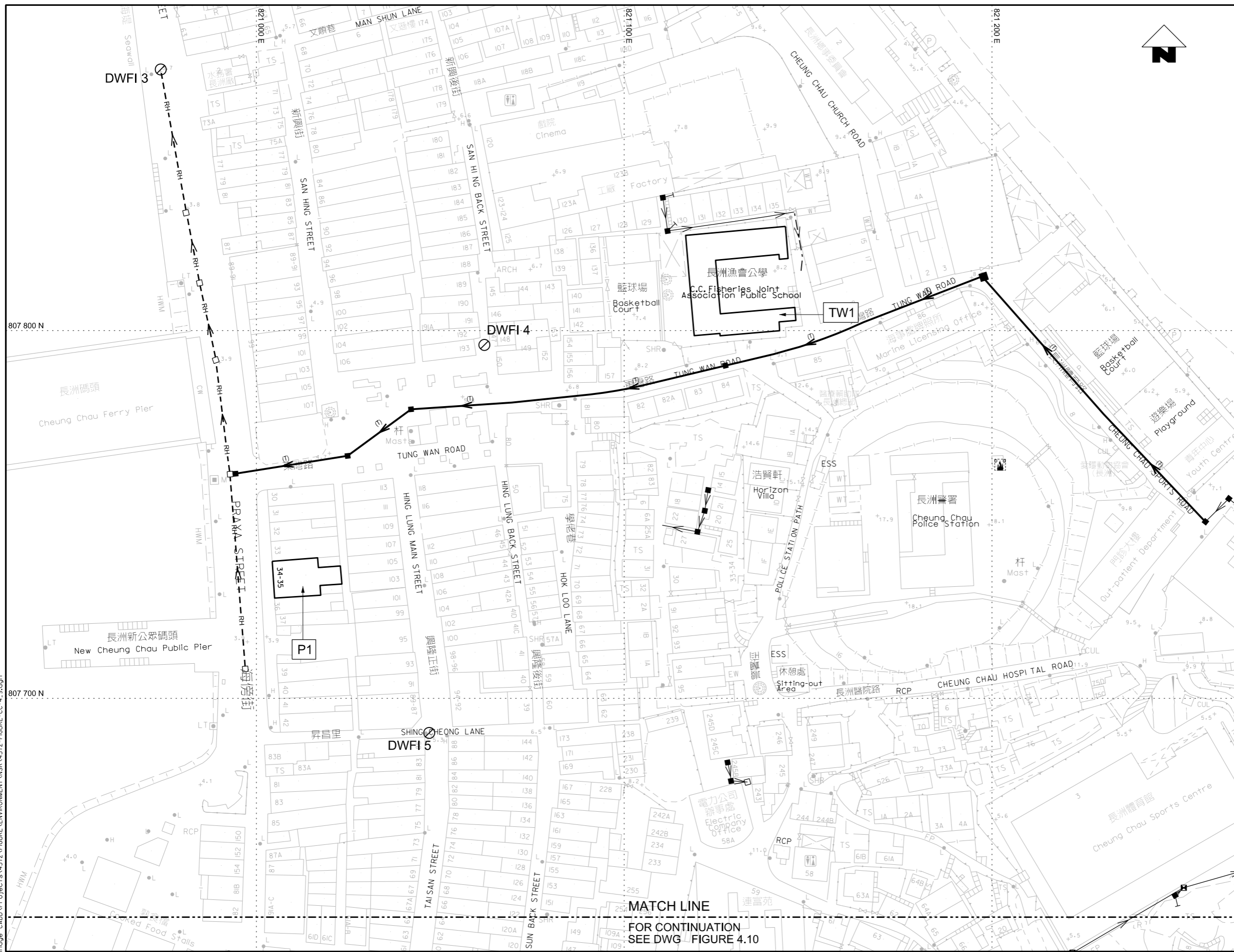

KEY PLAN SCALE : N.T.S.

- LEGEND AND ABBREVIATION:
- Proposed Sewer
 - Proposed Manhole
 - Proposed Tapping Pipe (subject to consultation with owners of houses with topographical problem)
 - Existing Dry Weather Flow Interceptor to be Modified
 - Existing Dry Weather Flow Interceptor
 - Label for Noise Sensitive Receiver
 - Existing Sewer to be Upgraded
 - Proposed Sewer to be Constructed using trenchless method
 - Existing Sewer to be Rehabilitated

MATCH LINE
FOR CONTINUATION
SEE DWG. FIGURE 4.10

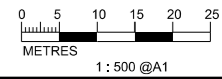

PRINTED BY: cheu8306 8/12/2013 9:53:49 AM FILENAME: P:\CHINA\UP\image_CADD\Project\15_4572\FIGURE\ENVIRONMENT\NSRV\4572-FIGURE-CC-4_9.dgn



Agreement No. CE 15/2010 (DS)
Upgrading of Cheung Chau and Tai O Sewage Collection, Treatment and Disposal Facilities - Design and Construction
Outlying Islands Sewerage Stage 2 -
Upgrading of Cheung Chau Sewage Collection, Treatment and Disposal Facilities

Title :	NOISE SENSITIVE RECEIVERS (SHEET 8 OF 14)		
Date :	August 2013	Figure :	4.9

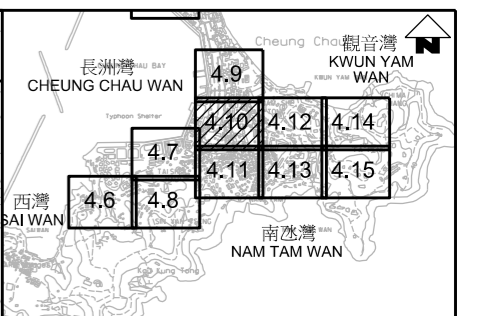
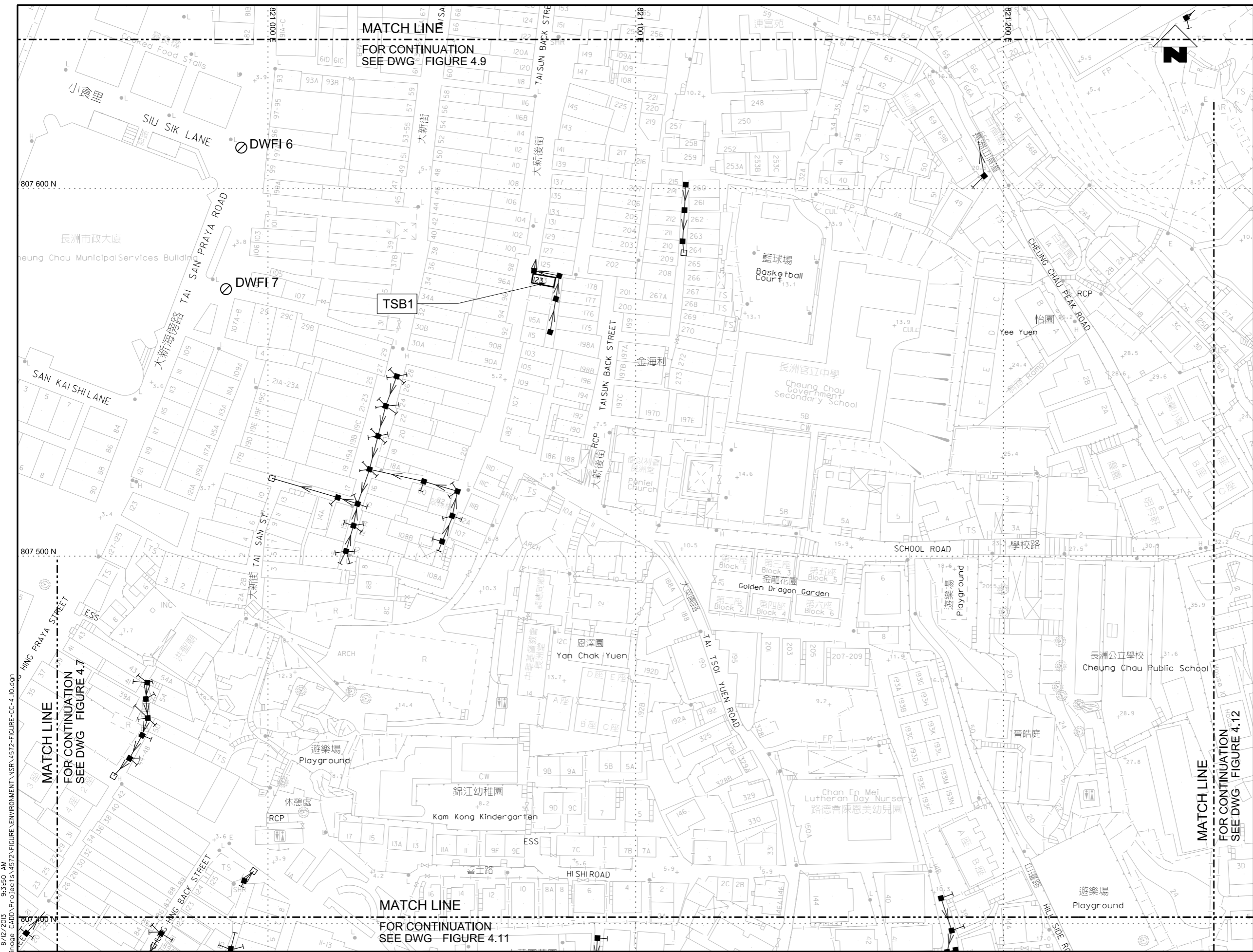

- KEY PLAN SCALE : N.T.S.
- LEGEND AND ABBREVIATION:
- Proposed Sewer
 - Proposed Manhole
 - Proposed Tapping Pipe (subject to consultation with owners of houses with topographical problem)
 - Existing Dry Weather Flow Interceptor to be Modified
 - Existing Dry Weather Flow Interceptor
 - Label for Noise Sensitive Receiver

PRINTED BY: cheuk8306 8/12/2013 9:35:50 AM
 FILENAME: P:\CHINA\UP\orange_CADD\Project\IS_4572\FIGURE\ENVIRONMENT\NSR\4572-FIGURE-CC-4_10.dgn

Agreement No. CE 15/2010 (DS)
 Upgrading of Cheung Chau and Tai O Sewage Collection, Treatment and Disposal Facilities - Design and Construction
Outlying Islands Sewerage Stage 2 -
 Upgrading of Cheung Chau Sewage Collection, Treatment and Disposal Facilities

Title : NOISE SENSITIVE RECEIVERS (SHEET 9 OF 14)	
Date : August 2013	Figure : 4.10

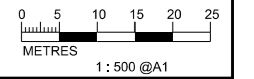

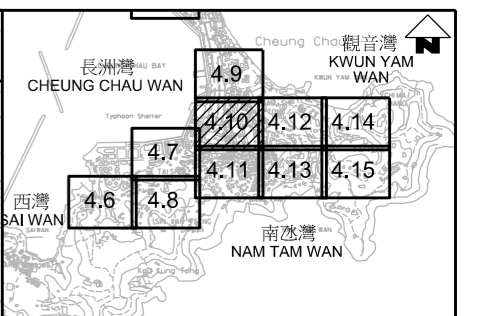
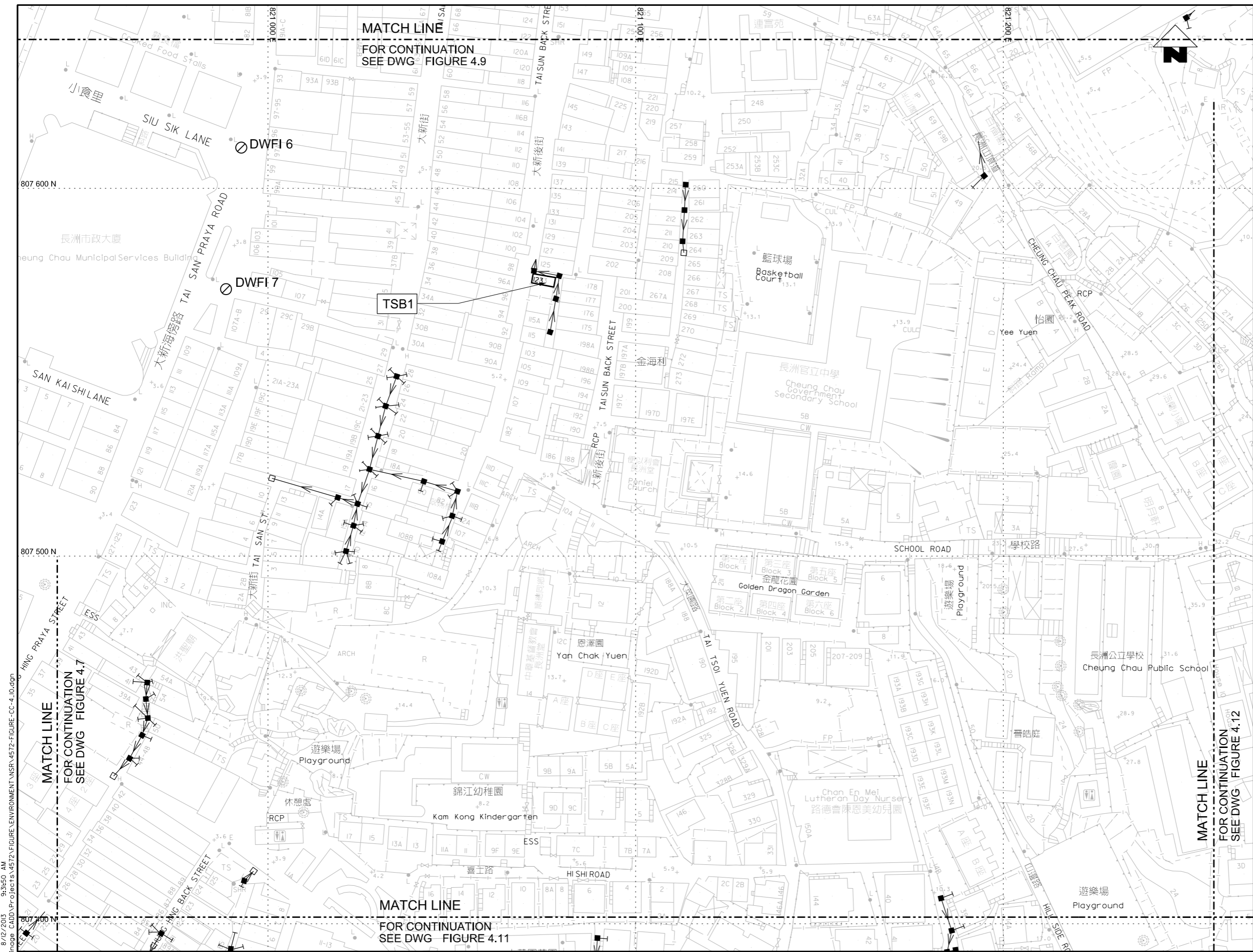

KEY PLAN SCALE : N.T.S.

- LEGEND AND ABBREVIATION:
- Proposed Sewer
 - Proposed Manhole
 - Proposed Tapping Pipe (subject to consultation with owners of houses with topographical problem)
 - Existing Dry Weather Flow Interceptor to be Modified
 - Existing Dry Weather Flow Interceptor
 - Label for Noise Sensitive Receiver

PRINTED BY: cheuk8306 8/12/2013 9:31:50 AM
 FILENAME: P:\CHINA\UP\orange_CADD\Project\IS_4572\FIGURE\ENVIRONMENT\NSR\4572-FIGURE-CC-4_10.dgn

Agreement No. CE 15/2010 (DS)
 Upgrading of Cheung Chau and Tai O Sewage Collection, Treatment and Disposal Facilities - Design and Construction
 Outlying Islands Sewerage Stage 2 -
 Upgrading of Cheung Chau Sewage Collection, Treatment and Disposal Facilities

Title : NOISE SENSITIVE RECEIVERS (SHEET 9 OF 14)	
Date : August 2013	Figure : 4.10

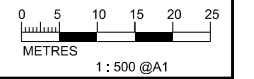

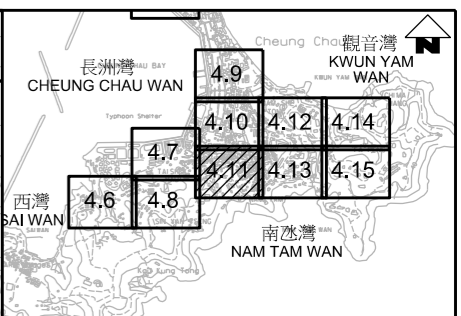
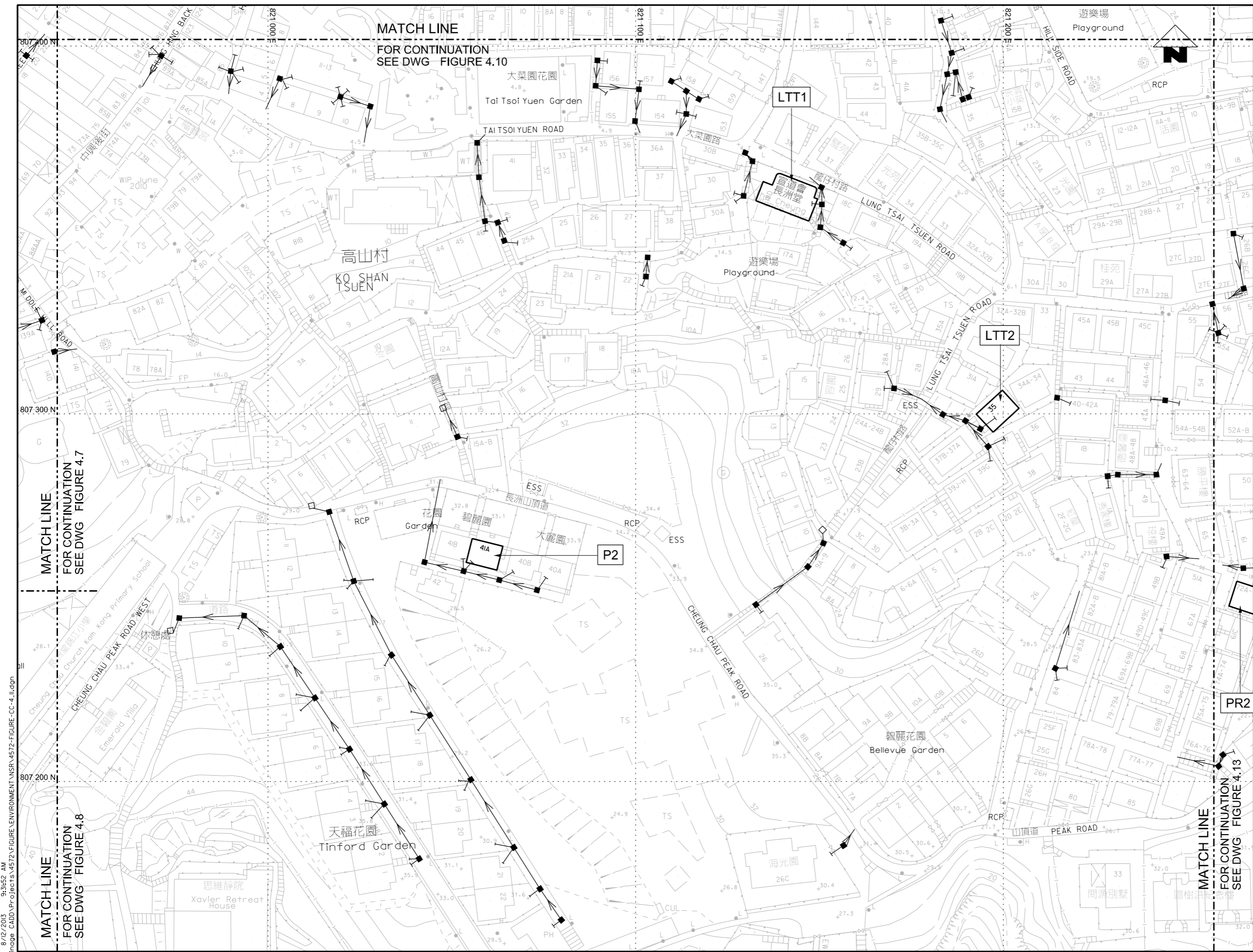

KEY PLAN SCALE : N.T.S.

- LEGEND AND ABBREVIATION:
- Proposed Sewer
 - Proposed Manhole
 - Proposed Tapping Pipe (subject to consultation with owners of houses with topographical problem)
 - Existing Dry Weather Flow Interceptor to be Modified
 - Existing Dry Weather Flow Interceptor
 - Label for Noise Sensitive Receiver

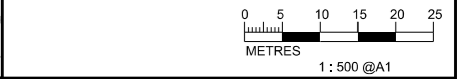

PRINTED BY: cheu8306 8/12/2013 9:31:52 AM
 FILENAME: P:\CHINA\DR\image_CADD\Project\15_4572\FIGURE\ENVIRONMENT\NSR\4572-FIGURE-CC-4_11.dgn

渠務署
DRAINAGE SERVICES DEPARTMENT

ATKINS

Agreement No. CE 15/2010 (DS)
 Upgrading of Cheung Chau and Tai O Sewage Collection, Treatment and Disposal Facilities - Design and Construction
 Outlying Islands Sewerage Stage 2 -
 Upgrading of Cheung Chau Sewage Collection, Treatment and Disposal Facilities

Title :	NOISE SENSITIVE RECEIVERS (SHEET 10 OF 14)		
Date :	August 2013	Figure :	4.11

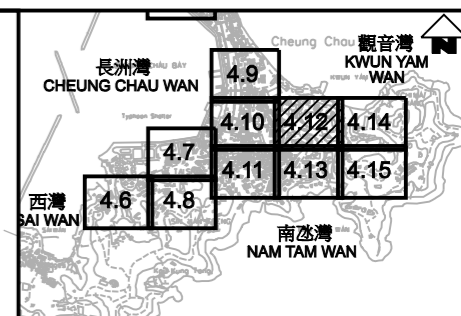
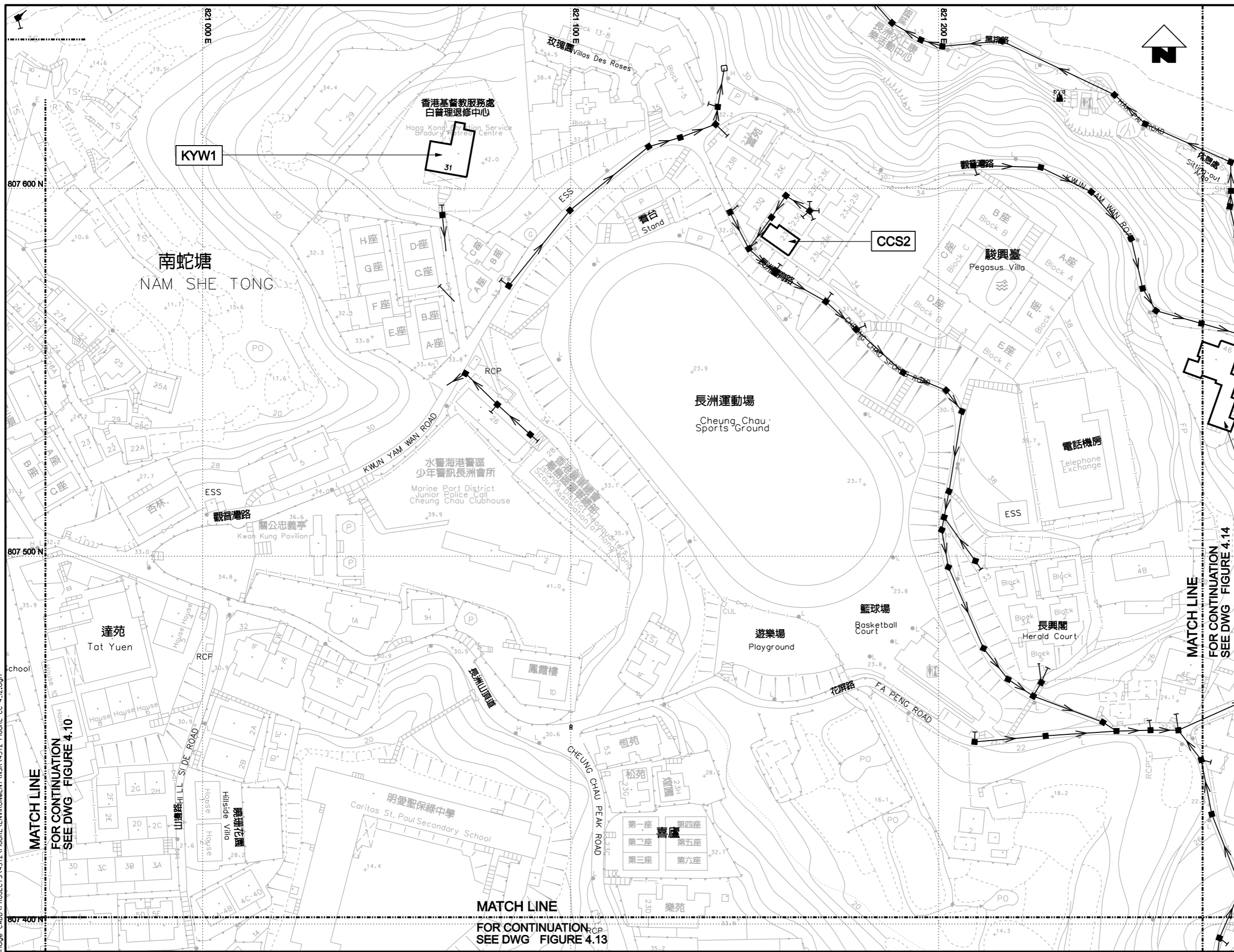

KEY PLAN SCALE: 1 N.T.S.

- LEGEND AND ABBREVIATION:
- Proposed Sewer
 - Proposed Manhole
 - Proposed Tapping Pipe (subject to consultation with owners of houses with topographical problem)
 - Existing Dry Weather Flow Interceptor to be Modified
 - Existing Dry Weather Flow Interceptor
 - Label for Noise Sensitive Receiver

MATCH LINE FOR CONTINUATION SEE DWG FIGURE 4.10

MATCH LINE FOR CONTINUATION SEE DWG FIGURE 4.14

MATCH LINE FOR CONTINUATION SEE DWG FIGURE 4.13

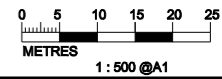

PRINTED BY: cheu8306 8/16/2013 5:29:46 PM FILENAME: P:\CHINA\up\orange CAD\PROJECTS\4572\FIGURE\ENVIRONMENT\NSR\4572-FIGURE-ENVIRONMENT-NSR-4572-FIGURE-CC-4.12.dgn



Agreement No. CE 15/2010 (DS)
 Upgrading of Cheung Chau and Tai O Sewage Collection, Treatment and Disposal Facilities - Design and Construction
 Outlying Islands Sewerage Stage 2 -
 Upgrading of Cheung Chau Sewage Collection, Treatment and Disposal Facilities

Title :	NOISE SENSITIVE RECEIVERS (SHEET 11 OF 14)		
Date :	August 2013	Figure :	4.12

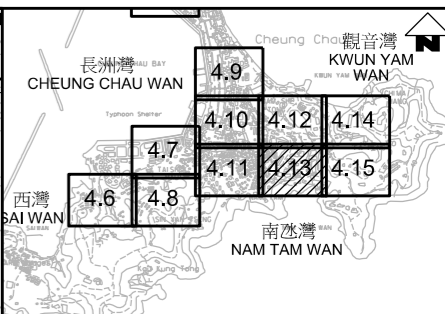
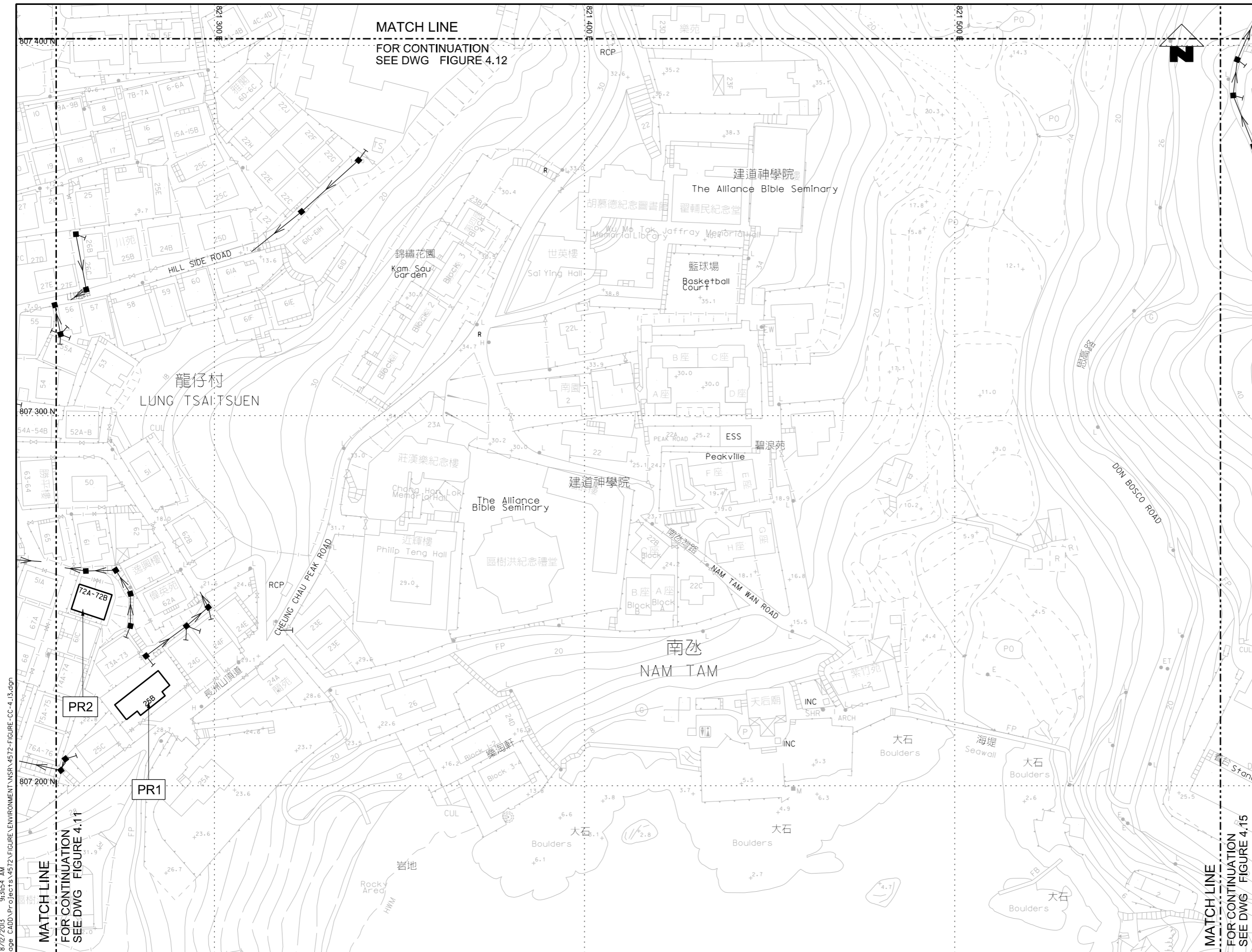

KEY PLAN SCALE : N.T.S.

- LEGEND AND ABBREVIATION:
- Proposed Sewer
 - Proposed Manhole
 - Proposed Tapping Pipe (subject to consultation with owners of houses with topographical problem)
 - Existing Dry Weather Flow Interceptor to be Modified
 - Existing Dry Weather Flow Interceptor
 - Label for Noise Sensitive Receiver

PRINTED BY: cheung306 8/12/2013 9:35:54 AM
 FILENAME: F:\CHINA\UP\orange_CADD\Project\54572\FIGURE\ENVIRONMENT\NSR\4572-FIGURE-CC-4_13.dgn

MATCH LINE
 FOR CONTINUATION
 SEE DWG FIGURE 4.11

MATCH LINE
 FOR CONTINUATION
 SEE DWG FIGURE 4.15

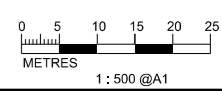

Agreement No. CE 15/2010 (DS)
 Upgrading of Cheung Chau and Tai O Sewage Collection, Treatment and Disposal Facilities - Design and Construction
Outlying Islands Sewerage Stage 2 -
 Upgrading of Cheung Chau Sewage Collection, Treatment and Disposal Facilities

Title :		NOISE SENSITIVE RECEIVERS (SHEET 12 OF 14)	
Date :	August 2013	Figure :	4.13

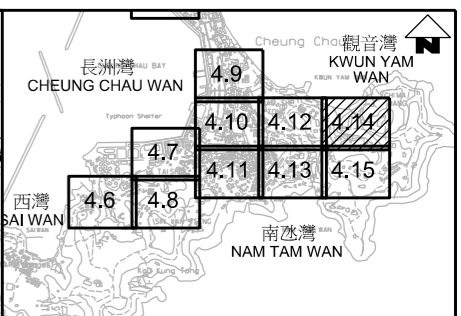
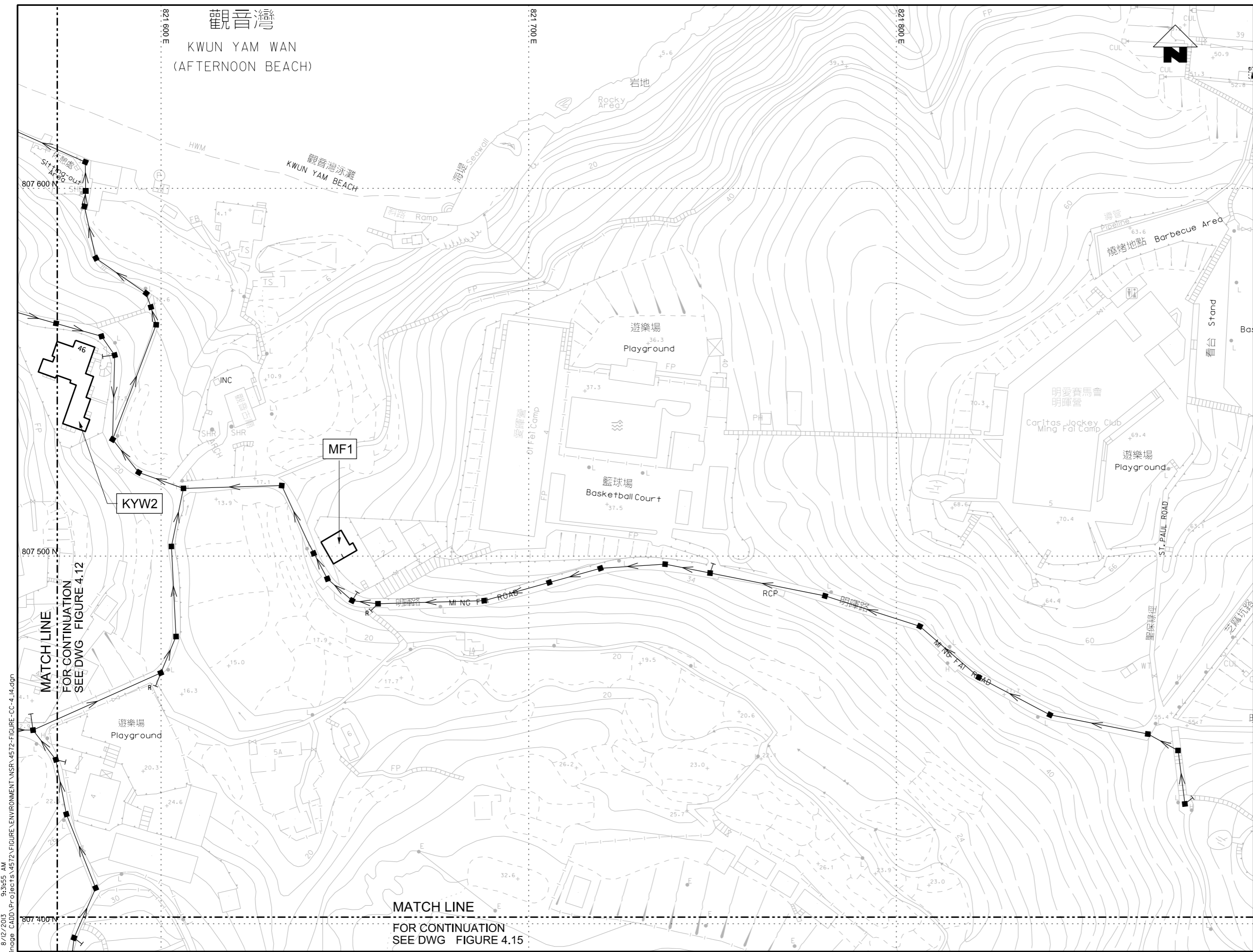

KEY PLAN SCALE : N.T.S.

- LEGEND AND ABBREVIATION:
- Proposed Sewer
 - Proposed Manhole
 - Proposed Tapping Pipe (subject to consultation with owners of houses with topographical problem)
 - Existing Dry Weather Flow Interceptor to be Modified
 - Existing Dry Weather Flow Interceptor
 - Label for Noise Sensitive Receiver

PRINTED BY: cheu8306 8/12/2013 9:35:55 AM
 FILENAME: F:\CHINA\Up\orange_CADD\Project\IS\4572\FIGURE\ENVIRONMENT\NSR\4572-FIGURE-CC-4_14.dgn

MATCH LINE
 FOR CONTINUATION
 SEE DWG FIGURE 4.12

MATCH LINE
 FOR CONTINUATION
 SEE DWG FIGURE 4.15

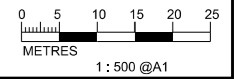

Agreement No. CE 15/2010 (DS)
 Upgrading of Cheung Chau and Tai O Sewage Collection, Treatment and Disposal Facilities - Design and Construction
Outlying Islands Sewerage Stage 2 -
 Upgrading of Cheung Chau Sewage Collection, Treatment and Disposal Facilities

Title :	NOISE SENSITIVE RECEIVERS (SHEET 13 OF 14)		
Date :	August 2013	Figure :	4.14

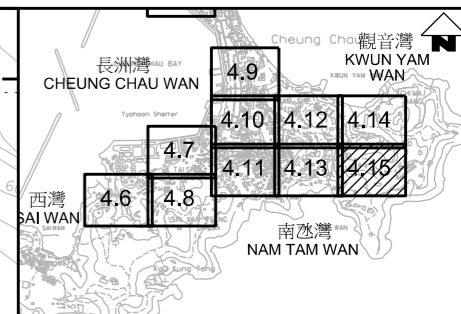
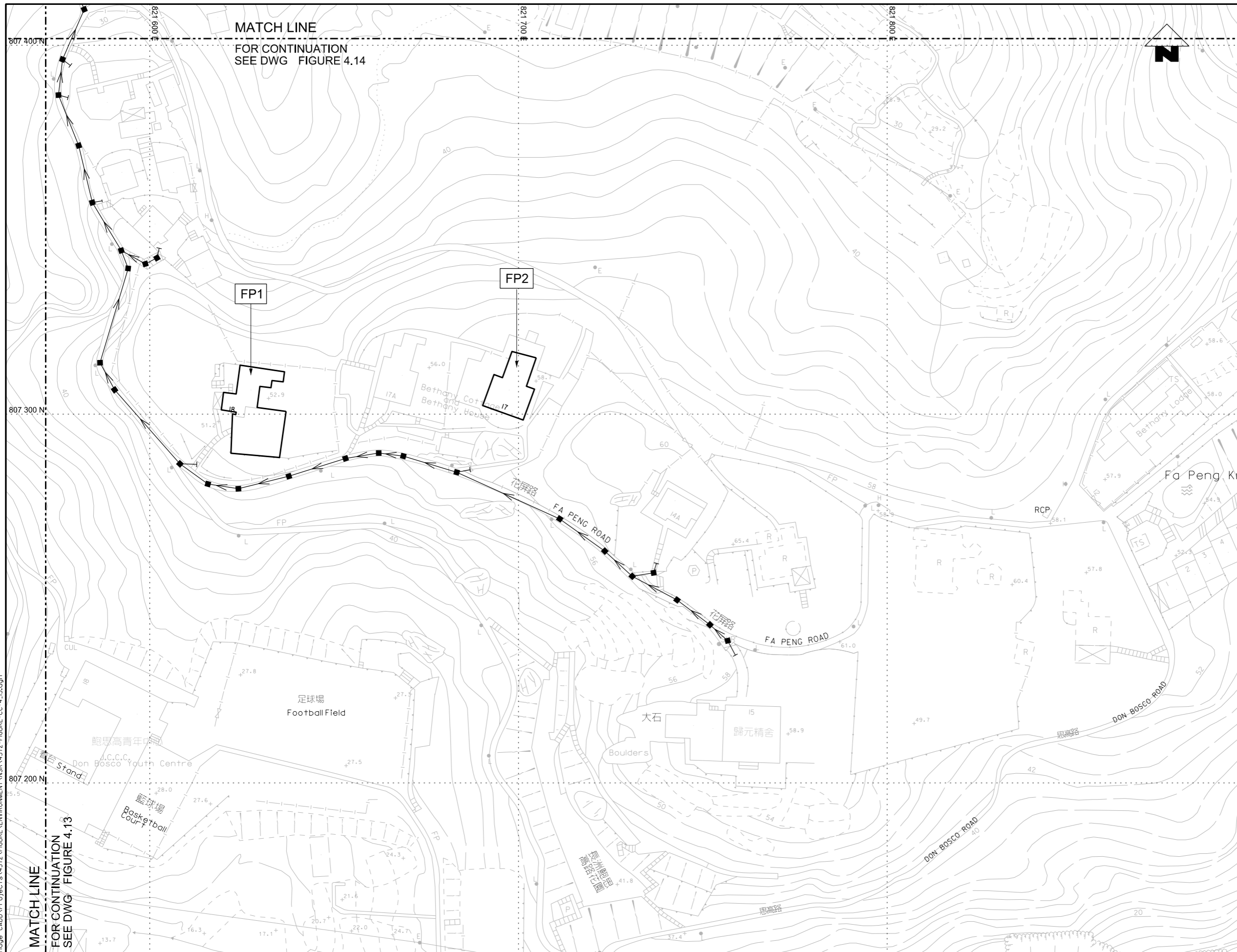

KEY PLAN SCALE : N.T.S.

- LEGEND AND ABBREVIATION:
- Proposed Sewer
 - Proposed Manhole
 - Proposed Tapping Pipe (subject to consultation with owners of houses with topographical problem)
 - Existing Dry Weather Flow Interceptor to be Modified
 - Existing Dry Weather Flow Interceptor
 - Label for Noise Sensitive Receiver

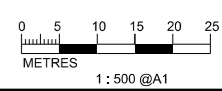

PRINTED BY: cheu8306 8/12/2013 9:35:56 AM
 FILENAME: P:\CHINA\DR\image_CADD\Project\IS\4572\FIGURE\ENVIRONMENT\SRV\4572-FIGURE-ENVIRONMENT-CC-4_15.dgn

MATCH LINE
 FOR CONTINUATION
 SEE DWG FIGURE 4.13

MATCH LINE
 FOR CONTINUATION
 SEE DWG FIGURE 4.14

Agreement No. CE 15/2010 (DS)
 Upgrading of Cheung Chau and Tai O Sewage Collection, Treatment and Disposal Facilities - Design and Construction
Outlying Islands Sewerage Stage 2 -
 Upgrading of Cheung Chau Sewage Collection, Treatment and Disposal Facilities

Title :	NOISE SENSITIVE RECEIVERS (SHEET 14 OF 14)		
Date :	August 2013	Figure :	4.15