

KEY PLAN SCALE : N.T.S.

- LEGEND AND ABBREVIATION:
- Proposed Sewer
 - Proposed Manhole
 - Proposed Rising Main
 - Proposed Tapping Pipe (subject to consultation with owners of houses with topographical problem)
 - Proposed Sewage Pumping Station
 - Label for Noise Sensitive Receiver
 - 300m Study Boundary

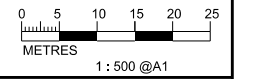

PRINTED BY: cheu6306 7/2/2014 4:00:44 PM
 FILENAME: F:\CHINA\UP\image_CADD\Project\154572\FIGURE\EA-TAIO\A1r - Sensitive\4572-FIGURE-TO-4-1.dgn

D 渠務署
DRAINAGE SERVICES DEPARTMENT

ATKINS

Agreement No. CE 15/2010 (DS)
 Upgrading of Cheung Chau and Tai O Sewerage Collection, Treatment and Disposal Facilities - Design and Construction
 Outlying Islands Sewerage Stage 2 -
 Upgrading of Tai O Sewerage Collection, Treatment and Disposal Facilities

Title :

Date :

NOISE SENSITIVE RECEIVERS
(Sheet 1 of 11)

MAY 2015

Figure :

4.1

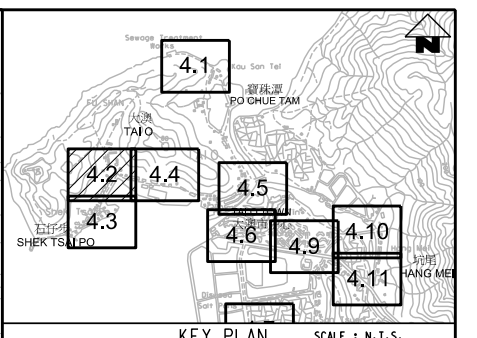
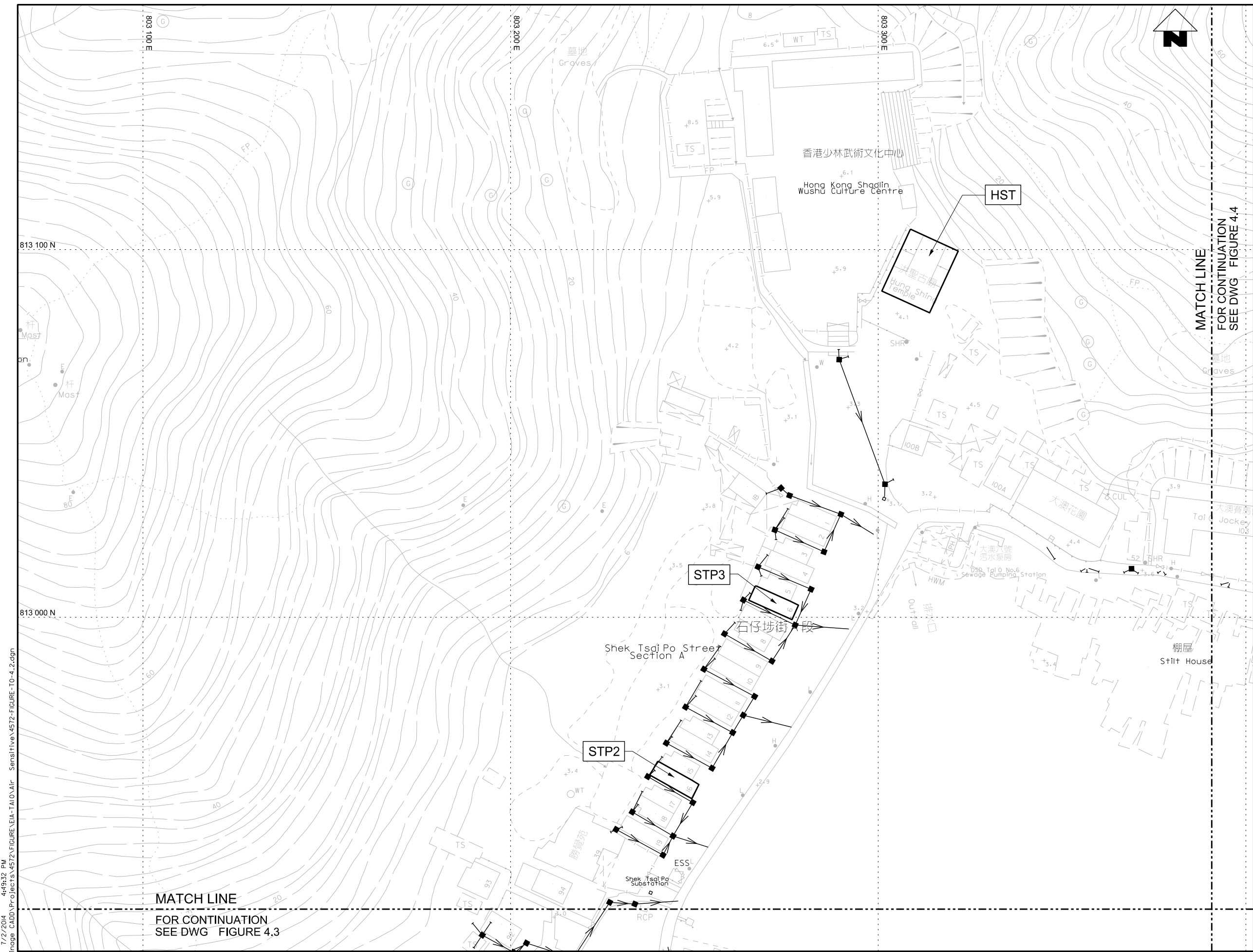

KEY PLAN SCALE : N.T.S.

- LEGEND AND ABBREVIATION:
- Proposed Sewer
 - Proposed Manhole
 - Proposed Rising Main
 - Proposed Tapping Pipe (subject to consultation with owners of houses with topographical problem)
 - Proposed Sewage Pumping Station
 - Label for Noise Sensitive Receiver
 - 300m Study Boundary

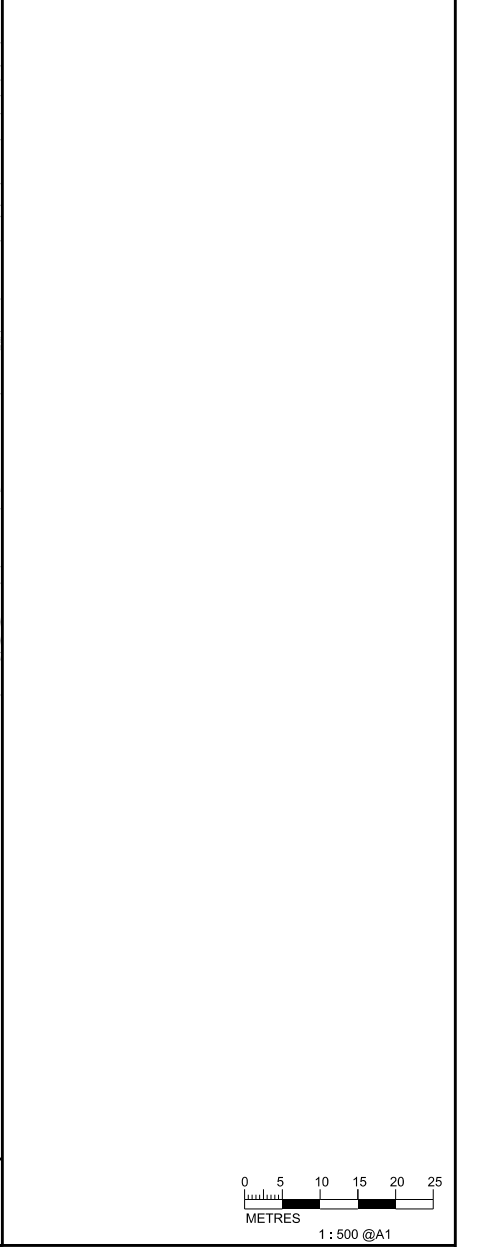

PRINTED BY: cheu6306 7/2/2014 4:49:32 PM
 FILENAME: F:\CHINA\DR\image_CADD\Project\54572\FIGURE\EA-TAIO\Air_Sensitive\4572-FIGURE-TO-4.2.dgn

MATCH LINE
FOR CONTINUATION
SEE DWG FIGURE 4.3

MATCH LINE
FOR CONTINUATION
SEE DWG FIGURE 4.4



Agreement No. CE 15/2010 (DS)
 Upgrading of Cheung Chau and Tai O Sewerage Collection, Treatment and Disposal Facilities - Design and Construction
 Outlying Islands Sewerage Stage 2 -
 Upgrading of Tai O Sewerage Collection, Treatment and Disposal Facilities

Title :

NOISE SENSITIVE RECEIVERS
(Sheet 2 of 11)

Date :

MAY 2015

Figure :

4.2

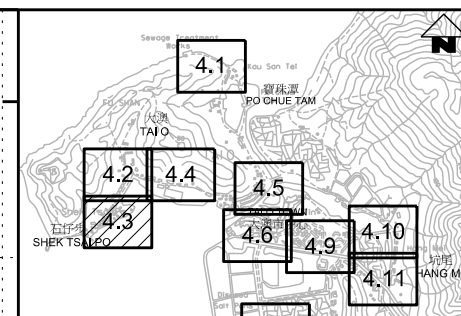
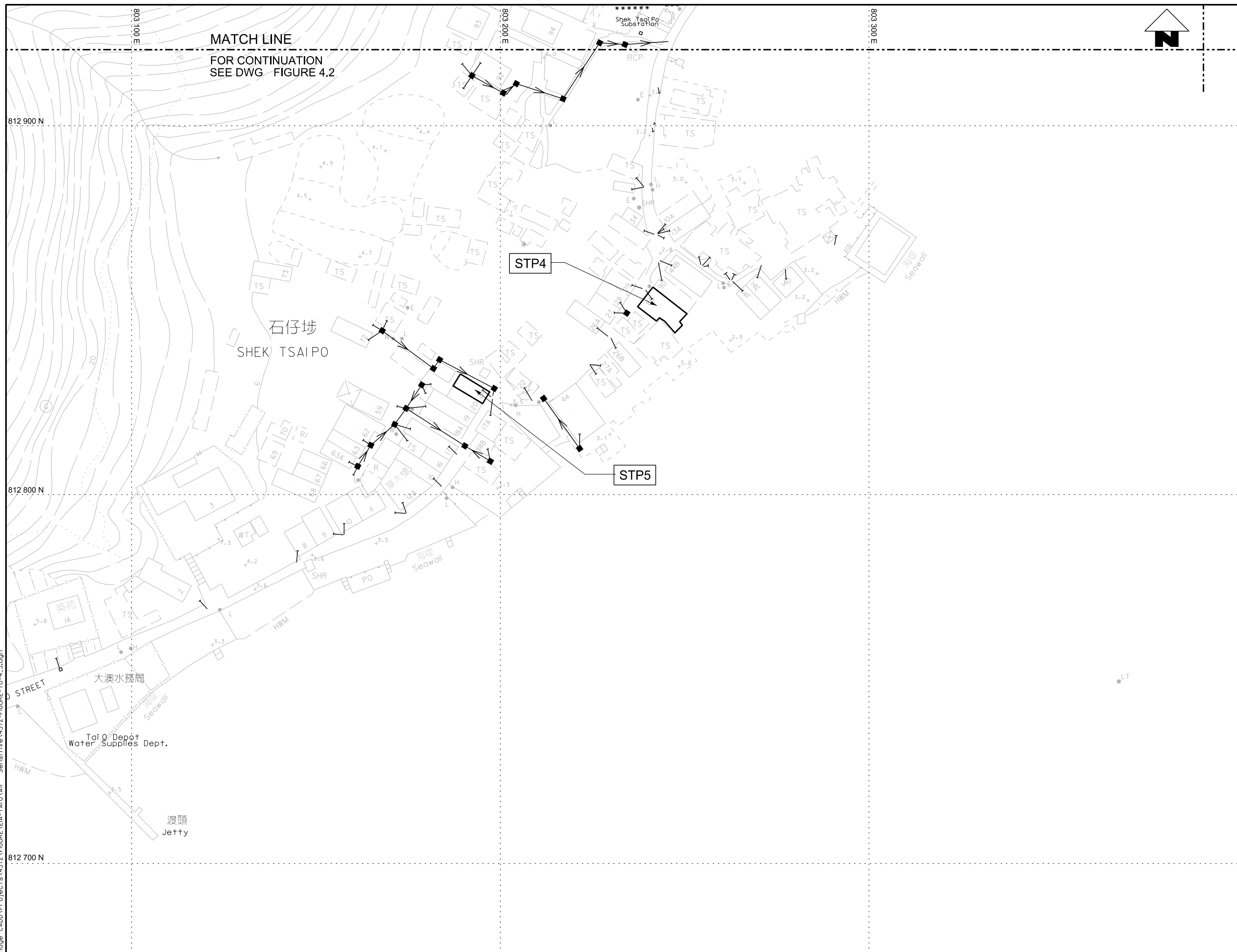

KEY PLAN SCALE : N.T.S.

- LEGEND AND ABBREVIATION:
- Proposed Sewer
 - Proposed Manhole
 - Proposed Rising Main
 - Proposed Tapping Pipe (subject to consultation with owners of houses with topographical problem)
 - Proposed Sewage Pumping Station
 - Label for Noise Sensitive Receiver
 - 300m Study Boundary

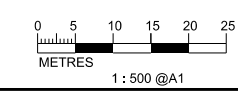

PRINTED BY: cheu8306 7/2/2014 4:48:43 PM
 FILENAME: F:\CHINA\A\image CAD\Project\154572\FIGURE\EA-TAI O\A1 - Sensitive\4572-FIGURE-TO-4-3.dgn

渠務署
DRAINAGE SERVICES DEPARTMENT

ATKINS

Agreement No. CE 15/2010 (DS)
 Upgrading of Cheung Chau and Tai O Sewerage Collection, Treatment and Disposal Facilities - Design and Construction
Outlying Islands Sewerage Stage 2 -
 Upgrading of Tai O Sewerage Collection, Treatment and Disposal Facilities

Title :	NOISE SENSITIVE RECEIVERS (Sheet 3 of 11)		
Date :	MAY 2015	Figure :	4.3