

ISO A1 594mm x 841mm
 Approved:
 Checked:
 Designer:
 Project Management Initials:
 26/11/2022
 PATH P:\Projects\60631936\DRAWING\REPORT\EA\EA_YLSEPP_794.dgn

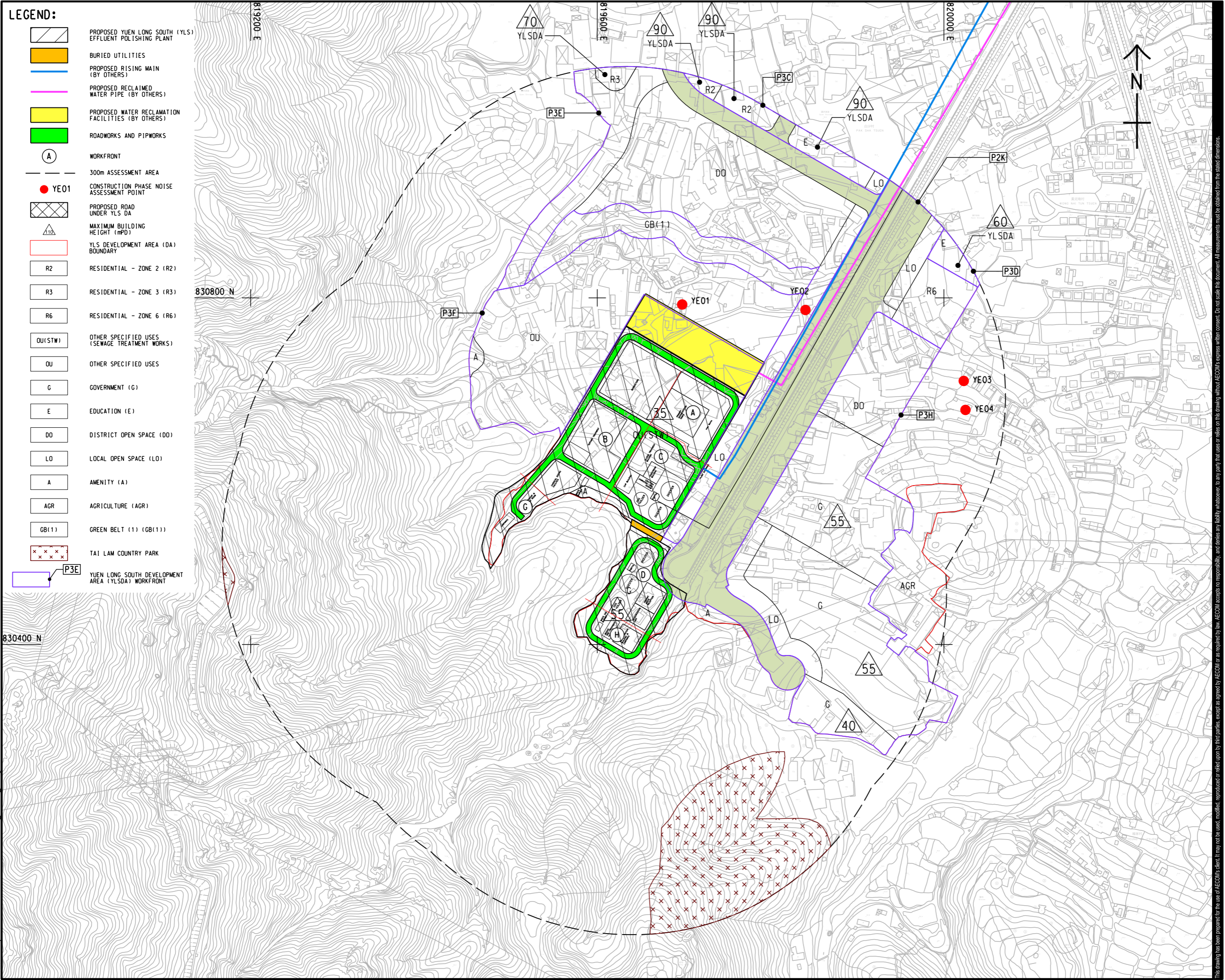

- LEGEND:**
- PROPOSED YUEN LONG SOUTH (YLS) EFFLUENT POLISHING PLANT
 - BURIED UTILITIES
 - PROPOSED RISING MAIN (BY OTHERS)
 - PROPOSED RECLAIMED WATER PIPE (BY OTHERS)
 - PROPOSED WATER RECLAMATION FACILITIES (BY OTHERS)
 - ROADWORKS AND PIPWORKS
 - WORKFRONT
 - 300m ASSESSMENT AREA
 - YE01 CONSTRUCTION PHASE NOISE ASSESSMENT POINT
 - PROPOSED ROAD UNDER YLS DA
 - MAXIMUM BUILDING HEIGHT (MPD)
 - YLS DEVELOPMENT AREA (DA) BOUNDARY
 - RESIDENTIAL - ZONE 2 (R2)
 - RESIDENTIAL - ZONE 3 (R3)
 - RESIDENTIAL - ZONE 6 (R6)
 - OTHER SPECIFIED USES (SEWAGE TREATMENT WORKS)
 - OTHER SPECIFIED USES
 - GOVERNMENT (G)
 - EDUCATION (E)
 - DISTRICT OPEN SPACE (DO)
 - LOCAL OPEN SPACE (LO)
 - AMENITY (A)
 - AGRICULTURE (AGR)
 - GREEN BELT (1) (GB(1))
 - TAI LAM COUNTRY PARK
 - YUEN LONG SOUTH DEVELOPMENT AREA (YLSDA) WORKFRONT



PROJECT
 HUNG SHUI KIU
 EFFLUENT POLISHING
 PLANT AND
 YUEN LONG SOUTH
 EFFLUENT POLISHING
 PLANT - INVESTIGATION

CLIENT
 渠務署
 Drainage Services Department

CONSULTANT
 AECOM Asla Company Ltd.
 www.aecom.com

SUB-CONSULTANTS

ISSUE/REVISION

I/R	DATE	DESCRIPTION	CHK.

STATUS

SCALE
 A1 1: 2000

DIMENSION UNIT
 METRES

KEY PLAN

PROJECT NO.
 60631936

CONTRACT NO.
 CE 6/2019 (DS)

SHEET TITLE
 LOCATIONS OF WORKFRONTS

SHEET NUMBER
 60631936/EIA_YLSEPP/794

This drawing has been prepared for the use of AECOM's client. It may not be used, modified, reproduced or relied upon by third parties, except as agreed by AECOM or as required by law. AECOM accepts no responsibility, and denies any liability whatsoever, to any party that uses or relies on this drawing without AECOM's express written consent. Do not scale this document. All measurements must be obtained from the stated dimensions.