

***Appendix 7.3 -
Photographic Records of Site Walkover***



PHOTO 4425: OPEN CAR PARK (STT1521TW)
(DATE TAKEN: 16 NOVEMBER 2021)



PHOTO 4431: VACANT LAND
(DATE TAKEN: 16 NOVEMBER 2021)



PHOTO 4434: HOI SHING GARDEN
(DATE TAKEN: 16 NOVEMBER 2021)

NOTE:

1. THIS DRAWING TO BE READ IN CONJUNCTION WITH
DRAWING NO. 60607462/R27/PR1 TO PR14.

LEGEND:

- SITE BOUNDARY
- LAND LOTS
- HOTSPOT
- PROPOSED EXCAVATION AREA
- LOCATION AND DIRECTION OF PHOTOGRAPH TAKEN / PHOTO ID



PROJECT

WIDENING OF TSUEN WAN ROAD
AND THE ASSOCIATED JUNCTION
IMPROVEMENT WORKS

CLIENT



CONSULTANT

AECOM Asia Company Ltd.
www.aecom.com

SUB-CONSULTANTS

ISSUE/REVISION

NO.	DATE	DESCRIPTION	CHK.

STATUS

SCALE

A3 1:2000

DIMENSION UNIT

METRES

KEY PLAN

A3 1:100000

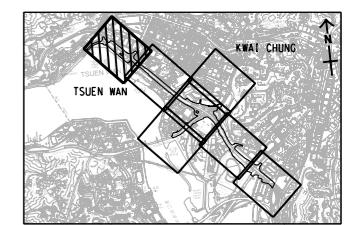

PROJECT NO.

60607462

AGREEMENT NO.

CE61/2018(HY)

SHEET TITLE

PHOTOGRAPHIC RECORDS OF
SITE WALKOVER

SHEET NUMBER

60607462/R27/PR1

SHEET 1 OF 14

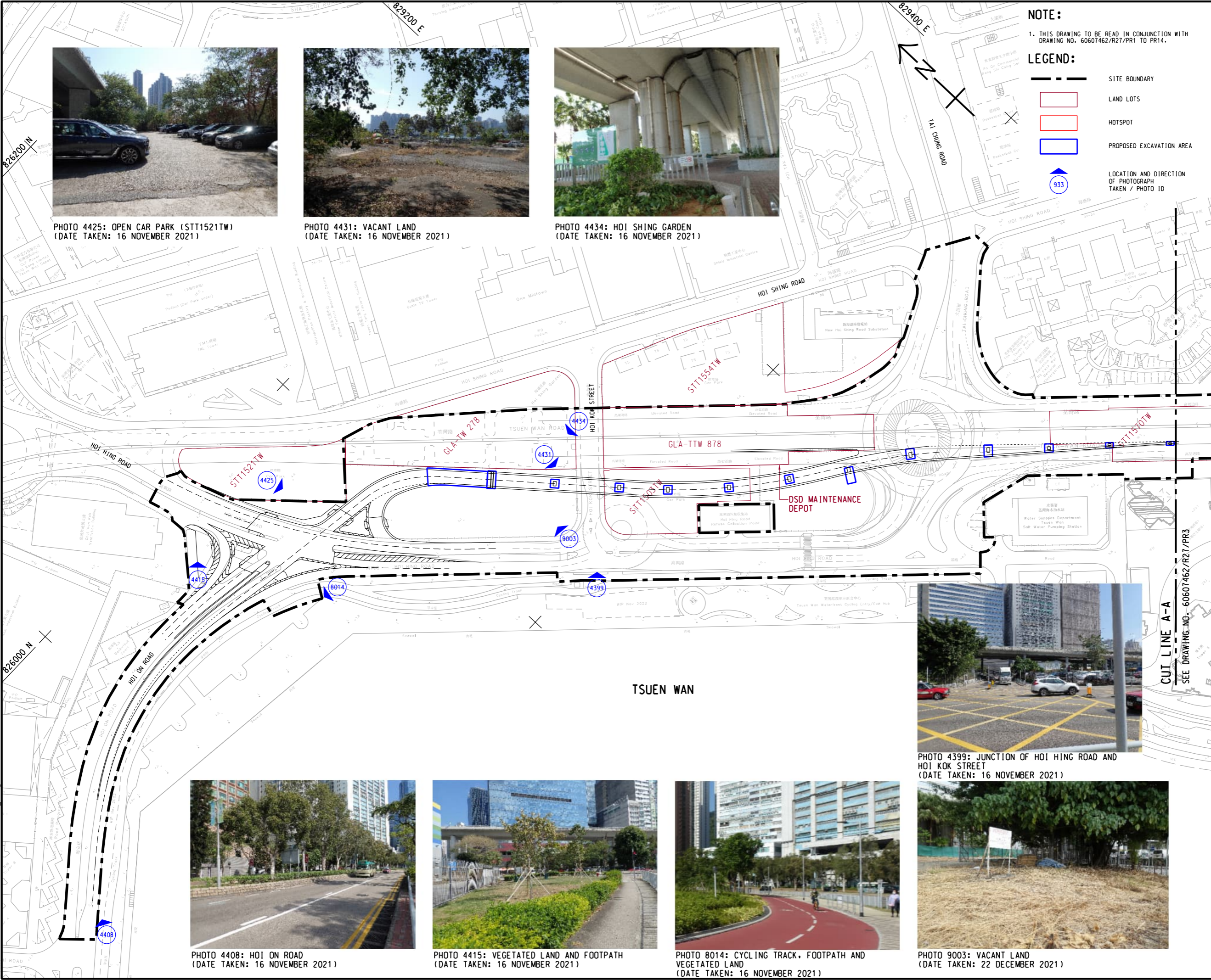

PHOTO 4399: JUNCTION OF HOI HING ROAD AND
HOI KOK STREET
(DATE TAKEN: 16 NOVEMBER 2021)



PHOTO 4408: HOI ON ROAD
(DATE TAKEN: 16 NOVEMBER 2021)



PHOTO 4415: VEGETATED LAND AND FOOTPATH
(DATE TAKEN: 16 NOVEMBER 2021)



PHOTO 8014: CYCLING TRACK, FOOTPATH AND
VEGETATED LAND
(DATE TAKEN: 16 NOVEMBER 2021)



PHOTO 9003: VACANT LAND
(DATE TAKEN: 22 DECEMBER 2021)

CUT LINE A-A
SEE DRAWING NO. 60607462/R27/PR3

This drawing has been prepared for the use of AECOM's client. It may not be used, modified, reproduced or relied upon by third parties, except as agreed by AECOM or as required by law. AECOM accepts no responsibility, and denies any liability whatsoever, for any part, in whole or in part, that uses or relies on this drawing without AECOM's express written consent. All measurements must be obtained from the stated dimensions.

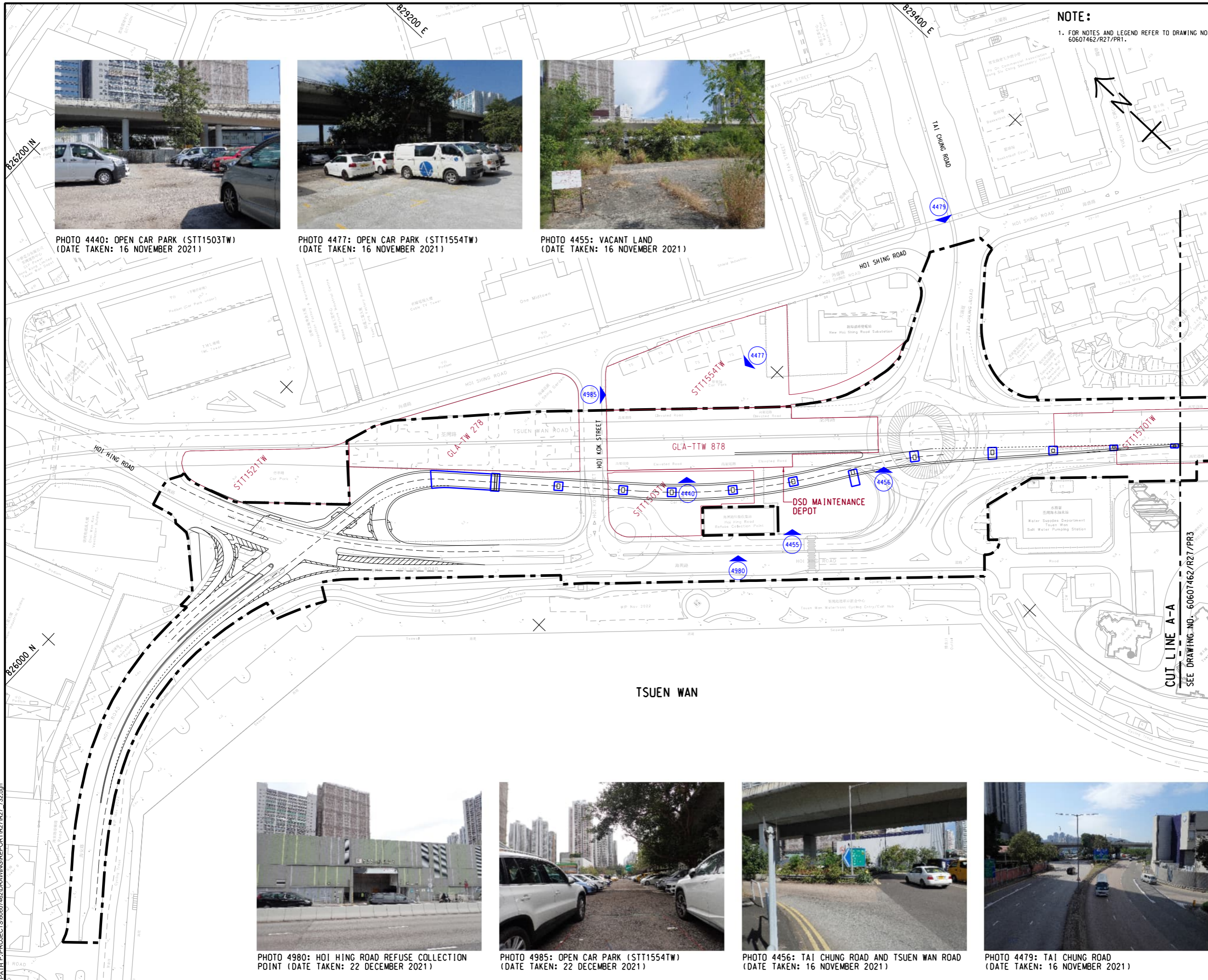

NOTE:
 1. FOR NOTES AND LEGEND REFER TO DRAWING NO. 60607462/R27/PR1.



PHOTO 4440: OPEN CAR PARK (STT1503TW)
 (DATE TAKEN: 16 NOVEMBER 2021)



PHOTO 4477: OPEN CAR PARK (STT1554TW)
 (DATE TAKEN: 16 NOVEMBER 2021)



PHOTO 4455: VACANT LAND
 (DATE TAKEN: 16 NOVEMBER 2021)



PHOTO 4980: HOI HING ROAD REFUSE COLLECTION POINT
 (DATE TAKEN: 22 DECEMBER 2021)



PHOTO 4985: OPEN CAR PARK (STT1554TW)
 (DATE TAKEN: 22 DECEMBER 2021)



PHOTO 4456: TAI CHUNG ROAD AND TSUEN WAN ROAD
 (DATE TAKEN: 16 NOVEMBER 2021)



PHOTO 4479: TAI CHUNG ROAD
 (DATE TAKEN: 16 NOVEMBER 2021)

AECOM

PROJECT
 項目
 WIDENING OF TSUEN WAN ROAD AND THE ASSOCIATED JUNCTION IMPROVEMENT WORKS

CLIENT
 業主
 路政署
 HIGHWAYS DEPARTMENT

CONSULTANT
 顧問公司
 AECOM Asia Company Ltd.
 www.aecom.com

SUB-CONSULTANTS
 分判工程師/公司

ISSUE/REVISION

NO.	DATE	DESCRIPTION	CHK.

STATUS
 狀況

SCALE
 比例
 A3 1 : 2000

DIMENSION UNIT
 單位
 METRES

KEY PLAN
 索引圖
 A3 1 : 100000

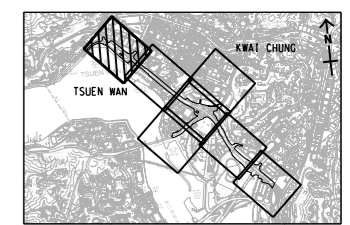

PROJECT NO.
 項目編號
 60607462

AGREEMENT NO.
 協議編號
 CE61/2018(HY)

SHEET TITLE
 圖紙名稱
 PHOTOGRAPHIC RECORDS OF SITE WALKOVER

SHEET NUMBER
 圖紙編號
 60607462/R27/PR2

SHEET 2 OF 14

This drawing has been prepared for the use of AECOM's client. It may not be used, modified, reproduced or relied upon by third parties, except as agreed by AECOM or as required by law. AECOM accepts no responsibility, and disclaims any liability whatsoever, for any part, in whole or in part, that uses or relies on this drawing without AECOM's express written consent. All measurements must be obtained from the stated dimensions.

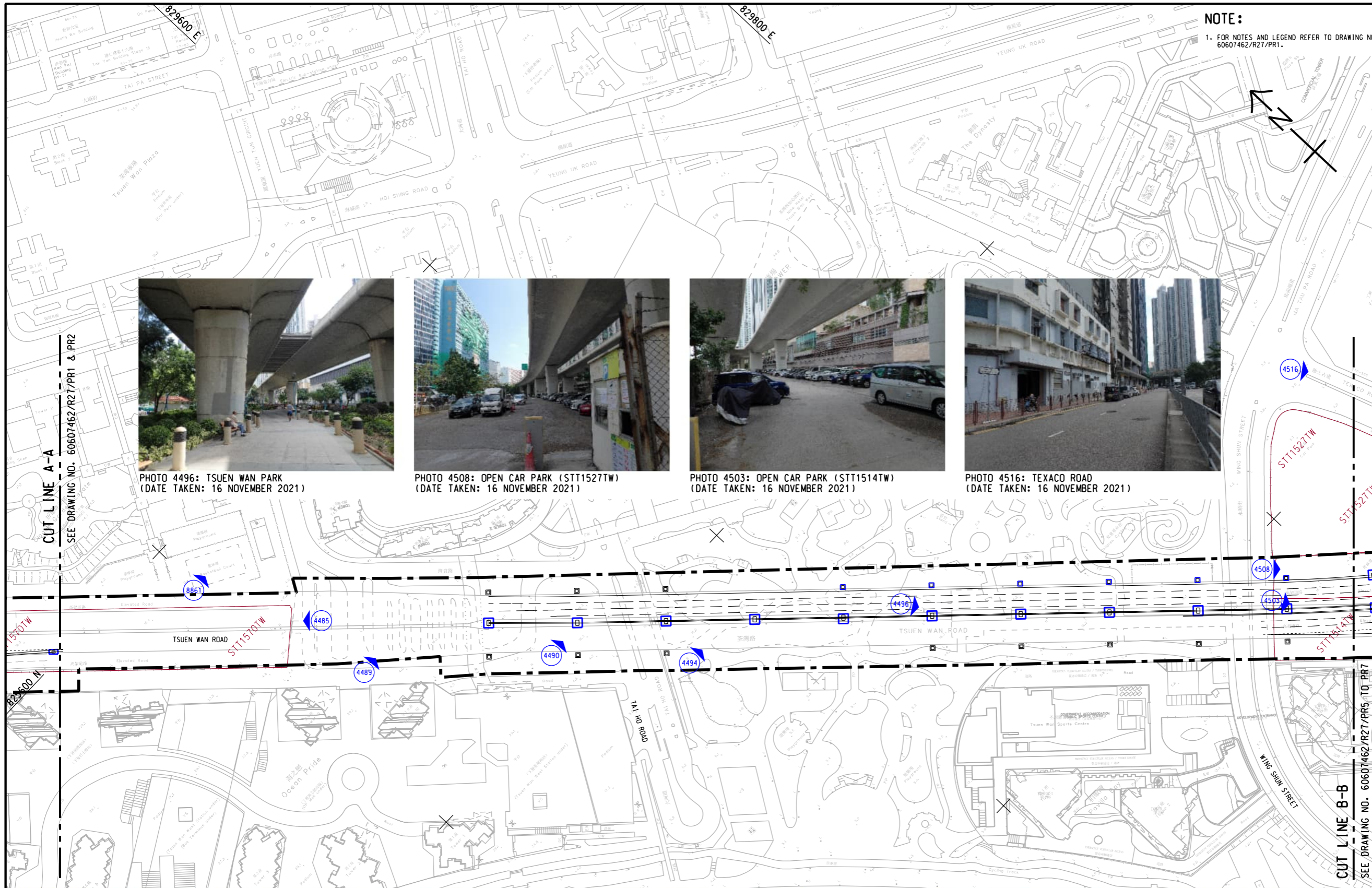

NOTE:
 1. FOR NOTES AND LEGEND REFER TO DRAWING NO. 60607462/R27/PR1.



PHOTO 4496: TSUEN WAN PARK
 (DATE TAKEN: 16 NOVEMBER 2021)



PHOTO 4508: OPEN CAR PARK (STT1527TW)
 (DATE TAKEN: 16 NOVEMBER 2021)



PHOTO 4503: OPEN CAR PARK (STT1514TW)
 (DATE TAKEN: 16 NOVEMBER 2021)



PHOTO 4516: TEXACO ROAD
 (DATE TAKEN: 16 NOVEMBER 2021)

CUT LINE A-A
 SEE DRAWING NO. 60607462/R27/PR1 & PR2

CUT LINE B-B
 SEE DRAWING NO. 60607462/R27/PR5 TO PR7

PROJECT
 項目
 WIDENING OF TSUEN WAN ROAD
 AND THE ASSOCIATED JUNCTION
 IMPROVEMENT WORKS

CLIENT
 業主
 路政署
 HIGHWAYS DEPARTMENT

CONSULTANT
 顧問公司
 AECOM Asia Company Ltd.
 www.aecom.com

SUB-CONSULTANTS
 分判工程師/公司

ISSUE/REVISION

NO.	DATE	DESCRIPTION	CHK.

STATUS
 狀況

SCALE
 比例
 A3 1 : 2000

DIMENSION UNIT
 尺寸單位
 METRES

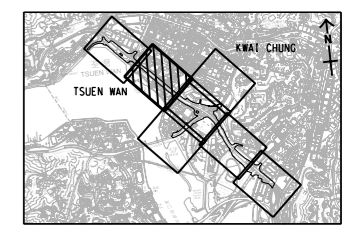

PROJECT NO.
 項目編號
 60607462

AGREEMENT NO.
 協議編號
 CE61/2018(HY)

SHEET TITLE
 圖名
 PHOTOGRAPHIC RECORDS OF
 SITE WALKOVER

SHEET NUMBER
 圖號
 60607462/R27/PR3



PHOTO 8861: BASKETBALL COURT
 (DATE TAKEN: 16 NOVEMBER 2021)



PHOTO 4485: OPEN CAR PARK (STT1570TW)
 (DATE TAKEN: 16 NOVEMBER 2021)



PHOTO 4489: MINIBUS TERMINUS
 (DATE TAKEN: 16 NOVEMBER 2021)



PHOTO 4490: VACANT LAND
 (DATE TAKEN: 16 NOVEMBER 2021)



PHOTO 4494: TSUEN WAN PARK
 (DATE TAKEN: 16 NOVEMBER 2021)

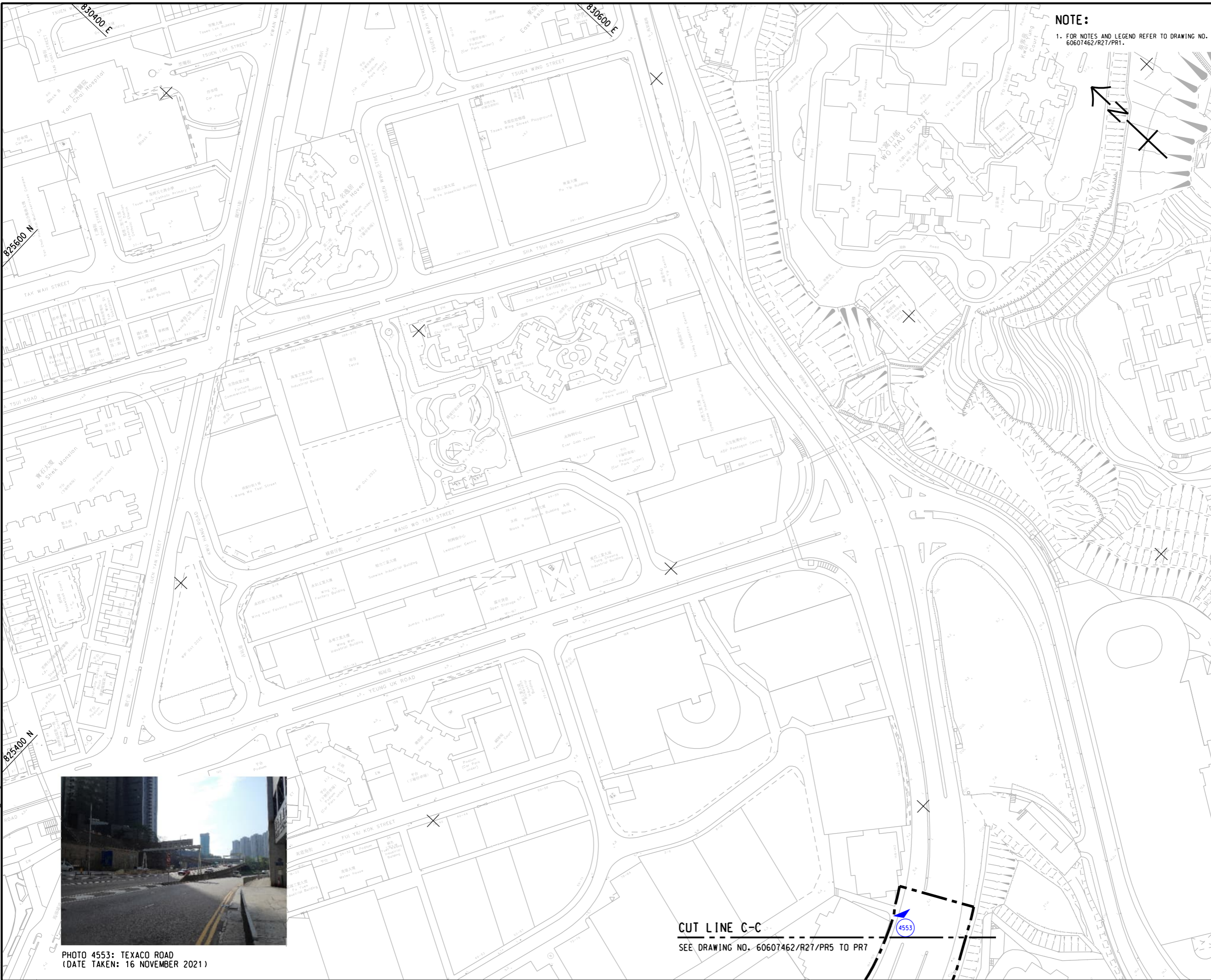

PHOTO 4553: TEXACO ROAD
(DATE TAKEN: 16 NOVEMBER 2021)

NOTE:
1. FOR NOTES AND LEGEND REFER TO DRAWING NO. 60607462/R27/PR1.

AECOM

PROJECT
項目
WIDENING OF TSUEN WAN ROAD
AND THE ASSOCIATED JUNCTION
IMPROVEMENT WORKS

CLIENT
業主
 路政署
HIGHWAYS DEPARTMENT

CONSULTANT
顧問公司
AECOM Asia Company Ltd.
www.aecom.com

SUB-CONSULTANTS
分判工程師/公司

ISSUE/REVISION
修訂

IR	DATE	DESCRIPTION	CHK.

STATUS
狀況

SCALE
比例
A3 1 : 2000

DIMENSION UNIT
單位
METRES

KEY PLAN
索引圖
A3 1 : 100000

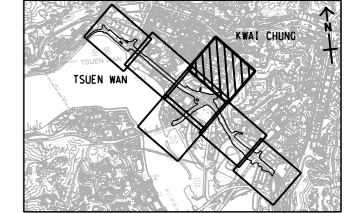

PROJECT NO.
項目編號
60607462

AGREEMENT NO.
協議編號
CE61/2018(HY)

SHEET TITLE
圖紙名稱
PHOTOGRAPHIC RECORDS OF
SITE WALKOVER

SHEET NUMBER
圖紙編號
60607462/R27/PR4

This drawing has been prepared for the use of AECOM's client. It may not be used, modified, reproduced or relied upon by third parties, except as agreed by AECOM or as required by law. AECOM accepts no responsibility, and denies any liability whatsoever, for any part, in whole or in part, that is used or relied upon in this drawing without AECOM's express written consent. All measurements must be obtained from the stated dimensions.

ISO A1 594mm x 841mm
 Approved:
 Checked:
 Designer:
 Project Management Initials:
 04/2023
 WANGDF
 60607462/R27/PR5.dgn

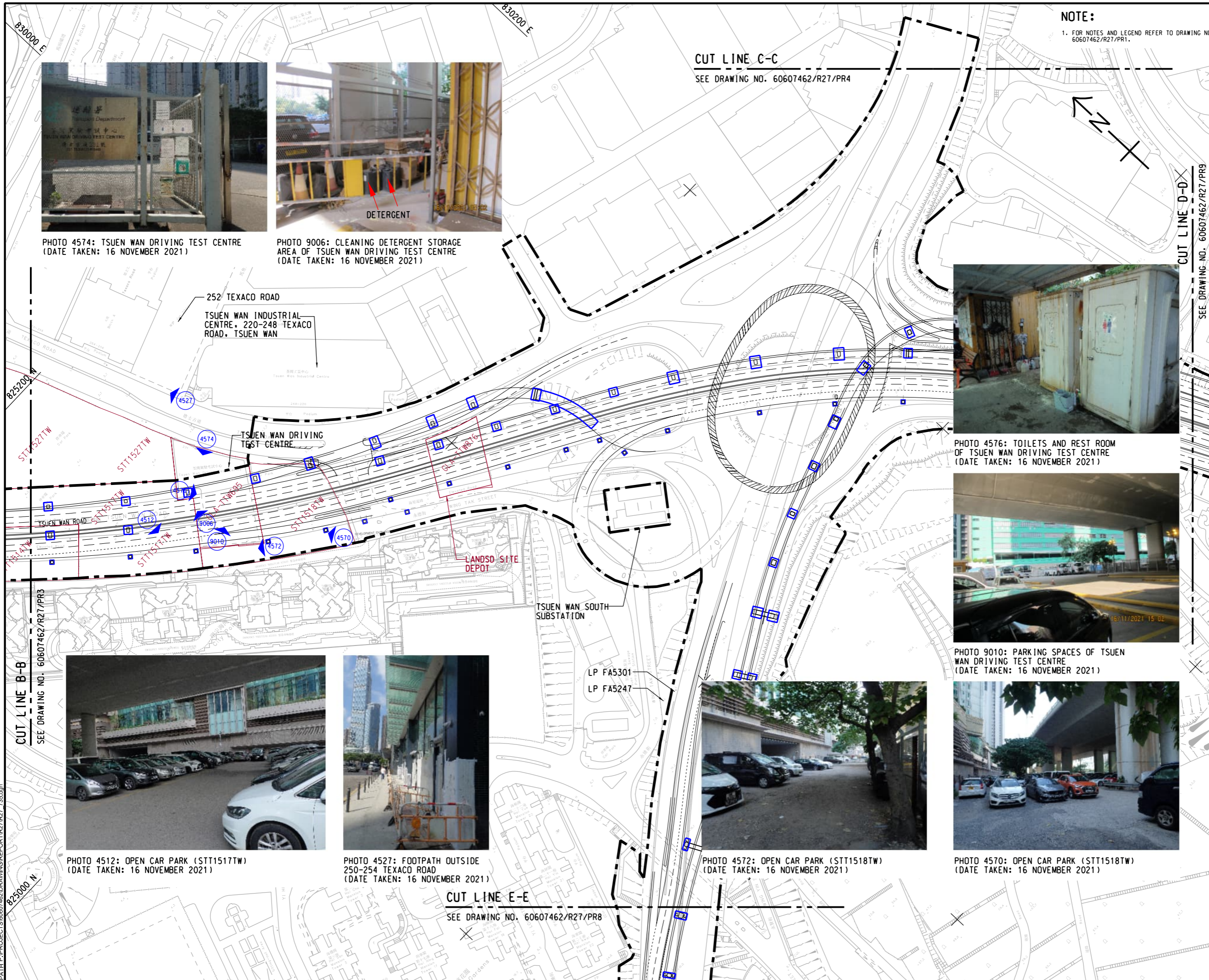

NOTE:
 1. FOR NOTES AND LEGEND REFER TO DRAWING NO. 60607462/R27/PR1.

CUT LINE C-C
 SEE DRAWING NO. 60607462/R27/PR4

CUT LINE D-D
 SEE DRAWING NO. 60607462/R27/PR9

CUT LINE E-E
 SEE DRAWING NO. 60607462/R27/PR8

CUT LINE B-B
 SEE DRAWING NO. 60607462/R27/PR3



PHOTO 4574: TSUEN WAN DRIVING TEST CENTRE (DATE TAKEN: 16 NOVEMBER 2021)



PHOTO 9006: CLEANING DETERGENT STORAGE AREA OF TSUEN WAN DRIVING TEST CENTRE (DATE TAKEN: 16 NOVEMBER 2021)

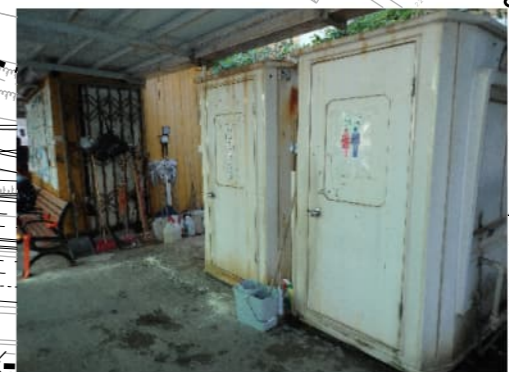

PHOTO 4576: TOILETS AND REST ROOM OF TSUEN WAN DRIVING TEST CENTRE (DATE TAKEN: 16 NOVEMBER 2021)



PHOTO 9010: PARKING SPACES OF TSUEN WAN DRIVING TEST CENTRE (DATE TAKEN: 16 NOVEMBER 2021)



PHOTO 4512: OPEN CAR PARK (STT1517TW) (DATE TAKEN: 16 NOVEMBER 2021)



PHOTO 4527: FOOTPATH OUTSIDE 250-254 TEXACO ROAD (DATE TAKEN: 16 NOVEMBER 2021)



PHOTO 4572: OPEN CAR PARK (STT1518TW) (DATE TAKEN: 16 NOVEMBER 2021)



PHOTO 4570: OPEN CAR PARK (STT1518TW) (DATE TAKEN: 16 NOVEMBER 2021)



PROJECT
 WIDENING OF TSUEN WAN ROAD AND THE ASSOCIATED JUNCTION IMPROVEMENT WORKS

CLIENT
 路政署
 HIGHWAYS DEPARTMENT

CONSULTANT
 AECOM Asia Company Ltd.
 www.aecom.com

SUB-CONSULTANTS
 分列工程師公司

ISSUE/REVISION

NO.	DATE	DESCRIPTION	CHK.

STATUS
 1/1

SCALE
 A3 1:2000

DIMENSION UNIT
 METRES

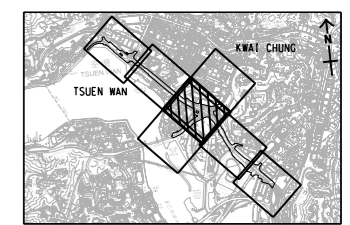

PROJECT NO.
 60607462

AGREEMENT NO.
 CE61/2018(HY)

SHEET TITLE
 PHOTOGRAPHIC RECORDS OF SITE WALKOVER

SHEET NUMBER
 60607462/R27/PR5

This drawing has been prepared for the use of AECOM's client. It may not be used, modified, reproduced or relied upon by third parties, except as agreed by AECOM or as required by law. AECOM accepts no responsibility, and denies any liability whatsoever, for any part, that uses or relies on this drawing without AECOM's express written consent. All measurements must be obtained from the stated dimensions.

ISO A1 594mm x 841mm
Approved:
Checked:
Designer:
Project Management Initials:
6/4/2023
WANGDF
60607462/R27/PR6.dgn

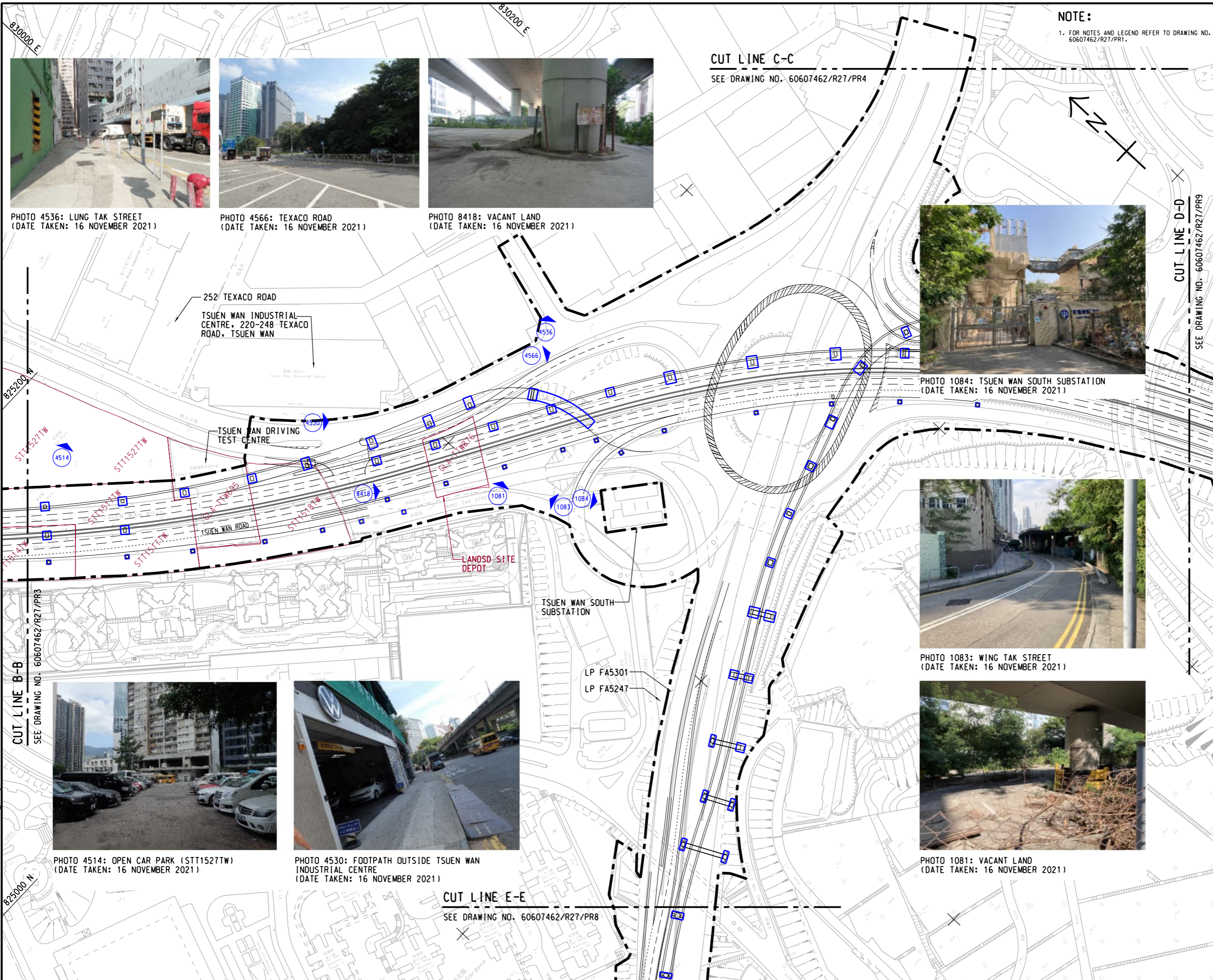

NOTE:
1. FOR NOTES AND LEGEND REFER TO DRAWING NO. 60607462/R27/PR1.



PHOTO 4536: LUNG TAK STREET
(DATE TAKEN: 16 NOVEMBER 2021)

PHOTO 4566: TEXACO ROAD
(DATE TAKEN: 16 NOVEMBER 2021)

PHOTO 8418: VACANT LAND
(DATE TAKEN: 16 NOVEMBER 2021)



PHOTO 1084: TSUEN WAN SOUTH SUBSTATION
(DATE TAKEN: 16 NOVEMBER 2021)



PHOTO 1083: WING TAK STREET
(DATE TAKEN: 16 NOVEMBER 2021)



PHOTO 1081: VACANT LAND
(DATE TAKEN: 16 NOVEMBER 2021)



PHOTO 4514: OPEN CAR PARK (STT1527TW)
(DATE TAKEN: 16 NOVEMBER 2021)



PHOTO 4530: FOOTPATH OUTSIDE TSUEN WAN INDUSTRIAL CENTRE
(DATE TAKEN: 16 NOVEMBER 2021)

AECOM

PROJECT
項目

WIDENING OF TSUEN WAN ROAD AND THE ASSOCIATED JUNCTION IMPROVEMENT WORKS

CLIENT
業主

**路政署
HIGHWAYS DEPARTMENT**

CONSULTANT
顧問公司

AECOM Asia Company Ltd.
www.aecom.com

SUB-CONSULTANTS
分判工程師/公司

ISSUE/REVISION

NO.	DATE	DESCRIPTION	CHK.

STATUS

SCALE
比例

A3 1 : 2000

DIMENSION UNIT
尺寸單位

METRES

A3 1 : 100000

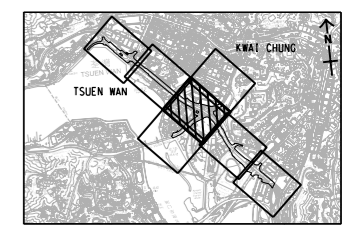

PROJECT NO.
項目編號

60607462

AGREEMENT NO.
協議編號

CE61/2018(HY)

SHEET TITLE
圖名

PHOTOGRAPHIC RECORDS OF SITE WALKOVER

SHEET NUMBER
圖號

60607462/R27/PR6

This drawing has been prepared for the use of AECOM's client. It may not be used, modified, reproduced or relied upon by third parties, except as agreed by AECOM or as required by law. AECOM accepts no responsibility, and disclaims any liability whatsoever, for any part that is used or relied on in this drawing without AECOM's express written consent. Do not scale this document. All measurements must be obtained from the stated dimensions.

ISO A1 594mm x 841mm
Approved:
Checked:
Designer:
Project Management Initials:
6/4/2023
WANGDF
60607462/R27/PR7
737.dgn

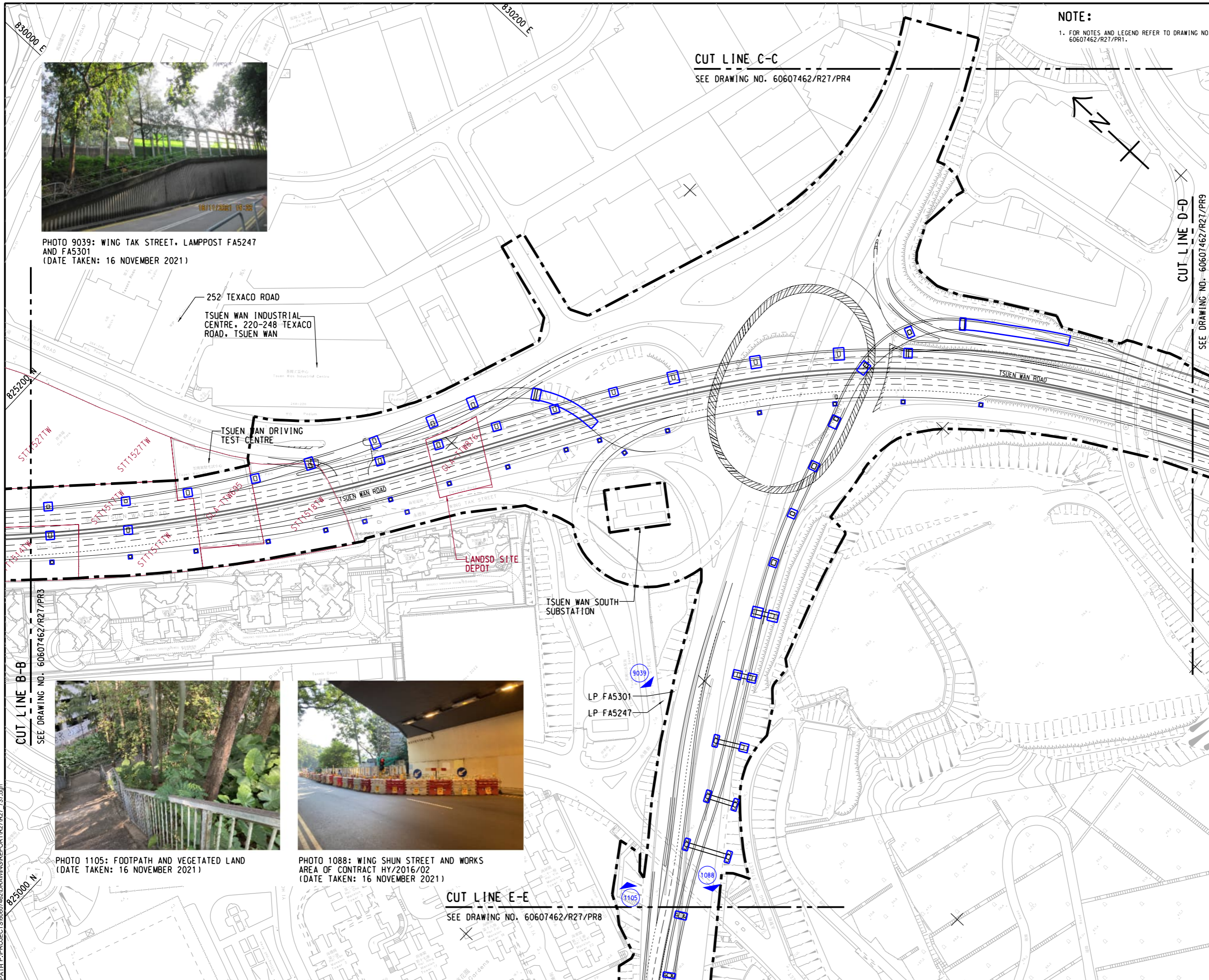

NOTE:
1. FOR NOTES AND LEGEND REFER TO DRAWING NO. 60607462/R27/PR1.

CUT LINE C-C
SEE DRAWING NO. 60607462/R27/PR4

CUT LINE D-D
SEE DRAWING NO. 60607462/R27/PR9

CUT LINE E-E
SEE DRAWING NO. 60607462/R27/PR8

CUT LINE B-B
SEE DRAWING NO. 60607462/R27/PR3



PHOTO 9039: WING TAK STREET, LAMPOST FA5247 AND FA5301 (DATE TAKEN: 16 NOVEMBER 2021)



PHOTO 1105: FOOTPATH AND VEGETATED LAND (DATE TAKEN: 16 NOVEMBER 2021)



PHOTO 1088: WING SHUN STREET AND WORKS AREA OF CONTRACT HY/2016/02 (DATE TAKEN: 16 NOVEMBER 2021)



PROJECT
WIDENING OF TSUEN WAN ROAD AND THE ASSOCIATED JUNCTION IMPROVEMENT WORKS

CLIENT
路政署
HIGHWAYS DEPARTMENT

CONSULTANT
AECOM Asia Company Ltd.
www.aecom.com

SUB-CONSULTANTS
分列工程師內公司

ISSUE/REVISION

IR	DATE	DESCRIPTION	CHK.

STATUS

SCALE **DIMENSION UNIT**

A3 1 : 2000 METRES
A3 1 : 100000

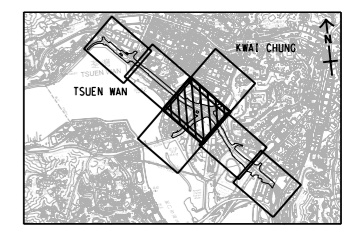

PROJECT NO. **AGREEMENT NO.**
60607462 CE61/2018(HY)

SHEET TITLE
PHOTOGRAPHIC RECORDS OF SITE WALKOVER

SHEET NUMBER
60607462/R27/PR7

This drawing has been prepared for the use of AECOM's client. It may not be used, modified, reproduced or relied upon by third parties, except as agreed by AECOM or as required by law. AECOM accepts no responsibility, and denies any liability whatsoever, for any part, that less or more, that is used or relied on in this drawing without AECOM's express written consent. All measurements must be obtained from the stated dimensions.



PHOTO 1103: NOISE BARRIER OF TSING TSUEN ROAD
(DATE TAKEN: 16 NOVEMBER 2021)



PHOTO 1100: WORKS SITE OF CONTRACT NO.
HY/2016/02 AND TSING TSUEN ROAD
(DATE TAKEN: 16 NOVEMBER 2021)



PHOTO 1101: TSING TSUEN ROAD
(DATE TAKEN: 16 NOVEMBER 2021)



PHOTO 9043: WORKS SITE OF CONTRACT NO.
HY/2016/02 AND TSING TSUEN ROAD
(DATE TAKEN: 16 NOVEMBER 2021)



PHOTO 1091: WORKS SITE OF CONTRACT NO.
03/HY/2019 AND SLOPE
(DATE TAKEN: 16 NOVEMBER 2021)

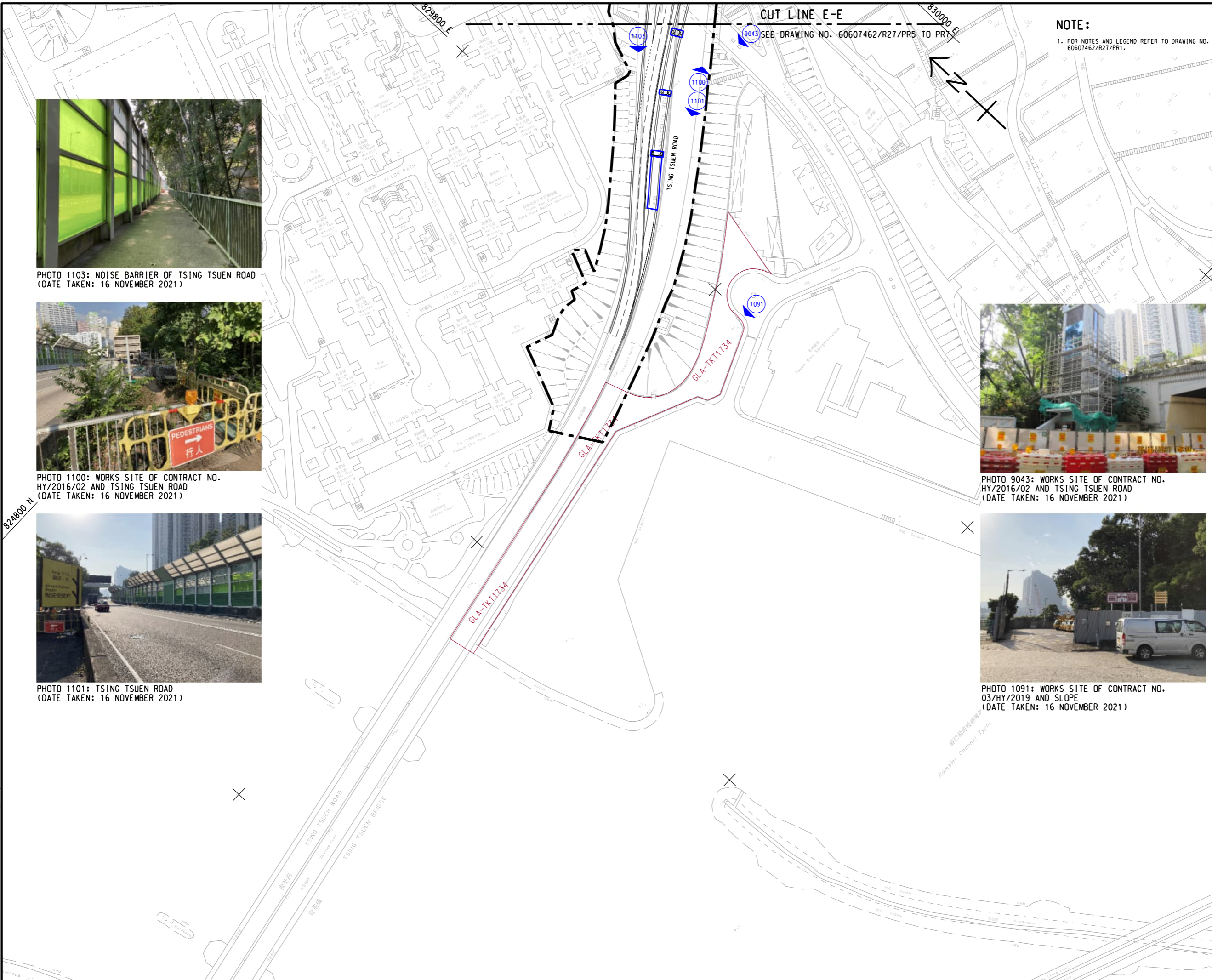

NOTE:
1. FOR NOTES AND LEGEND REFER TO DRAWING NO. 60607462/R27/PR1.



PROJECT
項目
WIDENING OF TSUEN WAN ROAD
AND THE ASSOCIATED JUNCTION
IMPROVEMENT WORKS

CLIENT
業主
 路政署
HIGHWAYS DEPARTMENT

CONSULTANT
顧問公司
AECOM Asia Company Ltd.
www.aecom.com

SUB-CONSULTANTS
分判工程師/公司

ISSUE/REVISION
修訂

I/R	DATE	DESCRIPTION	CHK.

STATUS
狀況

SCALE
比例
A3 1:2000

DIMENSION UNIT
尺寸單位
METRES

KEY PLAN
索引圖
A3 1:100000

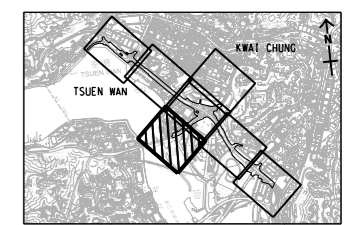

PROJECT NO.
項目編號
60607462

AGREEMENT NO.
協議編號
CE61/2018(HY)

SHEET TITLE
圖紙名稱
PHOTOGRAPHIC RECORDS OF
SITE WALKOVER

SHEET NUMBER
圖紙編號
60607462/R27/PR8

This drawing has been prepared for the use of AECOM's client. It may not be used, modified, reproduced or relied upon by third parties, except as agreed by AECOM or as required by law. AECOM accepts no responsibility, and denies any liability whatsoever, for any part, that is less or more than this drawing, without AECOM's express written consent. All measurements must be obtained from the stated dimensions.

CUT LINE D-D
SEE DRAWING NO. 60607462/R27/PR5 TO PR7



PHOTO 1115: SLOPE AND VEGETATION
(DATE TAKEN: 16 NOVEMBER 2021)



PHOTO 9100: OPEN CAR PARK (STT3750K&T)
(DATE TAKEN: 16 NOVEMBER 2021)



PHOTO 8538: OPEN CAR PARK (STT3750K&T)
(DATE TAKEN: 16 NOVEMBER 2021)



PHOTO 8556: OPEN CAR PARK (STT3750K&T)
(DATE TAKEN: 16 NOVEMBER 2021)

NOTE:

1. FOR NOTES AND LEGEND REFER TO DRAWING NO. 60607462/R27/PR1.



PROJECT

WIDENING OF TSUEN WAN ROAD
AND THE ASSOCIATED JUNCTION
IMPROVEMENT WORKS

CLIENT



CONSULTANT

AECOM Asia Company Ltd.
www.aecom.com

SUB-CONSULTANTS

ISSUE/REVISION

NO.	DATE	DESCRIPTION	CHK.

STATUS

SCALE

A3 1:2000

DIMENSION UNIT

METRES

KEY PLAN

A3 1:100000

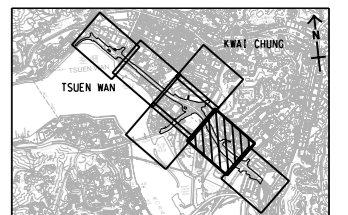

PROJECT NO.

60607462

AGREEMENT NO.

CE61/2018(HY)

SHEET TITLE

PHOTOGRAPHIC RECORDS OF
SITE WALKOVER

SHEET NUMBER

60607462/R27/PR9

SHEET 9 OF 14

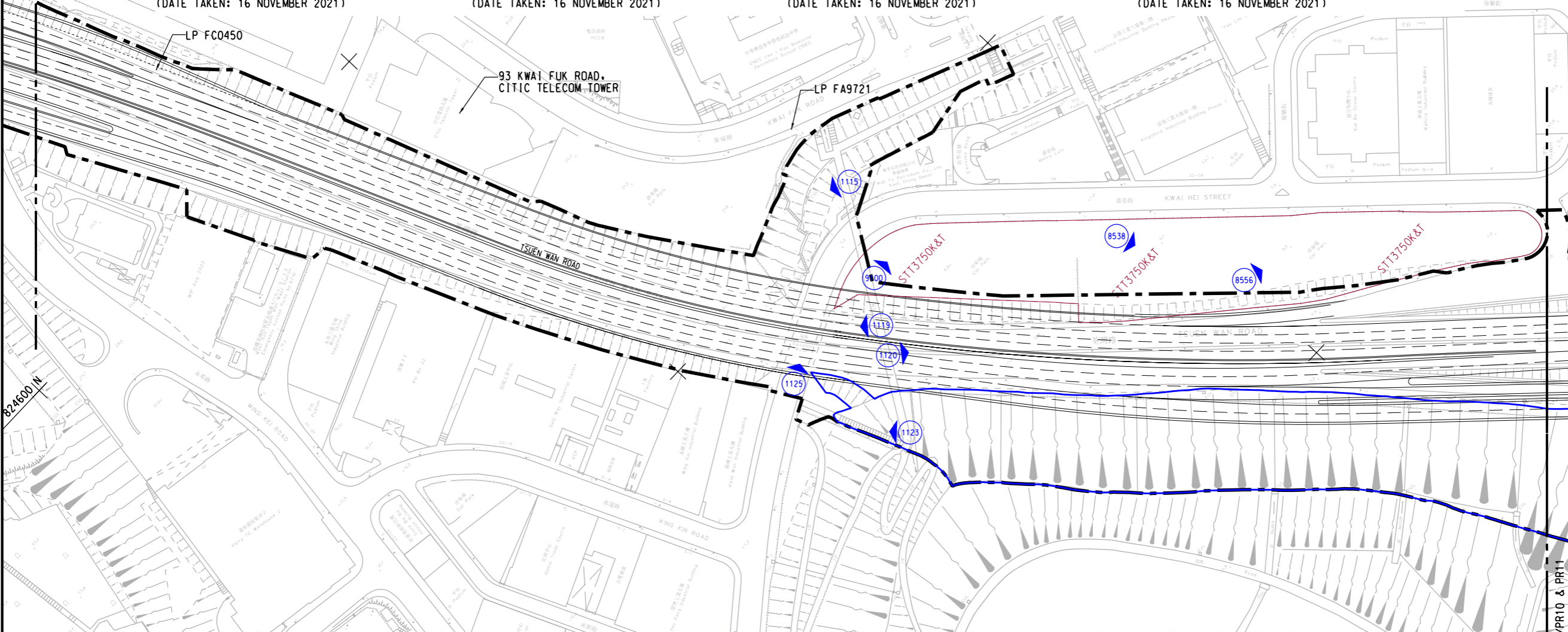

PHOTO 1119: TSUEN WAN ROAD
(DATE TAKEN: 16 NOVEMBER 2021)



PHOTO 1120: TSUEN WAN ROAD
(DATE TAKEN: 16 NOVEMBER 2021)



PHOTO 1123: STAIRS AND VEGETATION
(DATE TAKEN: 16 NOVEMBER 2021)



PHOTO 1125: KWAI HEI STREET
(DATE TAKEN: 16 NOVEMBER 2021)

CUT LINE F-F
SEE DRAWING NO. 60607462/R27/PR10 & PR11

This drawing has been prepared for the use of AECOM's client. It may not be used, modified, reproduced or relied upon by third parties, except as agreed by AECOM or as required by law. AECOM accepts no responsibility, and denies any liability whatsoever, to any party, that uses or relies on this drawing without AECOM's express written consent. All measurements must be obtained from the stated dimensions.

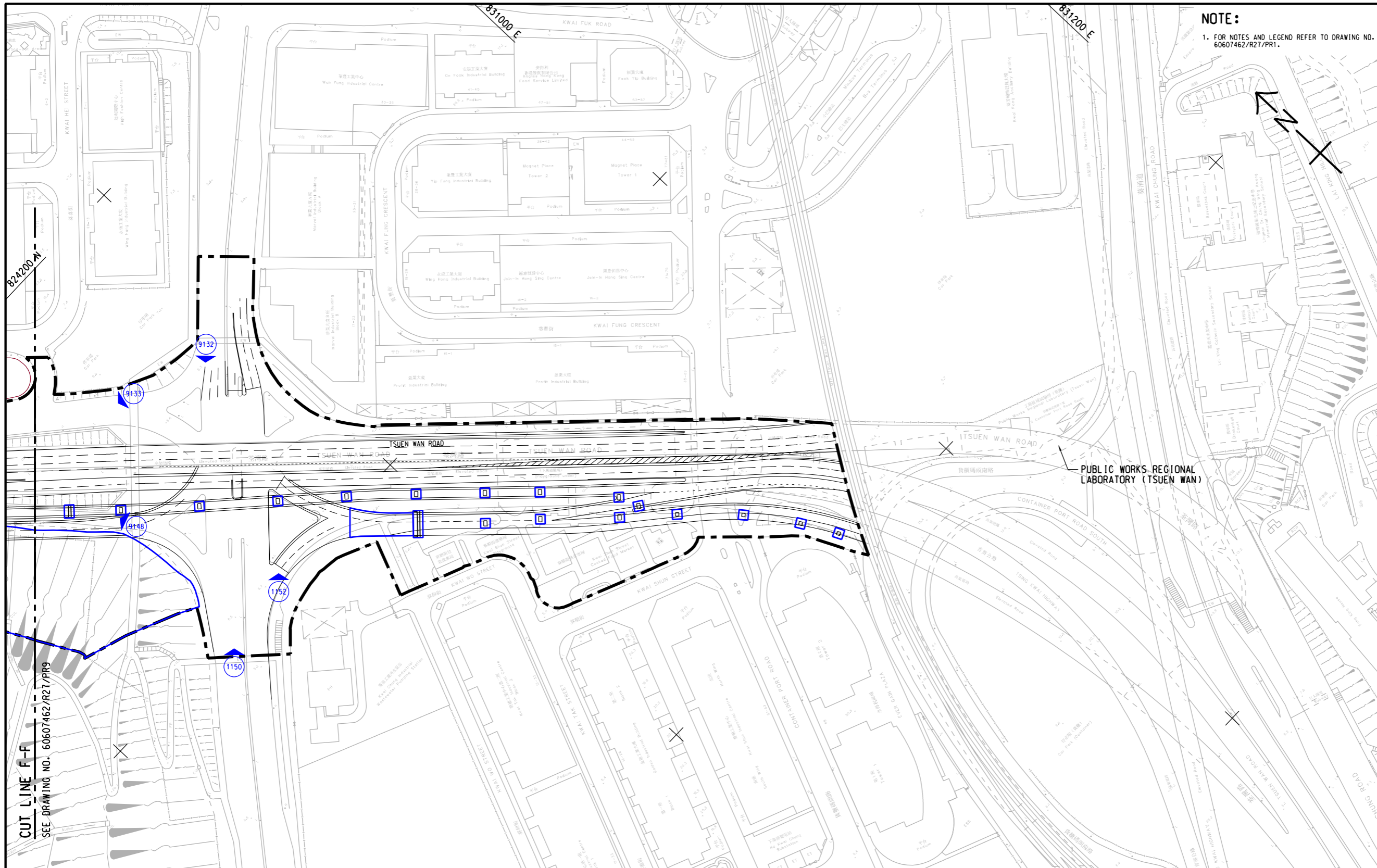

AECOM

PROJECT
 項目
WIDENING OF TSUEN WAN ROAD AND THE ASSOCIATED JUNCTION IMPROVEMENT WORKS

CLIENT
 客戶

HIGHWAYS DEPARTMENT

CONSULTANT
 顧問公司
 AECOM Asia Company Ltd.
 www.aecom.com

SUB-CONSULTANTS
 分判工程師/公司

ISSUE/REVISION
 修訂

NO.	DATE	DESCRIPTION	CHK.

STATUS
 狀況

SCALE
 比例

DIMENSION UNIT
 尺寸單位

A3 1 : 2000 METRES

KEY PLAN
 索引圖

A3 1 : 100000

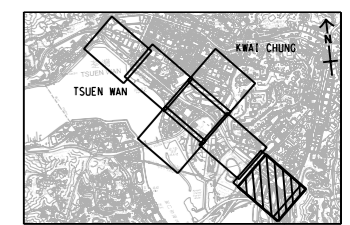

PROJECT NO.
 項目編號

60607462

AGREEMENT NO.
 協議編號

CE61/2018(HY)

SHEET TITLE
 圖紙名稱

PHOTOGRAPHIC RECORDS OF SITE WALKOVER

SHEET NUMBER
 圖紙編號

60607462/R27/PR10

SHEET 10 OF 14



PHOTO 9132: JUNCTION OF TSUEN WAN ROAD AND KWAI TSING ROAD (DATE TAKEN: 16 NOVEMBER 2021)



PHOTO 9133: TSUEN WAN ROAD (DATE TAKEN: 16 NOVEMBER 2021)



PHOTO 9148: TSUEN WAN ROAD AND SLOPE OF KWAI CHUNG PARK (DATE TAKEN: 16 NOVEMBER 2021)

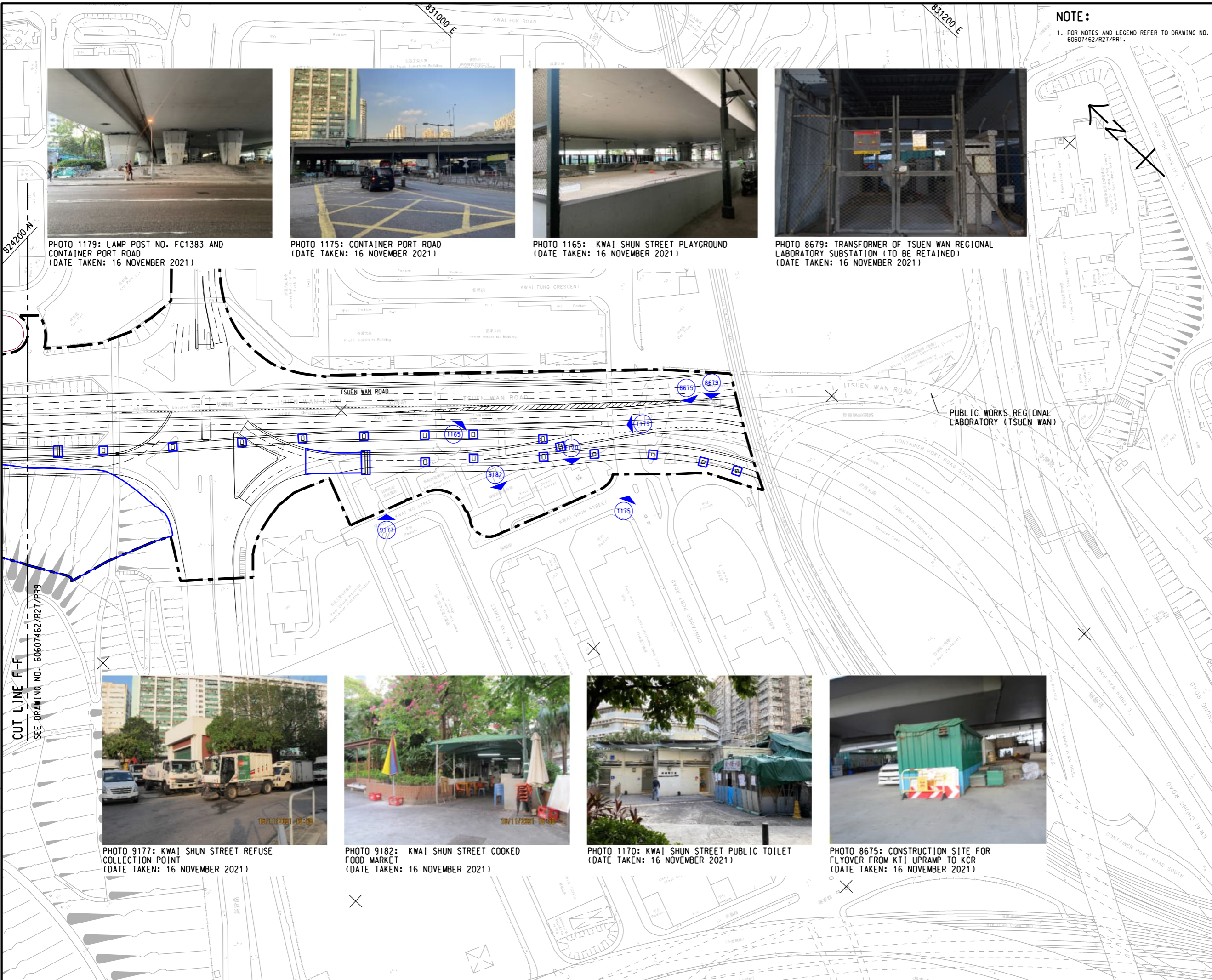

PHOTO 1150: JUNCTION OF TSUEN WAN ROAD AND KWAI TSING ROAD (DATE TAKEN: 16 NOVEMBER 2021)



PHOTO 1152: JUNCTION OF TSUEN WAN ROAD AND KWAI TSING ROAD (DATE TAKEN: 16 NOVEMBER 2021)

This drawing has been prepared for the use of AECOM's client. It may not be used, modified, reproduced or relied upon by third parties, except as agreed by AECOM or as required by law. AECOM accepts no responsibility, and does not warrant, for any part, that is not made or released on this drawing without AECOM's express written consent. All measurements must be obtained from the stated dimensions.



NOTE:
1. FOR NOTES AND LEGEND REFER TO DRAWING NO. 60607462/R27/PR1.



PHOTO 1179: LAMP POST NO. FC1383 AND CONTAINER PORT ROAD (DATE TAKEN: 16 NOVEMBER 2021)



PHOTO 1175: CONTAINER PORT ROAD (DATE TAKEN: 16 NOVEMBER 2021)



PHOTO 1165: KWAI SHUN STREET PLAYGROUND (DATE TAKEN: 16 NOVEMBER 2021)



PHOTO 8679: TRANSFORMER OF TSUEN WAN REGIONAL LABORATORY SUBSTATION (TO BE RETAINED) (DATE TAKEN: 16 NOVEMBER 2021)



PHOTO 9177: KWAI SHUN STREET REFUSE COLLECTION POINT (DATE TAKEN: 16 NOVEMBER 2021)



PHOTO 9182: KWAI SHUN STREET COOKED FOOD MARKET (DATE TAKEN: 16 NOVEMBER 2021)



PHOTO 1170: KWAI SHUN STREET PUBLIC TOILET (DATE TAKEN: 16 NOVEMBER 2021)



PHOTO 8675: CONSTRUCTION SITE FOR FLYOVER FROM KTI UPRAMP TO KCR (DATE TAKEN: 16 NOVEMBER 2021)



PROJECT
WIDENING OF TSUEN WAN ROAD AND THE ASSOCIATED JUNCTION IMPROVEMENT WORKS

CLIENT
路政署
HIGHWAYS DEPARTMENT

CONSULTANT
AECOM Asia Company Ltd.
www.aecom.com

SUB-CONSULTANTS
分列工程顧問公司

ISSUE/REVISION

NO.	DATE	DESCRIPTION	CHK.

STATUS
此圖

SCALE
比例
A3 1 : 2000

DIMENSION UNIT
單位
METRES

KEY PLAN
索引圖
A3 1 : 100000

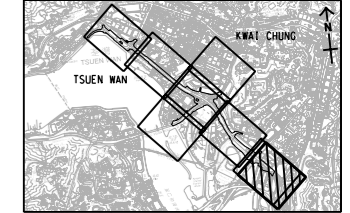

PROJECT NO.
60607462

AGREEMENT NO.
CE61/2018(HY)

SHEET TITLE
PHOTOGRAPHIC RECORDS OF SITE WALKOVER

SHEET NUMBER
60607462/EIA/PR11

This drawing has been prepared for the use of AECOM's client. It may not be used, modified, reproduced or relied upon by third parties, except as agreed by AECOM or as required by law. AECOM accepts no responsibility, and denies any liability whatsoever, to any party, that uses or relies on this drawing without AECOM's express written consent. All measurements must be obtained from the stated dimensions.



PHOTO 5068: FORKLIFT REFUELING AREA
(DATE TAKEN: 22 DECEMBER 2021)



PHOTO 5063: MOTOR OIL STORAGE
(DATE TAKEN: 22 DECEMBER 2021)



PHOTO 5053: WASTE BATTERY
(DATE TAKEN: 22 DECEMBER 2021)



PHOTO 5061: DIESEL OIL STORAGE
(DATE TAKEN: 22 DECEMBER 2021)

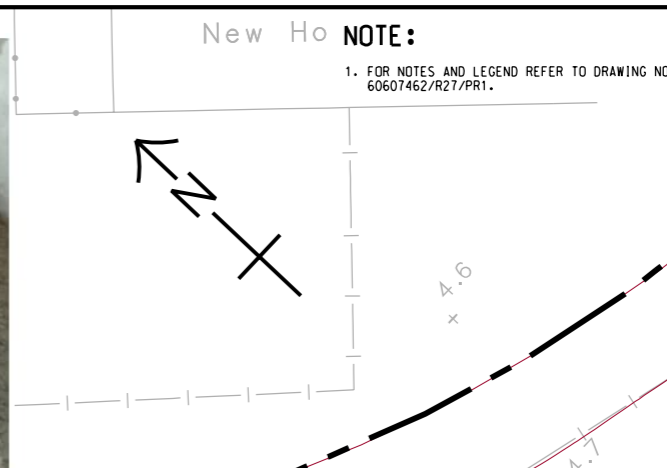

IR	DATE	DESCRIPTION	CHK.

This drawing has been prepared for the use of AECOM's client. It may not be used, modified, reproduced or relied upon by third parties, except as agreed by AECOM or as required by law. AECOM accepts no responsibility, and denies any liability whatsoever, for any part, in any part, that is used or relied upon in this drawing without AECOM's express written consent. Do not scale this document. All measurements must be obtained from the stated dimensions.

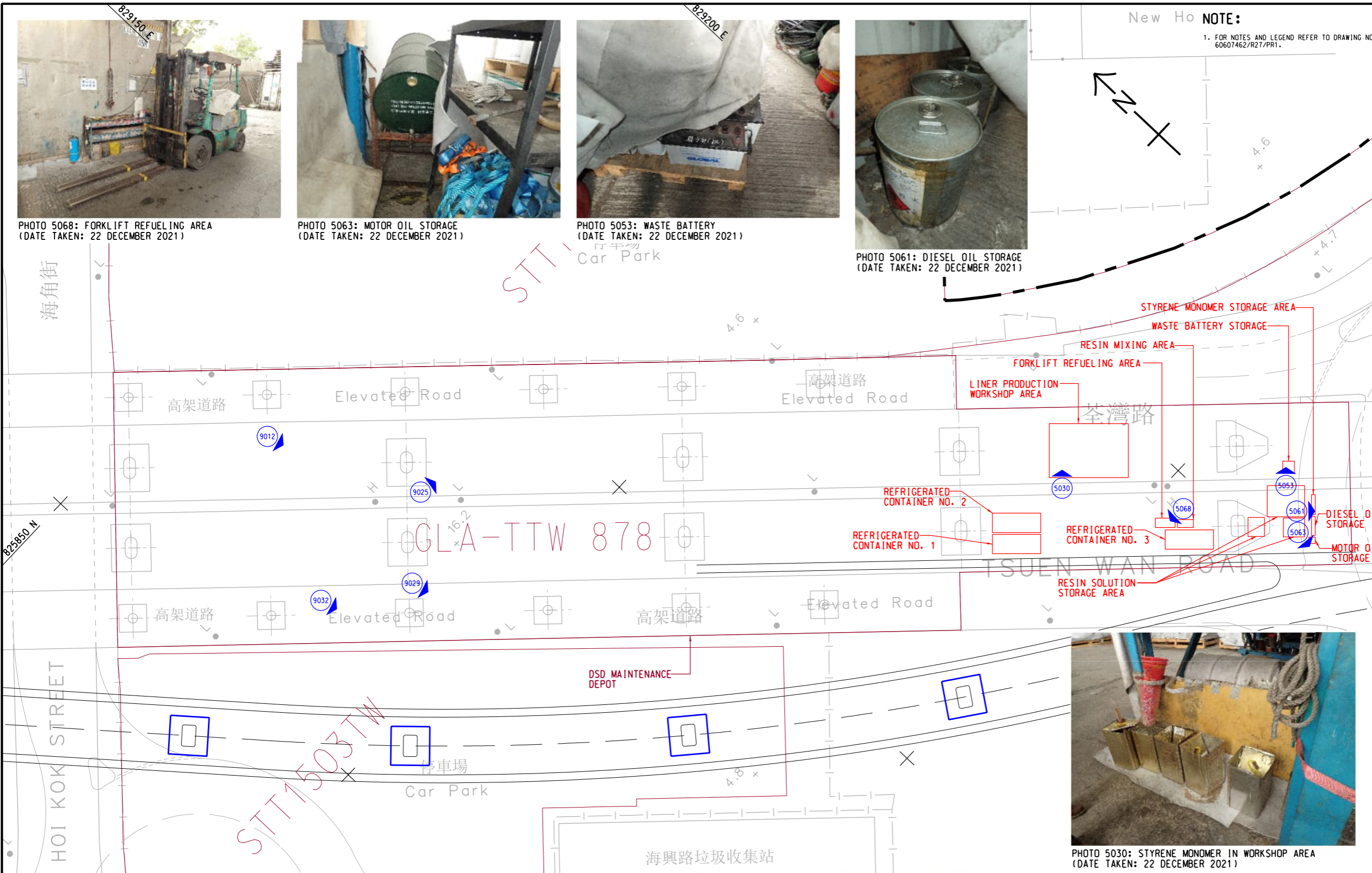

PHOTO 5030: STYRENE MONOMER IN WORKSHOP AREA
(DATE TAKEN: 22 DECEMBER 2021)



PHOTO 9032: ELECTRICITY SUPPLY
(DATE TAKEN: 22 DECEMBER 2021)



PHOTO 9029: MATERIAL STORAGE AREA
(DATE TAKEN: 22 DECEMBER 2021)



PHOTO 9025: MATERIAL STORAGE AREA
(DATE TAKEN: 22 DECEMBER 2021)



PHOTO 9012: PARKING AREA
(DATE TAKEN: 22 DECEMBER 2021)



PHOTO 5001: CONTRACTOR SITE OFFICE
 (DATE TAKEN: 22 DECEMBER 2021)



PHOTO 5016: DSD SITE OFFICE
 (DATE TAKEN: 22 DECEMBER 2021)



PHOTO 9767: MATERIAL STORAGE AREA
 (DATE TAKEN: 22 DECEMBER 2021)



PHOTO 9792: RESIN STORAGE
 (DATE TAKEN: 22 DECEMBER 2021)

New Ho NOTE:

1. FOR NOTES AND LEGEND REFER TO DRAWING NO. 60607462/R27/PR1.

PROJECT

WIDENING OF TSUEN WAN ROAD AND THE ASSOCIATED JUNCTION IMPROVEMENT WORKS

CLIENT



CONSULTANT

AECOM Asia Company Ltd.
 www.aecom.com

SUB-CONSULTANTS

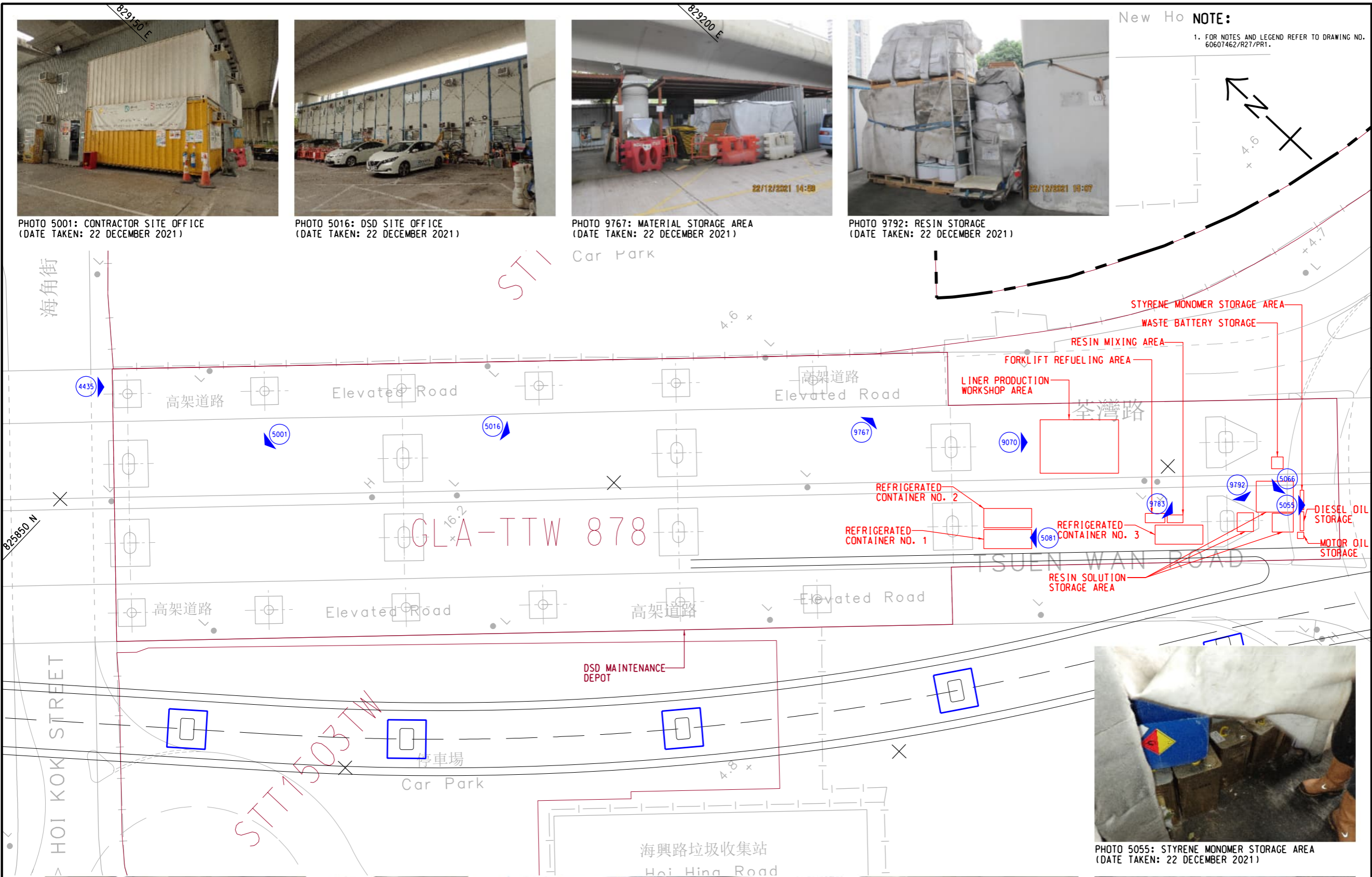

PHOTO 5055: STYRENE MONOMER STORAGE AREA
 (DATE TAKEN: 22 DECEMBER 2021)



PHOTO 4435: HOI KOK STREET AND DSD MAINTENANCE DEPOT
 (DATE TAKEN: 16 NOVEMBER 2021)



PHOTO 5066: RESIN STORAGE
 (DATE TAKEN: 22 DECEMBER 2021)



PHOTO 9783: RESIN MIXING AREA
 (DATE TAKEN: 22 DECEMBER 2021)



PHOTO 9070: LINER PRODUCTION WORKSHOP AREA
 (DATE TAKEN: 22 DECEMBER 2021)



PHOTO 5081: REFRIGERATED CONTAINER
 (DATE TAKEN: 22 DECEMBER 2021)

ISSUE/REVISION

NO.	DATE	DESCRIPTION	CHK.

STATUS

SCALE DIMENSION UNIT

A3 1:500 METRES

KEY PLAN

PROJECT NO. AGREEMENT NO.

60607462 CE61/2018(HY)

SHEET TITLE

PHOTOGRAPHIC RECORDS OF SITE WALKOVER

SHEET NUMBER

60607462/R27/PR13

This drawing has been prepared for the use of AECOM's client. It may not be used, modified, reproduced or relied upon by third parties, except as agreed by AECOM or as required by law. AECOM accepts no responsibility, and denies any liability whatsoever, for any part, that less or more on this drawing without AECOM's express written consent. All measurements must be obtained from the stated dimensions.

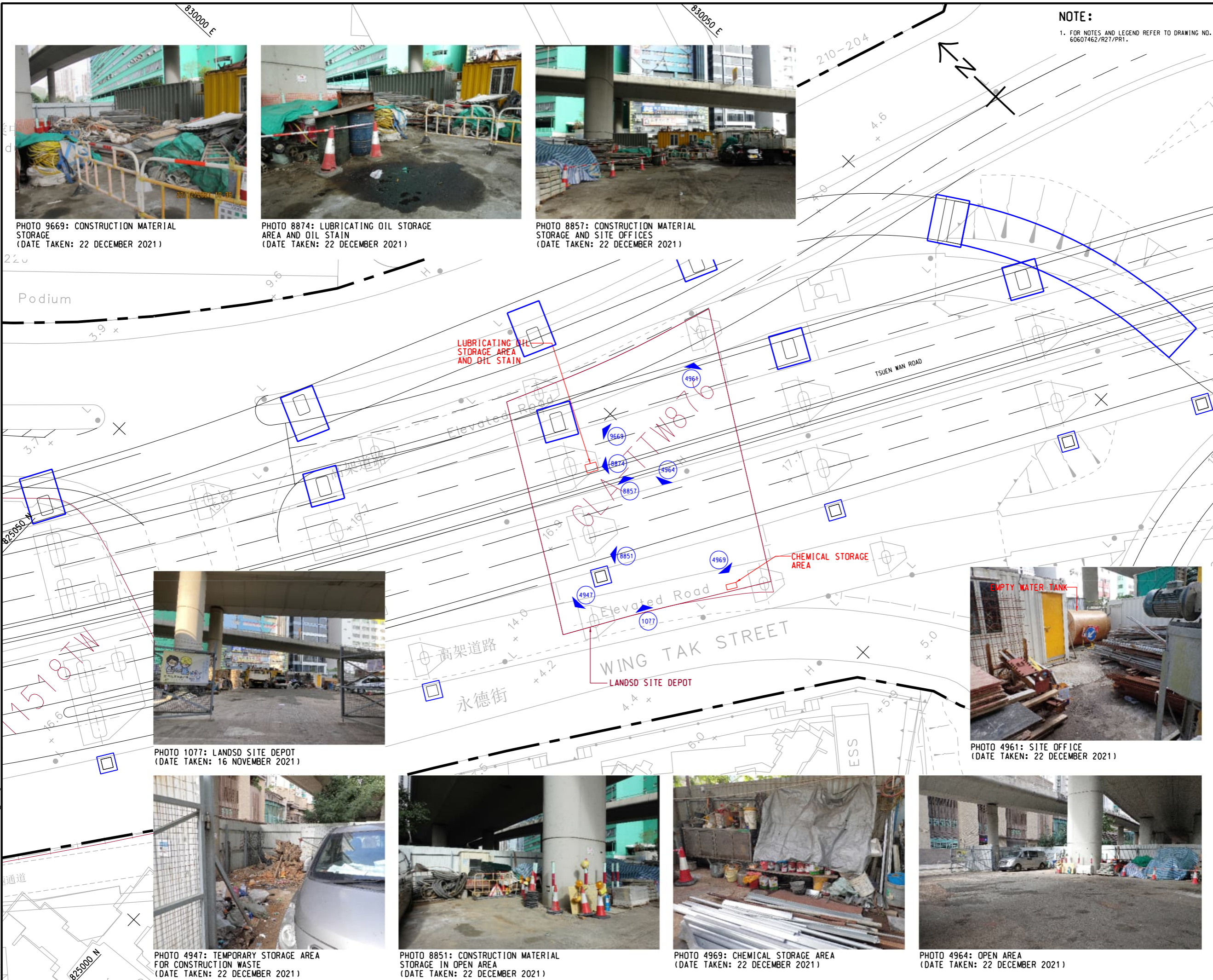

NOTE:
 1. FOR NOTES AND LEGEND REFER TO DRAWING NO. 60607462/R27/PR1.



PROJECT
 項目
 WIDENING OF TSUEN WAN ROAD AND THE ASSOCIATED JUNCTION IMPROVEMENT WORKS

CLIENT
 業主
 路政署
 HIGHWAYS DEPARTMENT

CONSULTANT
 顧問公司
 AECOM Asia Company Ltd.
 www.aecom.com

SUB-CONSULTANTS
 分判工程師/公司

ISSUE/REVISION
 修訂

I/R	DATE	DESCRIPTION	CHK.
修訂	日期	修訂描述	核對

STATUS
 狀態

SCALE
 比例
 A3 1 : 500

DIMENSION UNIT
 尺寸單位
 METRES

KEY PLAN
 索引圖

PROJECT NO.
 項目編號
 60607462

AGREEMENT NO.
 協議編號
 CE61/2018(HY)

SHEET TITLE
 圖紙名稱
 PHOTOGRAPHIC RECORDS OF SITE WALKOVER

SHEET NUMBER
 圖紙編號
 60607462/R27/PR14

This drawing has been prepared for the use of AECOM's client. It may not be used, modified, reproduced or relied upon by third parties, except as agreed by AECOM or as required by law. AECOM accepts no responsibility, and denies any liability whatsoever, to any party, that uses or relies on this drawing without AECOM's express written consent. Do not scale this document. All measurements must be obtained from the stated dimensions.



PHOTO 9669: CONSTRUCTION MATERIAL STORAGE
 (DATE TAKEN: 22 DECEMBER 2021)



PHOTO 8874: LUBRICATING OIL STORAGE AREA AND OIL STAIN
 (DATE TAKEN: 22 DECEMBER 2021)



PHOTO 8857: CONSTRUCTION MATERIAL STORAGE AND SITE OFFICES
 (DATE TAKEN: 22 DECEMBER 2021)



PHOTO 1077: LANDSD SITE DEPOT
 (DATE TAKEN: 16 NOVEMBER 2021)



PHOTO 4961: SITE OFFICE
 (DATE TAKEN: 22 DECEMBER 2021)



PHOTO 4947: TEMPORARY STORAGE AREA FOR CONSTRUCTION WASTE
 (DATE TAKEN: 22 DECEMBER 2021)



PHOTO 8851: CONSTRUCTION MATERIAL STORAGE IN OPEN AREA
 (DATE TAKEN: 22 DECEMBER 2021)



PHOTO 4969: CHEMICAL STORAGE AREA
 (DATE TAKEN: 22 DECEMBER 2021)



PHOTO 4964: OPEN AREA
 (DATE TAKEN: 22 DECEMBER 2021)