

ISO A1 594mm x 841mm
 Approved:
 Checked:
 Designer:
 Project Management Initials:
 Plot File by: ZHANGWRS 2023/01/16
 PATH: P:\PROJECT\60607462\DRAWING\REPORT\R27_136.dgn

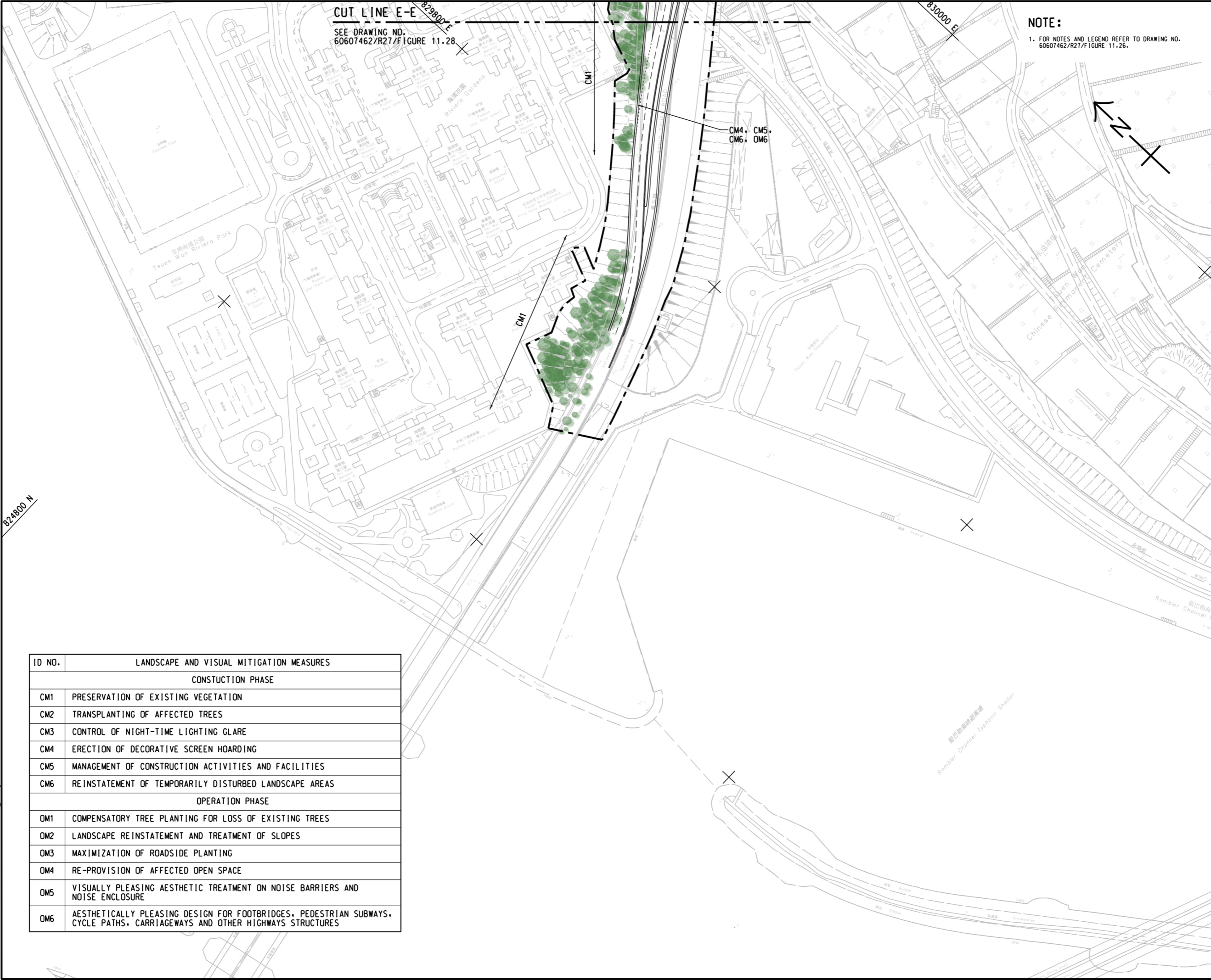

NOTE:
 1. FOR NOTES AND LEGEND REFER TO DRAWING NO. 60607462/R27/F/FIGURE 11.26.



PROJECT
 項目
 WIDENING OF TSUEN WAN ROAD AND THE ASSOCIATED JUNCTION IMPROVEMENT WORKS

CLIENT
 業主
 路政署
 HIGHWAYS DEPARTMENT

CONSULTANT
 工程顧問公司
 AECOM Asia Company Ltd.
 www.aecom.com

SUB-CONSULTANTS
 分判工程顧問公司

ISSUE/REVISION
 修訂

I/R	DATE	DESCRIPTION	CHK.
修訂	日期	內容摘要	核校

STATUS
 階段

SCALE
 比例
 A1 1 : 1000

DIMENSION UNIT
 尺寸單位
 METRES

KEY PLAN
 索引圖

PROJECT NO.
 項目編號
 60607462

AGREEMENT NO.
 協議編號
 CE61/2018(HY)

SHEET TITLE
 圖紙名稱
 LANDSCAPE AND VISUAL MITIGATION PLAN

SHEET NUMBER
 圖紙編號
 60607462/R27/FIGURE 11.29

ID NO.	LANDSCAPE AND VISUAL MITIGATION MEASURES
CONSTRUCTION PHASE	
CM1	PRESERVATION OF EXISTING VEGETATION
CM2	TRANSPLANTING OF AFFECTED TREES
CM3	CONTROL OF NIGHT-TIME LIGHTING CLARE
CM4	ERECTION OF DECORATIVE SCREEN HOARDING
CM5	MANAGEMENT OF CONSTRUCTION ACTIVITIES AND FACILITIES
CM6	REINSTATEMENT OF TEMPORARILY DISTURBED LANDSCAPE AREAS
OPERATION PHASE	
OM1	COMPENSATORY TREE PLANTING FOR LOSS OF EXISTING TREES
OM2	LANDSCAPE REINSTATEMENT AND TREATMENT OF SLOPES
OM3	MAXIMIZATION OF ROADSIDE PLANTING
OM4	RE-PROVISION OF AFFECTED OPEN SPACE
OM5	VISUALLY PLEASING AESTHETIC TREATMENT ON NOISE BARRIERS AND NOISE ENCLOSURE
OM6	AESTHETICALLY PLEASING DESIGN FOR FOOTBRIDGES, PEDESTRIAN SUBWAYS, CYCLE PATHS, CARRIAGEWAYS AND OTHER HIGHWAYS STRUCTURES

This drawing has been prepared for the use of AECOM's client. It may not be used, modified, reproduced or relied upon by third parties, except as agreed by AECOM or as required by law. AECOM accepts no responsibility, and denies any liability whatsoever, to any party that uses or relies on this drawing without AECOM's express written consent. All measurements must be obtained from the stated dimensions.