

- LEGEND**
- PROPOSED ELEVATED / AT-GRADE ROAD OF ROUTE 11
  - PROPOSED RECLAMATION OF ROUTE 11
  - 300M STUDY AREA OF ROUTE 11 (SECTION BETWEEN YUEN LONG AND NORTH LANTAU)
  - MARINE SURVEY AND DIVING INSPECTION AREA UNDER MAI OF "ROUTE 10 – NORTH LANTAU TO TSING LUNG TAU SECTION"
  - DIVING TARGETS UNDER MAI OF "ROUTE 10 – NORTH LANTAU TO TSING LUNG TAU SECTION"

Rev	Description	By	Date
B	SECOND ISSUE		9/23
A	FIRST ISSUE		1/23

Consultant  
**ARUP**

Project title  
Route 11 (Section between Yuen Long and North Lantau)

Drawing title  
STUDY AREA UNDER MAI OF "ROUTE 10 – NORTH LANTAU TO TSING LUNG TAU SECTION"

Drawing no.	APPENDIX 12.4a	Rev.	B
Drawn	Date	Checked	Approved
Scale	Status PRELIMINARY		

COPYRIGHT RESERVED

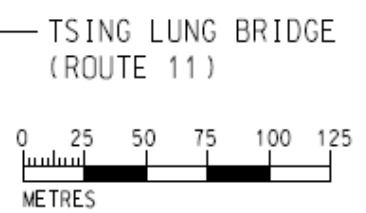

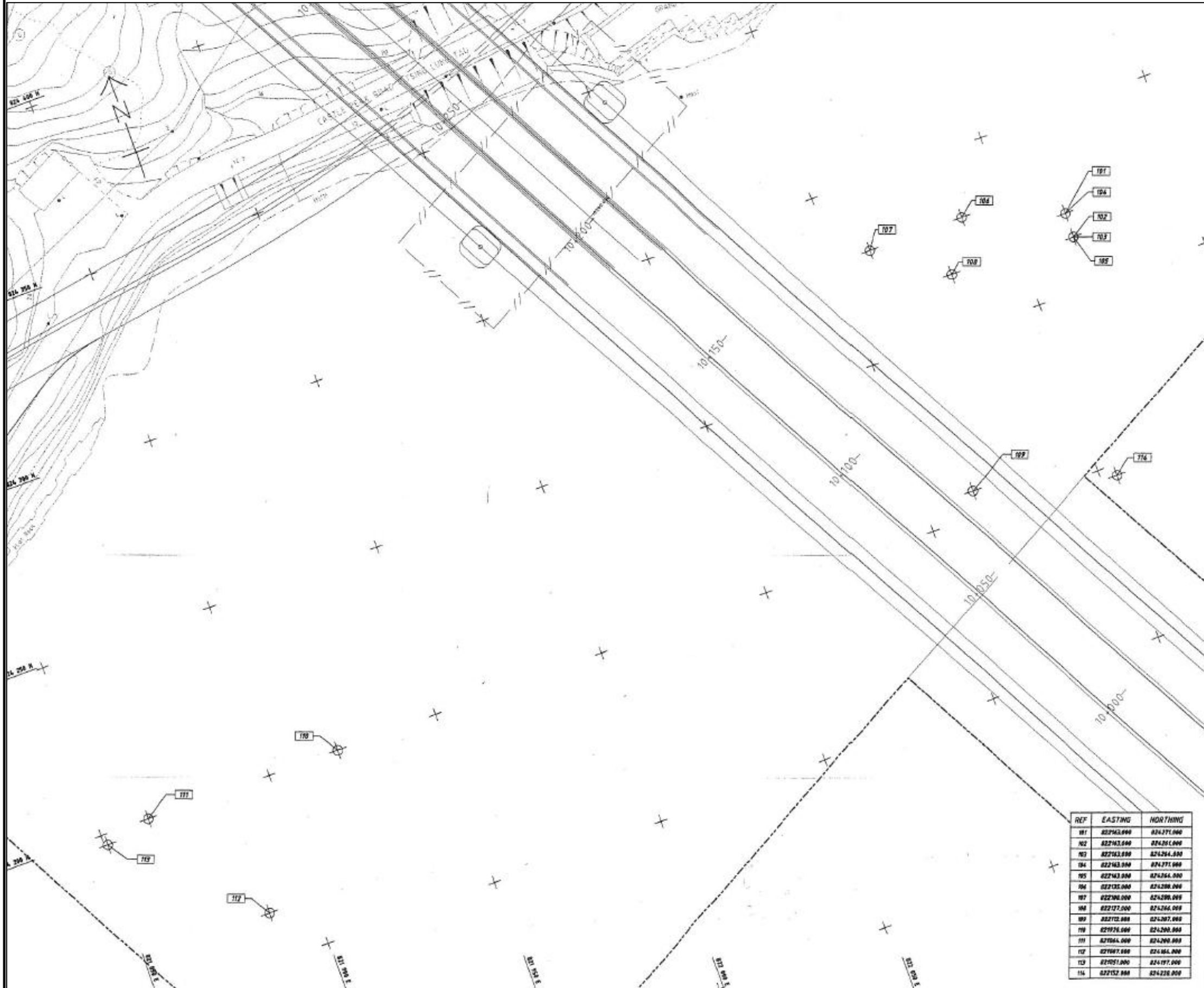

Figure 3: Diving Targets at Tsing Lung Tau

Highways Department 路政署  
 MAJOR WORKS PROJECT MANAGEMENT OFFICE 主要工程管理處

Route 10 - North Lantau to Yuen Long Highway  
 North Lantau to Tsing Lung Tau Section

TSING LUNG TAU  
 SIDE SCAN SONAR TARGETS

MAUNSELL CONSULTANTS ASIA LTD.  
 茂盛/亞細亞工程顧問有限公司

PROJECT NO. 90900/SK231

DATE OF WORK 27/99

Scale: 1:500

COPYRIGHT RESERVED

Rev	Description	By	Date
A	FIRST ISSUE		1/23

Consultant  
**ARUP**

Project title  
 Route 11 (Section between Yuen Long and North Lantau)

Drawing title  
 DIVING TARGETS AT TSING LUNG TAU UNDER MAI OF "ROUTE 10 - NORTH LANTAU TO TSING LUNG TAU SECTION"

Drawing no.	APPENDIX 12.4b	Rev.	A
Drawn	Date	Checked	Approved
Scale	Status	PRELIMINARY	

COPYRIGHT RESERVED  
 路政署  
 HIGHWAYS DEPARTMENT