

DO NOT SCALE DRAWING. CHECK ALL DIMENSIONS ON SITE.  
 ALL RIGHTS RESERVED.  
 © OVE ARUP & PARTNERS HONG KONG LIMITED.

IA Report\Figure 3.8d - Contours 24hr RSP (Year 2033) in North Lantau.dgn

22/8/2023

Printed by : richard-kh.lau  
 Filename :

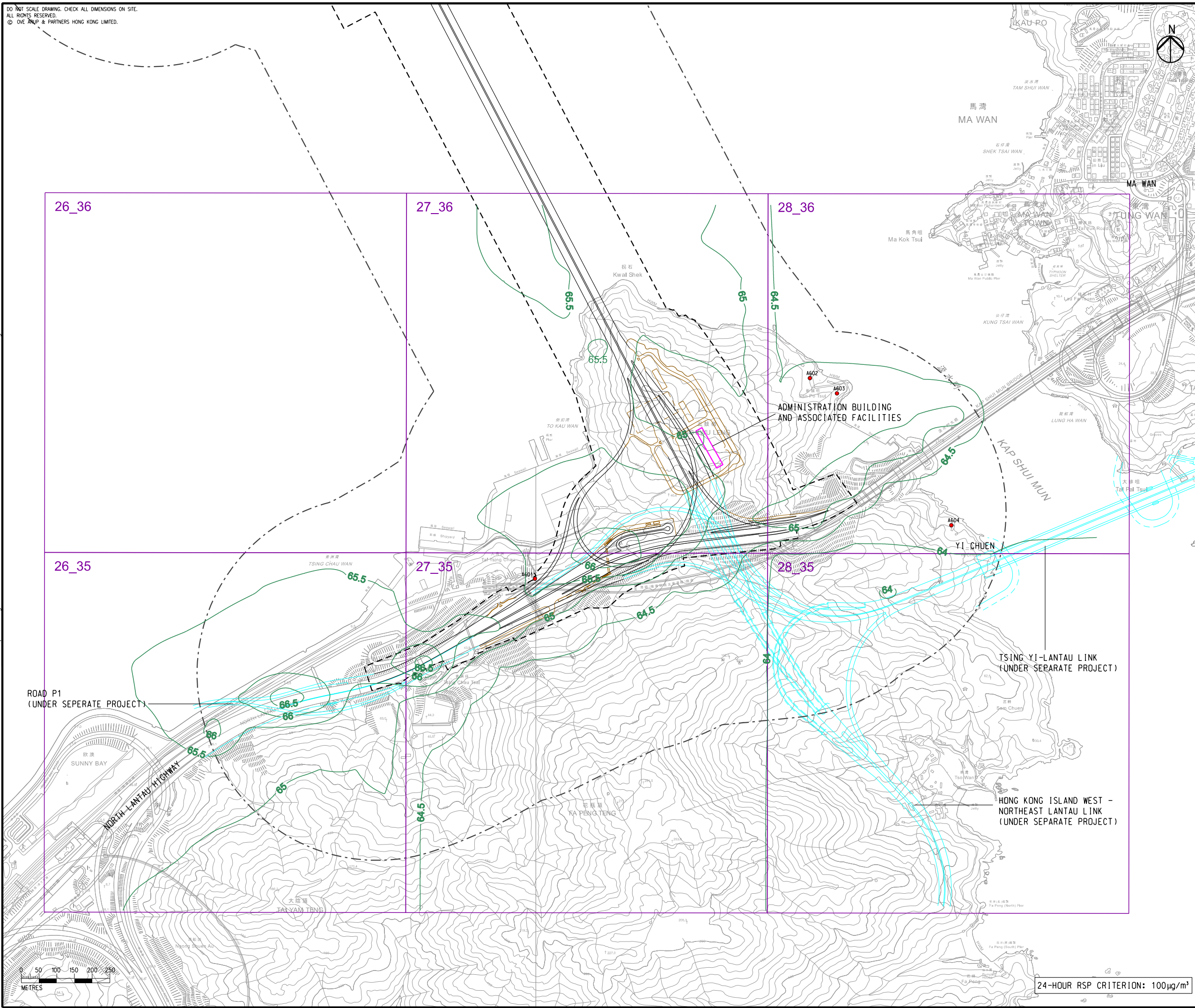

- LEGEND**
- PROPOSED ELEVATED/ AT-GRADE ROAD
  - PROPOSED TUNNEL
  - HIGHWAY/ TUNNEL OPERATION AND MAINTENANCE FACILITIES
  - PROJECT ELEMENT
  - SITE BOUNDARY
  - 500m OPERATIONAL ASSESSMENT AREA
  - PLANNED ROAD NETWORK (UNDER SEPARATE PROJECTS)
  - 27\_36 CONCERNED PATH GRID
  - EXISTING REPRESENTATIVE AIR SENSITIVE RECEIVERS
  - 100— RSP CONTOUR,  $\mu\text{g}/\text{m}^3$

B	SECOND ISSUE	GL	08/23
A	FIRST ISSUE	GL	06/23
Rev	Description	By	Date

Consultant  
ARUP

Project Title  
**ROUTE 11**  
 (SECTION BETWEEN YUEN LONG AND NORTH LANTAU) - INVESTIGATION

Drawing title  
**CONTOURS OF CUMULATIVE 10th HIGHEST 24-HOUR RSP CONCENTRATION AT 1.5m ABOVE GROUND (YEAR 2033) IN NORTH LANTAU**

Drawing no. <b>FIGURE 3.8d</b>		Rev. <b>B</b>	
Drawn GL	Date 08/23	Checked TL	Approved FC
Scale 1:10000 @ A3		Status PRELIMINARY	

COPYRIGHT RESERVED

路政署  
HIGHWAYS  
DEPARTMENT

24-HOUR RSP CRITERION:  $100 \mu\text{g}/\text{m}^3$