

Appendix 12.4 Indicative Location of Potential Off-Site Tree Compensation in TSH Temporary Magazine Site

TREE COMPENSATION FOR NOL (FOR REFERENCE ONLY*)

LOCATIONS	MITIGATION MEASURES	APPROXIMATE NOS. OF TREE COMPENSATED	TENTATIVE PROPOSED TREE SIZE	MAINTENANCE / MANAGEMENT AGENCY (SUBJECT TO AGREEMENT)
MAGAZINE SITE AT TAI SHU HA	CM1, OM4	~ 450	LIGHT STANDARD TREES	MTR TAKE UP THE MAINTENANCE UNTIL HANDOVER TO GOVERNMENTS

NOTE: *THE MANAGEMENT / MAINTENANCE RESPONSIBILITY, IN GENERAL, FOLLOWS LAO PRACTICE NOTE NO. 6/2023 AND IS SUBJECT TO AGREEMENT. THE TREE NUMBERS ARE INDICATIVE ONLY AND THE EXACT NUMBERS ARE SUBJECT TO THE APPROVAL OF TPRP.

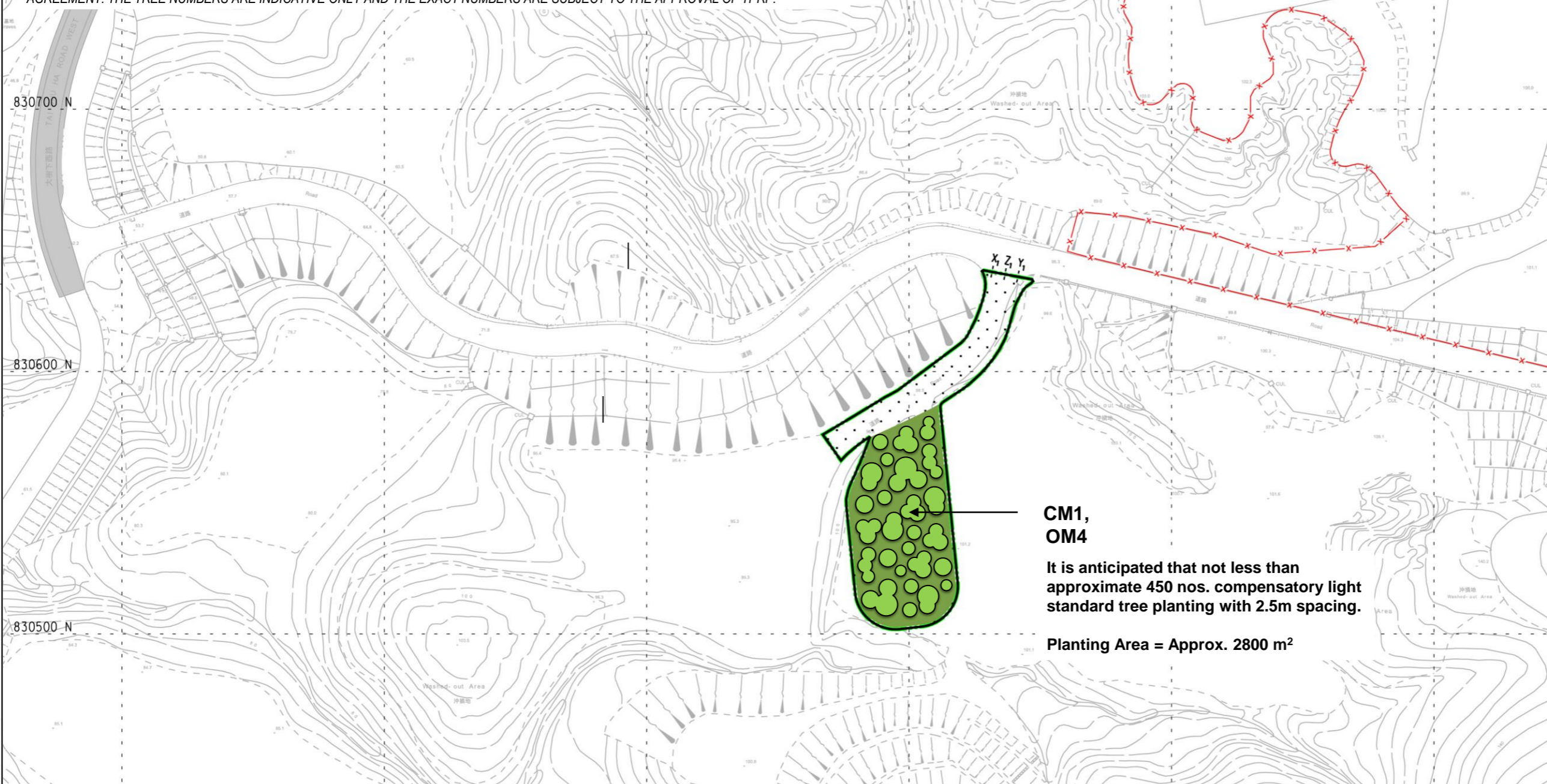

CM1, OM4

It is anticipated that not less than approximate 450 nos. compensatory light standard tree planting with 2.5m spacing.

Planting Area = Approx. 2800 m²

LEGEND:

- BOUNDARY OF THE WORKS AREA FOR TEMPORARY EXPLOSIVE MAGAZINE SITE
- COMPENSATORY TREE PLANTING (OM4)

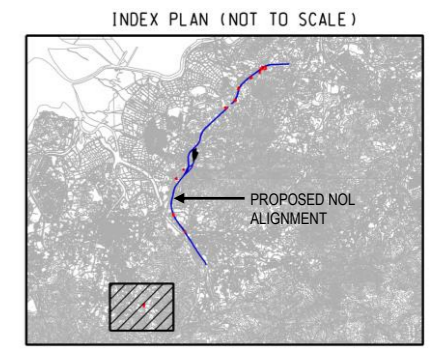

Remarks :

- Landscaping features and forms of structures shown in the drawing are indicative only.

REV	DESCRIPTION	BY	DATE	APPROVED	REV	DESCRIPTION	BY	DATE	APPROVED

DRAWN	
DESIGNED	
CHECKED	
APPROVED	
DATE	

MTR

NORTHERN LINK

ORIGINATOR

ARUP AECOM JV

In Association with Hassell Limited

CADD REF.

TITLE	CONTRACT 1602 PRELIMINARY DESIGN FOR NORTHERN LINK PHASE 2 TAI SHU HA MAGAZINE SITE (TSH) LANDSCAPE PLAN		
SCALE	DRAWING NO.	C1602/S/TSH/AE/A58/901	REV.