





DEEP BAY  
后海灣

NIM WAN  
稔灣

BLACK POINT  
爛角咀

KEY PLAN 主圖  
A3: 1:50,000

LEGEND 圖例

-  I-PARK2 發展綜合廢物管理設施第二期
-  PROPOSED SEAWALL MODIFICATION / BERTHING FACILITY  
擬議海堤改造 / 停泊設施
-  PROJECT BOUNDARY 項目範圍
-  LOCATION OF PROPOSED OUTFALL 擬議排水口位置

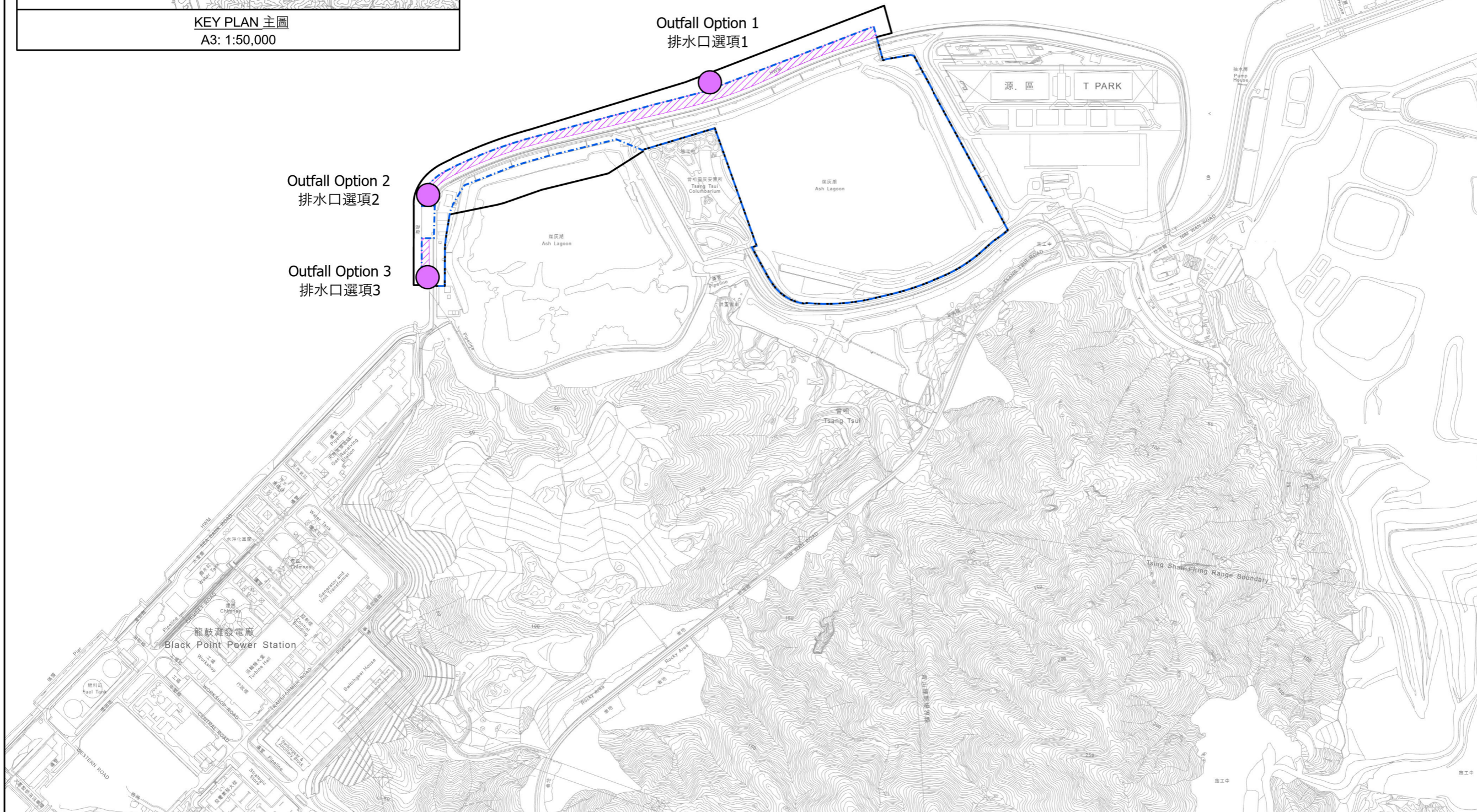

Revision 修訂	Description 描述			
	Designed 設計	Reviewed 審核	Drawn 草繪	Checked 檢查
Initial 草繪	PSY	Amy	PSY	Amy
Date 日期	08/24	08/24	08/24	08/24

Approved 批核

Agreement No. 合約編號  
**CE 26/2022 (EP)**

Project Title 工程項目名稱  
**Development of Integrated Waste Management Facilities Phase 2 - Investigation, Design and Construction**  
發展綜合廢物管理設施第二期 - 勘察、設計及建造

Figure Title 附圖名稱

**Project Location Plan**  
工程項目位置圖

Drawing No. 草圖編號 Figure 圖 1.1	Revision 修訂 -
----------------------------------	------------------

Scale 比例  
A3: 1:8,000

Client 業主  
 **Environmental Protection Department**  
The Government of the Hong Kong  
Special Administrative Region

Consultant 顧問  
  
BINNIES HONG KONG LIMITED  
賓尼士工程顧問有限公司