

Appendix 5.10e

Sediment Quality Results for Nutrients and Sediment Oxygen Demand at TKO 137

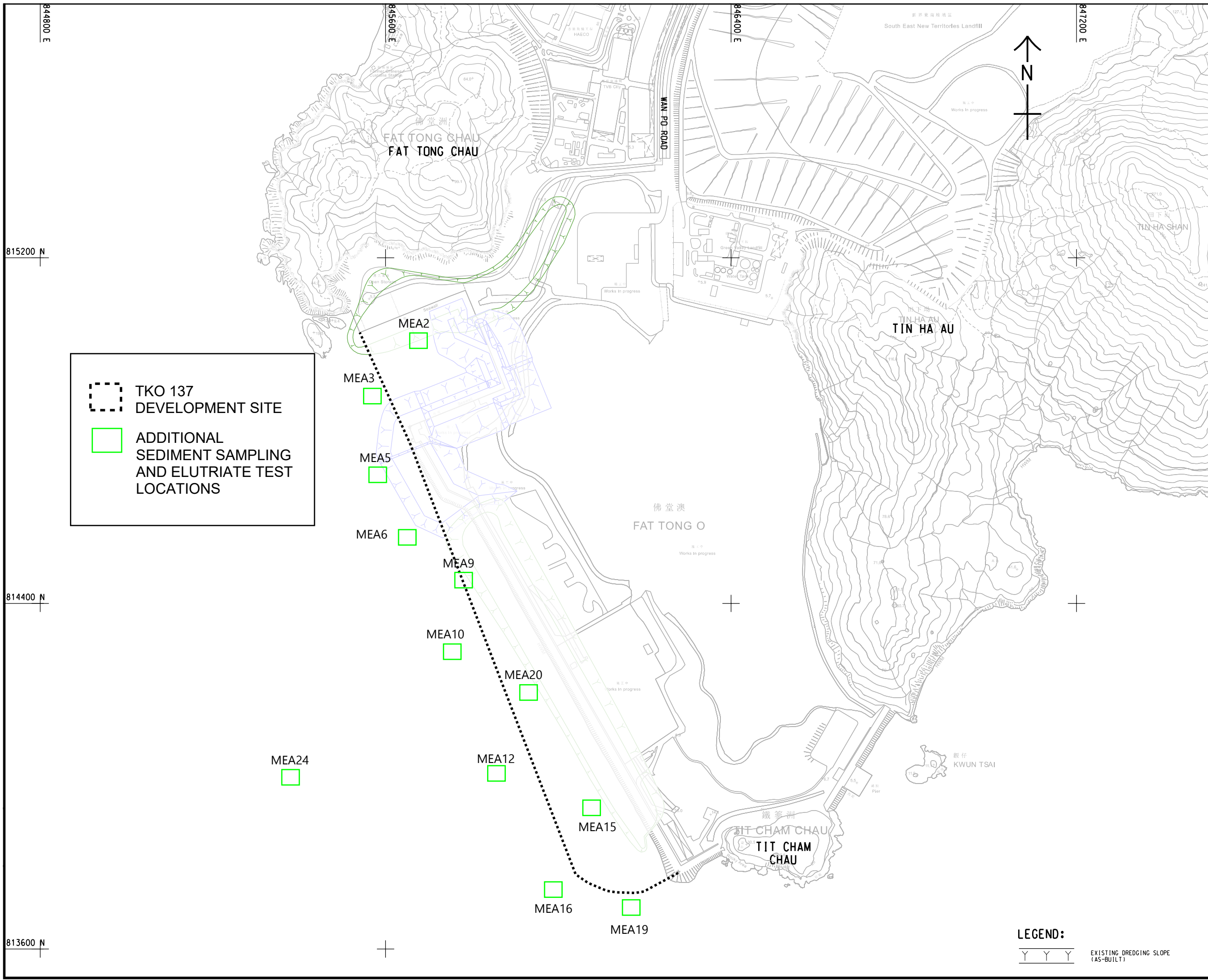

TKO 137 DEVELOPMENT SITE
 ADDITIONAL SEDIMENT SAMPLING AND ELUTRIATE TEST LOCATIONS

LEGEND:
 EXISTING DREDGING SLOPE (AS-BUILT)

Sediment Sampling Results for Nutrients and Sediment Oxygen Demand at TKO 137

Station ID	Sampling Depth	NH ₃ -N (mg/kg)	PO ₄ (mg/kg)	TKN (mg/kg)	TP (mg/kg)	NO ₃ -N (mg/kg)	NO ₂ -N (mg/kg)	SOD (mg/kg)
Sediment Sampling and Testing of this EIA								
MEA2	Surface	<10	<10.0	890	374	<0.1	<0.1	1720
	0.20-0.90m	15	<10.0	520	308	<0.1	<0.1	680
	0.90-1.90m	24	<10.0	700	420	<0.1	<0.1	700
	1.90-2.90m	11	<10.0	620	340	<0.1	<0.1	640
	2.90-5.90m	<10	<10.0	770	385	<0.1	<0.1	820
MEA3	Surface	<10	<10.0	740	362	<0.1	<0.1	850
	0.40-0.90m	<10	<10.0	490	311	<0.1	<0.1	750
	0.90-1.90m	<10	<10.0	420	225	<0.1	<0.1	810
	1.90-2.90m	12	<10.0	750	382	<0.1	<0.1	800
	2.90-5.90m	<10	<10.0	840	624	<0.1	<0.1	940
MEA5	Surface	<10	<10.0	940	363	<0.1	<0.1	900
	0.60-0.90m	<10	<10.0	680	299	<0.1	<0.1	660
	0.90-1.90m	<10	<10.0	500	340	<0.1	<0.1	480
	1.90-2.90m	<10	<10.0	180	84	<0.1	<0.1	450
	2.90-5.90m	23	<10.0	790	408	<0.1	<0.1	400
MEA6	Surface	<10	<10.0	600	290	<1.0	<0.1	490
	0.98-1.90m	19	<10.0	770	338	<1.0	<0.1	440
	1.90-2.90m	<10	<10.0	70	81	<1.0	<0.1	160
	2.90-5.90m	<10	<10.0	700	410	<1.0	<0.1	730
MEA9	Surface	<10	<10.0	1320	475	<0.1	<0.1	2470
	0.15-0.90m	<10	<10.0	100	71	<0.1	<0.1	370
	0.90-1.90m	<10	<10.0	500	336	<0.1	<0.1	640
	1.90-2.90m	<10	<10.0	630	498	<0.1	<0.1	760
	2.90-5.90m	<10	<10.0	640	377	<0.1	<0.1	1140
MEA10	Surface	21	<10.0	1730	592	<0.1	<0.1	1530
	0.20-0.90m	22	<10.0	630	367	<0.1	<0.1	550
	0.90-1.90m	<10	<10.0	590	327	<0.1	<0.1	540
	1.90-2.90m	<10	<10.0	770	381	<0.1	<0.1	910
	2.90-5.90m	<10	<10.0	590	297	<0.1	<0.1	550
MEA12	Surface	<10	<10.0	1400	525	<0.1	<0.1	1060
	0.15-0.90m	21	<10.0	680	429	<0.1	<0.1	540
	0.90-1.90m	<10	<10.0	660	338	<0.1	<0.1	820
	1.90-2.90m	<10	<10.0	670	312	<0.1	<0.1	930
	2.90-4.90m	<10	<10.0	390	79	<0.1	<0.1	390
MEA15	Surface	13	<10.0	1330	525	<0.1	<0.1	1710
	0.35-0.90m	<10	<10.0	320	263	<0.1	<0.1	1790
	0.90-1.90m	44	<10.0	960	428	<0.1	<0.1	1370
	1.90-2.90m	<10	<10.0	460	544	<0.1	<0.1	510
	2.90-5.90m	<10	<10.0	770	346	<0.1	<0.1	1220
MEA16	Surface	<10	<10.0	1020	535	<0.1	<0.1	900
	0.20-0.90m	<10	<10.0	900	453	<0.1	<0.1	780
	0.90-1.90m	<10	<10.0	650	296	<0.1	<0.1	940
	1.90-2.90m	<10	<10.0	710	332	<0.1	<0.1	1030
	2.90-5.90m	<10	<10.0	680	292	<0.1	<0.1	960
MEA19	Surface	<10	<10.0	1080	505	<0.1	<0.1	1110
	0.00-0.90m	<10	<10.0	480	795	<0.1	<0.1	520
	0.90-1.90m	<10	<10.0	370	328	<0.1	<0.1	480
	1.90-2.90m	<10	<10.0	420	291	<0.1	<0.1	540
	2.90-3.66m	<10	<10.0	350	293	<0.1	<0.1	460
MEA20	Surface	<10	<10.0	1400	562	<0.1	<0.1	1430
	0.30-0.90m	<10	<10.0	310	191	<0.1	<0.1	360
	0.90-1.90m	<10	<10.0	220	172	<0.1	<0.1	280
	1.90-2.90m	14	<10.0	970	476	<0.1	<0.1	1800
	2.90-5.90m	<10	<10.0	650	439	<0.1	<0.1	940
	6.00-8.90m	<10	<10.0	640	272	<0.1	<0.1	2260
	8.90-9.90m	<10	<10.0	410	83	<0.1	<0.1	190
MEA24	Surface	<10	<10.0	730	321	<0.1	<0.1	500
Sediment Quality Data Collected at EPD's Closest Monitoring Stations in 2023, See Note 1								
ES1 (Chai Wan)	Surface	5.49 (0.25 - 9.30)	-	520 (360 - 730)	210 (180 - 250)	-	-	-
ES2 (Tathong Channel)	Surface	9.31 (1.80 - 29.00)	-	460 (340 - 640)	190 (140-230)	-	-	-
ES4 (Tathong Channel)	Surface	5.18 (1.00 - 13.00)	-	490 (380 - 620)	210 (190-240)	-	-	-

Notes:

- | | | | |
|--------------------|------------------------------|--------------------|-----------------------------------------|
| NH ₃ -N | - Ammonia Nitrogen | NO ₃ -N | - Nitrate Nitrogen |
| PO ₄ -P | - Ortho-phosphate Phosphorus | NO ₂ -N | - Nitrite Nitrogen |
| TKN | - Total Kjeldahl Nitrogen | SOD | - Sediment Oxygen Demand (SOD), 20 days |
| TP | - Total Phosphorus | | |

1. Source: Marine Water Quality in Hong Kong 2023; Data presented are arithmetic means; data in brackets indicate ranges.