

ISO A1 594mm x 841mm  
 Approved:  
 Checked:  
 Designer:  
 Project Management Initials:  
 V:\BAK\US55-BAK\Workspace\System\p1ctg\CSWP-PDF\_COLOR\_HS.plt.ctb  
 Plot File by: haquun.zhao  
 PATH: P:\PROJECTS\60720423\DRAWING\REPORT\B30\B30\_846.dgn

- LEGEND:**
- PROJECT BOUNDARY
  - 300m ASSESSMENT AREA
- PREVIOUS MARINE ARCHAEOLOGICAL WORKS:**
- 2006 MARINE ARCHAEOLOGY GEOPHYSICAL SURVEY AREA (UNDER HONG KONG OFFSHORE WIND FARM EIA)
  - LOCATIONS OF TARGET WITH MARINE ARCHAEOLOGICAL POTENTIAL (UNDER HONG KONG OFFSHORE WIND FARM IN SOUTHEASTERN WATERS EIA)

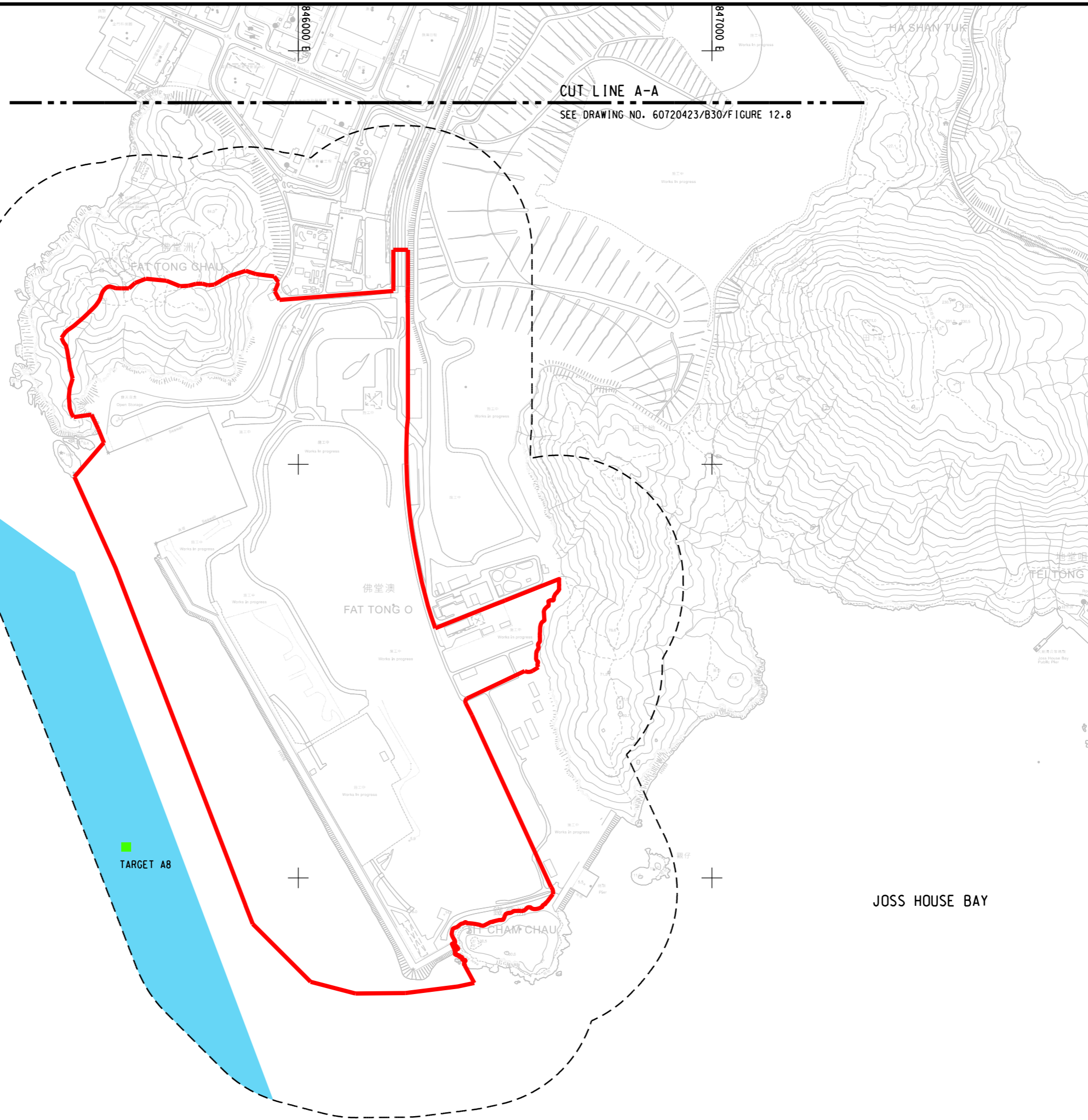

**CUT LINE A-A**  
SEE DRAWING NO. 60720423/B30/FIGURE 12.8

815000 N

814000 N

846000 E

847000 E



**PROJECT**  
DEVELOPMENT OF TSEUNG KWAN O AREA 137 AND ASSOCIATED RECLAMATION SITES – INVESTIGATION, DESIGN AND CONSTRUCTION

**CLIENT**  
 土木工程拓展署  
 Civil Engineering and Development Department

**CONSULTANT**  
 AECOM Binnies (TKO137) JV

**SUB-CONSULTANTS**  
 分列工程師公司

**ISSUE/REVISION**

I/R	DATE	DESCRIPTION	CHK.

**STATUS**  
 有效

**SCALE**      **DIMENSION UNIT**  
 A1 1 : 5000      METRES

**KEY PLAN**    A1 1 : 120000

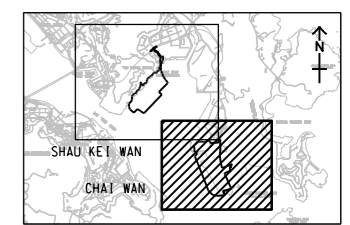

**PROJECT NO.**      **CONTRACT NO.**  
 60720423      CE 40/2023(CE)

**SHEET TITLE**  
 MARINE ARCHAEOLOGY BACKGROUND OF THE ASSESSMENT AREA (TKO 137)

**SHEET NUMBER**  
 60720423/B30/FIGURE 12.7

This drawing has been prepared for the use of AECOM Binnies (TKO137) JV's client. It may not be used, modified, reproduced or relied upon by third parties, except as approved by AECOM Binnies (TKO137) JV or as implied by law. AECOM Binnies (TKO137) JV accepts no responsibility, and denies any liability, whatsoever, to any party, for uses or relies on this drawing without AECOM Binnies (TKO137) JV's express written consent. Do not scale this document. All measurements must be obtained from the stated dimensions.